

DATE	
BY	
PLAN	
NO.	
NO.	
NO.	
NO.	
NO.	
NO.	

DATE	
BY	
PROFILE	
NO.	
NO.	
NO.	
NO.	
NO.	
NO.	

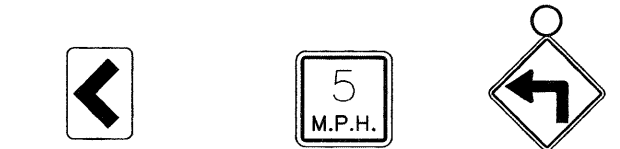
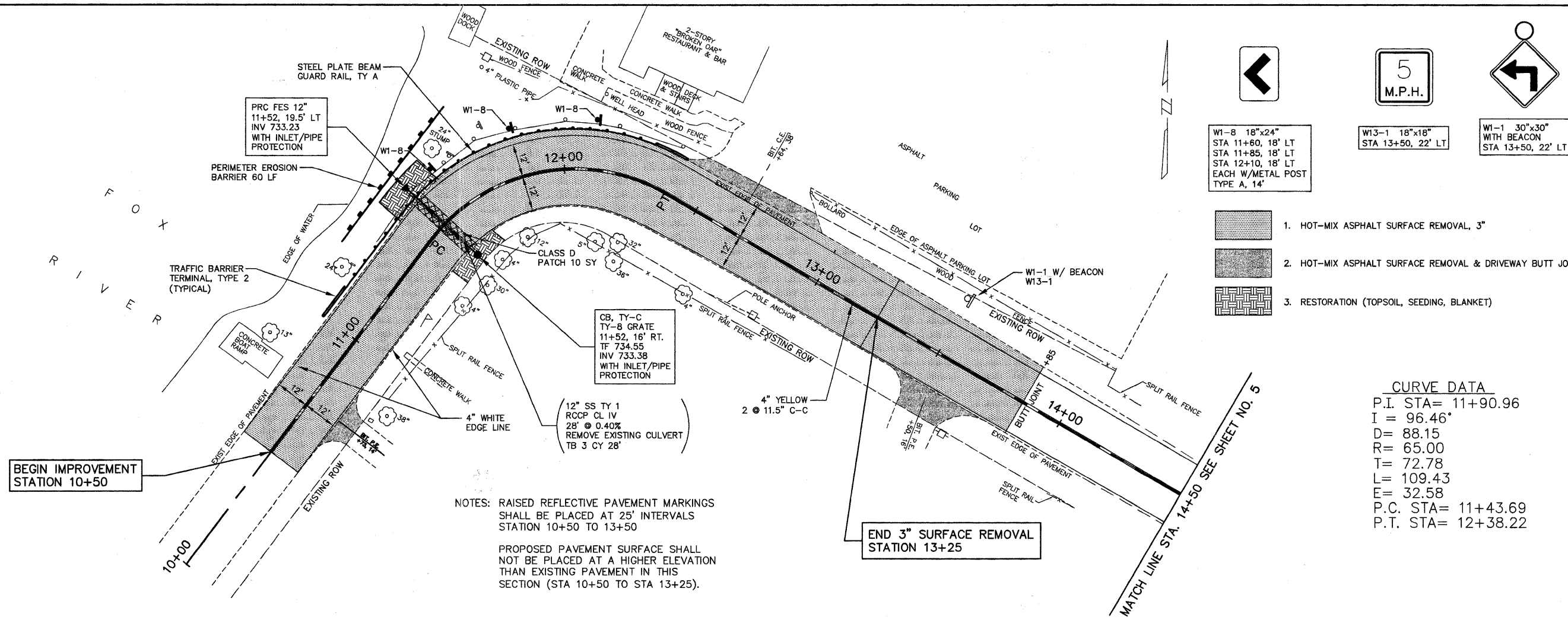

W1-8 18"x24"  
STA 11+60, 18' LT  
STA 11+85, 18' LT  
STA 12+10, 18' LT  
EACH W/METAL POST  
TYPE A, 14'

W13-1 18"x18"  
STA 13+50, 22' LT

W1-1 30"x30"  
WITH BEACON  
STA 13+50, 22' LT

- HOT-MIX ASPHALT SURFACE REMOVAL, 3"
- HOT-MIX ASPHALT SURFACE REMOVAL & DRIVEWAY BUTT JOINT
- RESTORATION (TOPSOIL, SEEDING, BLANKET)

**CURVE DATA**  
 P.I. STA= 11+90.96  
 I = 96.46°  
 D= 88.15  
 R= 65.00  
 T= 72.78  
 L= 109.43  
 E= 32.58  
 P.C. STA= 11+43.69  
 P.T. STA= 12+38.22

NOTES: RAISED REFLECTIVE PAVEMENT MARKINGS SHALL BE PLACED AT 25' INTERVALS STATION 10+50 TO 13+50

PROPOSED PAVEMENT SURFACE SHALL NOT BE PLACED AT A HIGHER ELEVATION THAN EXISTING PAVEMENT IN THIS SECTION (STA 10+50 TO STA 13+25).

END 3" SURFACE REMOVAL STATION 13+25

BEGIN IMPROVEMENT STATION 10+50

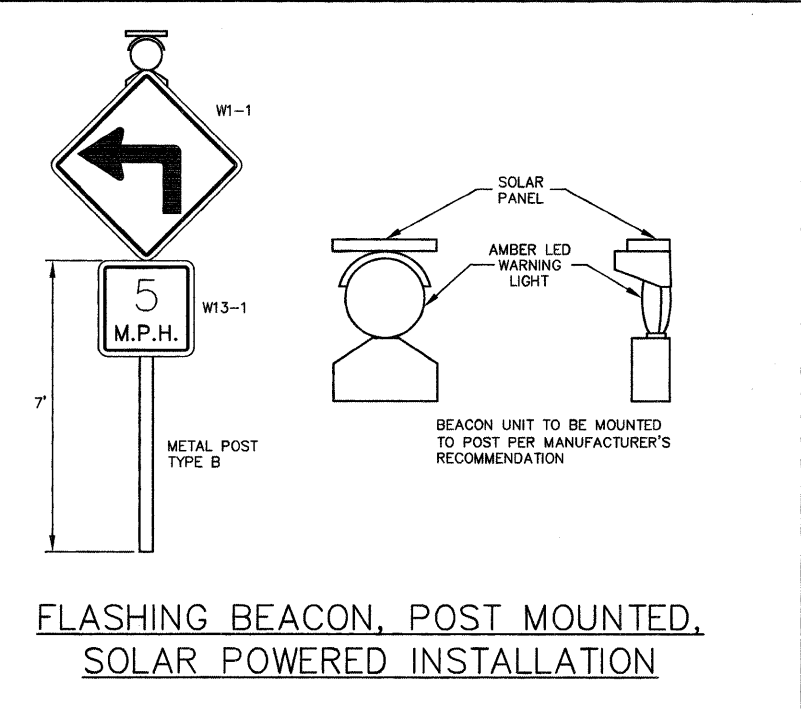

FLASHING BEACON, POST MOUNTED, SOLAR POWERED INSTALLATION