

GRADING PLAN

NOTES:
 1. 10 L.F. OF CURB SHALL BE DEPRESSED AS SHOWN ON THE PLANS TO MAINTAIN THE EX. OVERLAND FLOW ROUTE. THE ELEVATION OF DEPRESSED CURB SHALL NOT EXCEED 635.02

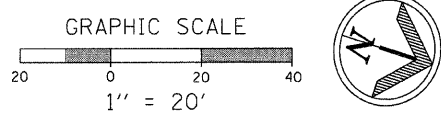

UTILITY PLAN

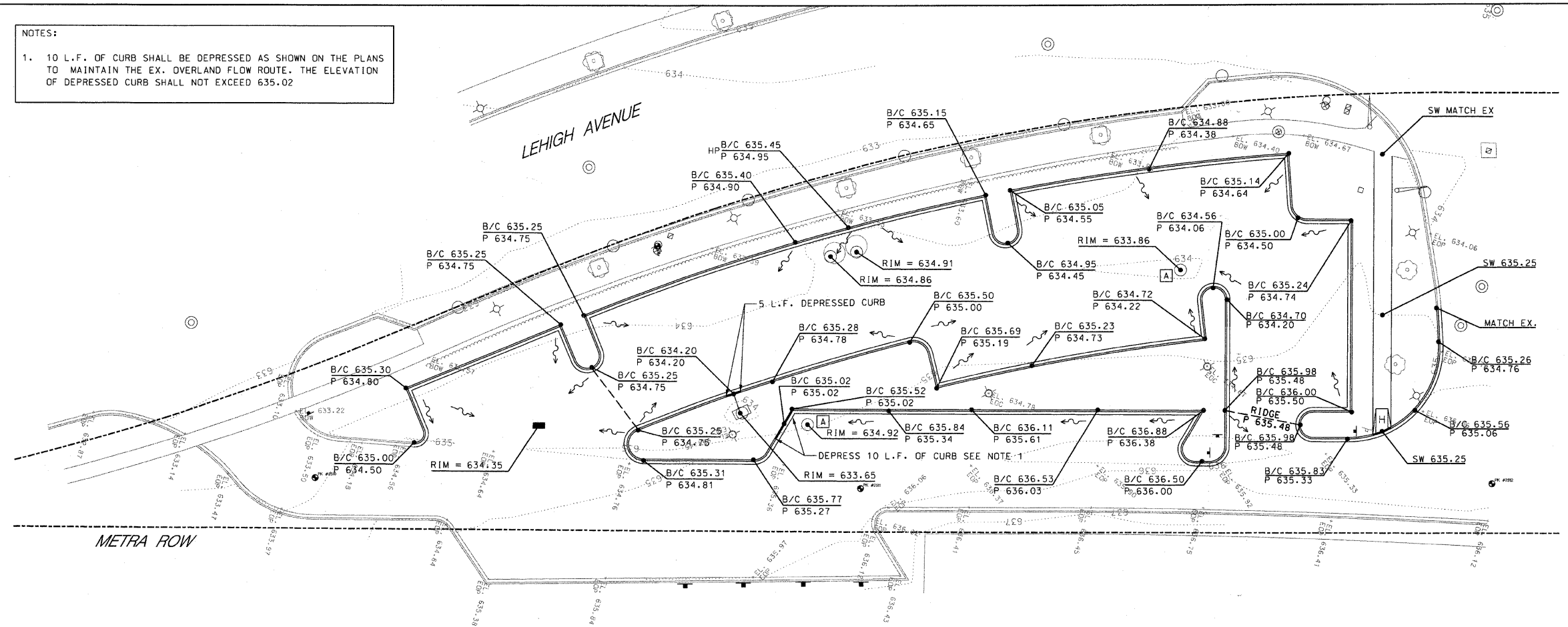
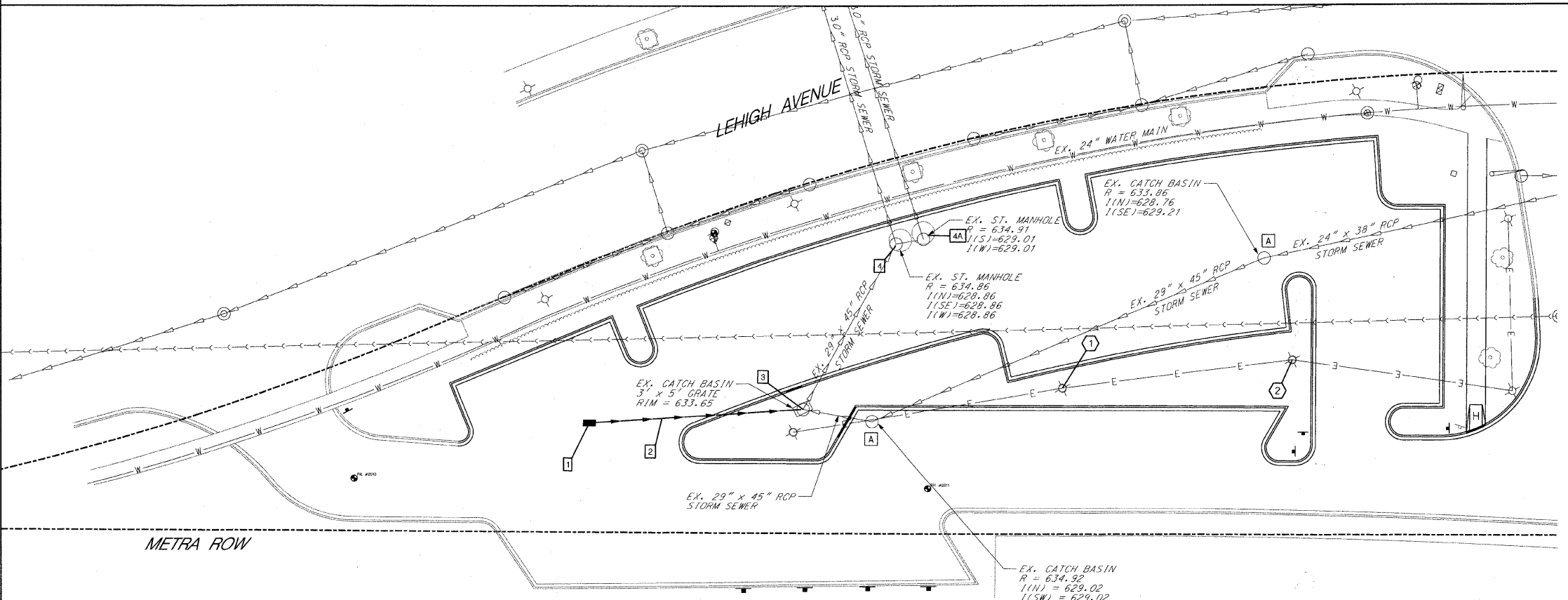

- SCHEDULE OF STORM SEWER IMPROVEMENTS**
- 24" TYPE A INLET, WITH NEENAH R-1713 FRAME AND TYPE G GRATE
 R = 634.35 I(N) = 631.35
 - 68 L.F. - 12" DIP. CLASS 52 STORM SEWER @ 1.00%
 - MACHINE CORE EXISTING MANHOLE I(S) = 630.67
 SEE PIPE CONNECTION TO STRUCTURE DETAIL ON SHEET 20
 - REMOVE EX. CLOSED LID AND REPLACE WITH NEENAH R-1713 FRAME AND TYPE G GRATE RIM ELEVATION TO REMAIN AS IS
 - 4A. REMOVE EX. CLOSED LID AND REPLACE WITH NEENAH R-1713 FRAME AND TYPE G GRATE RIM ELEVATION TO REMAIN AS IS
- NOTES**
- ALL STORM STRUCTURES WITH PIPE ELEVATIONS OF 630.00 OR LOWER MUST HAVE BOOTED CONNECTIONS SEE PIPE CONNECTION TO STRUCTURE DETAIL ON SHEET 20
- SCHEDULE OF LIGHTING IMPROVEMENTS**
- REMOVE EX. LIGHT POLE AND RAISE EXISTING FOUNDATION 1.5' TO EL. 636.28 EXTEND SLEEVE AND ELECTRICAL WIRES AND REINSTALL EXISTING LIGHT POLE SEE DETAIL SHEET 21
 - REMOVE EX. LIGHT POLE AND RAISE EXISTING FOUNDATION 1.5' TO EL. 636.17 EXTEND SLEEVE AND ELECTRICAL WIRES AND REINSTALL EXISTING LIGHT POLE

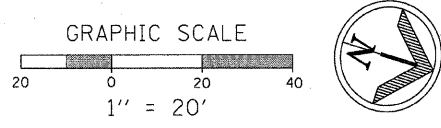

PLANS PREPARED BY: SURVEY - DJG UTILITIES - JC CHECKED - DJG DATE - 04-23-09	DESIGNED - DJG	REVISED - 10/05/09 PER BLRS
	DRAWN - DJG	REVISED -
	CHECKED - LVA	REVISED -
	DATE - 09-17-09	REVISED -
		REVISED -

**VILLAGE OF GLENVIEW
 PROJECT E 08-56**

**SITE GRADING PLAN AND SITE UTILITY PLAN
 WEST LOT SOUTH POD PARKING LOT**

SCALE: 1" = 20' SHEET NO. 7 OF 24 SHEETS

F.A. RTE.	SECTION	COUNTY	TOTAL SHEETS	SHEET NO.
NA	08-00169-00-PK	COOK	24	7
			CONTRACT NO. 63360	
ILLINOIS FED. AID PROJECT				