

QUANTITY  
 4 (100) LINE = 64.1 ft. (19.7 m)  
 21.1 sq. ft. (1.97 sq. m)

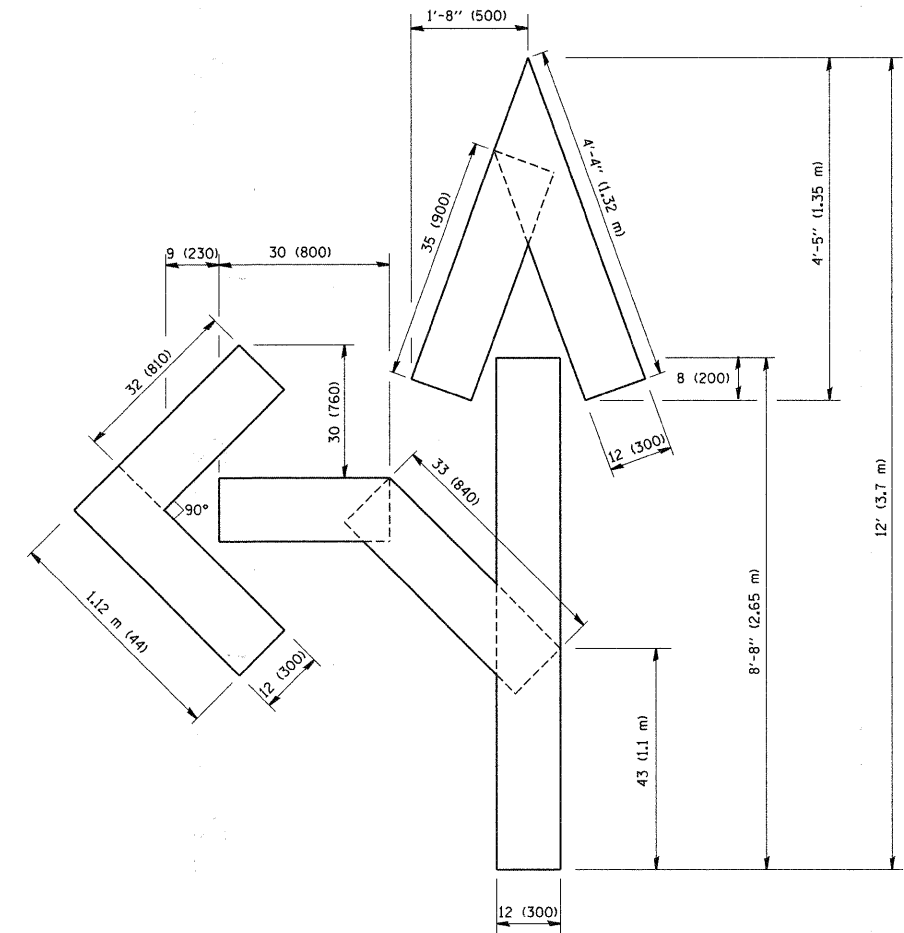

QUANTITY  
 4 (100) LINE = 82.5 ft. (25.3 m)  
 27.5 sq. ft. (2.53 sq. m)

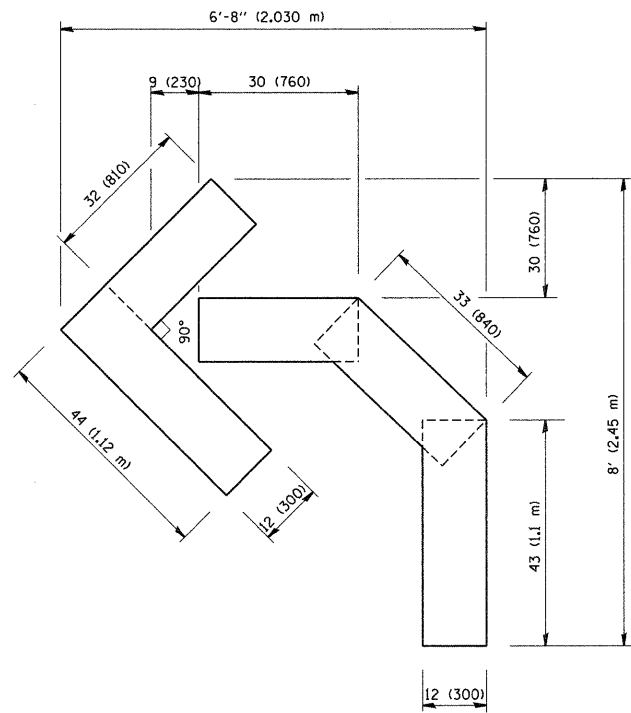

QUANTITY  
 4 (100) LINE = 45.5 ft. (13.9 m)  
 15.2 sq. ft. (1.39 sq. m)

All dimensions are in inches (millimeters) unless otherwise shown.

FILE NAME = W:\diststd\22x34\tc16.dgn	USER NAME = geglianobt	DESIGNED - DRAWN -	REVISED -T. RAMMACHER 06-05-96 REVISED -T. RAMMACHER 11-04-97	<b>STATE OF ILLINOIS DEPARTMENT OF TRANSPORTATION</b>	<b>PAVEMENT MARKING LETTERS AND SYMBOLS FOR TRAFFIC STAGING</b>			F.A.U. RTE. 2534	SECTION 09-00074-00-RS	COUNTY DUPAGE	TOTAL SHEETS 22	SHEET NO. 21	
PLOT SCALE = 50.0000' / IN.	CHECKED -	REVISED -T. RAMMACHER 03-02-98	REVISED -E. GOMEZ 08-28-00		SCALE: NONE	SHEET NO. 1	OF 1 SHEETS	STA.	TO STA.	<b>TC-16</b>			CONTRACT NO. 63374
PLOT DATE = 1/4/2008	DATE = 09-18-94							FED. ROAD DIST. NO. 1   ILLINOIS FED. AID PROJECT ARA-9003(405)					