

THE TRAFFIC SIGNAL CONTROL EQUIPMENT FOR THE PROJECT SHALL BE "ECONOLITE" TO MATCH THE EXISTING ADJACENT SYSTEM.

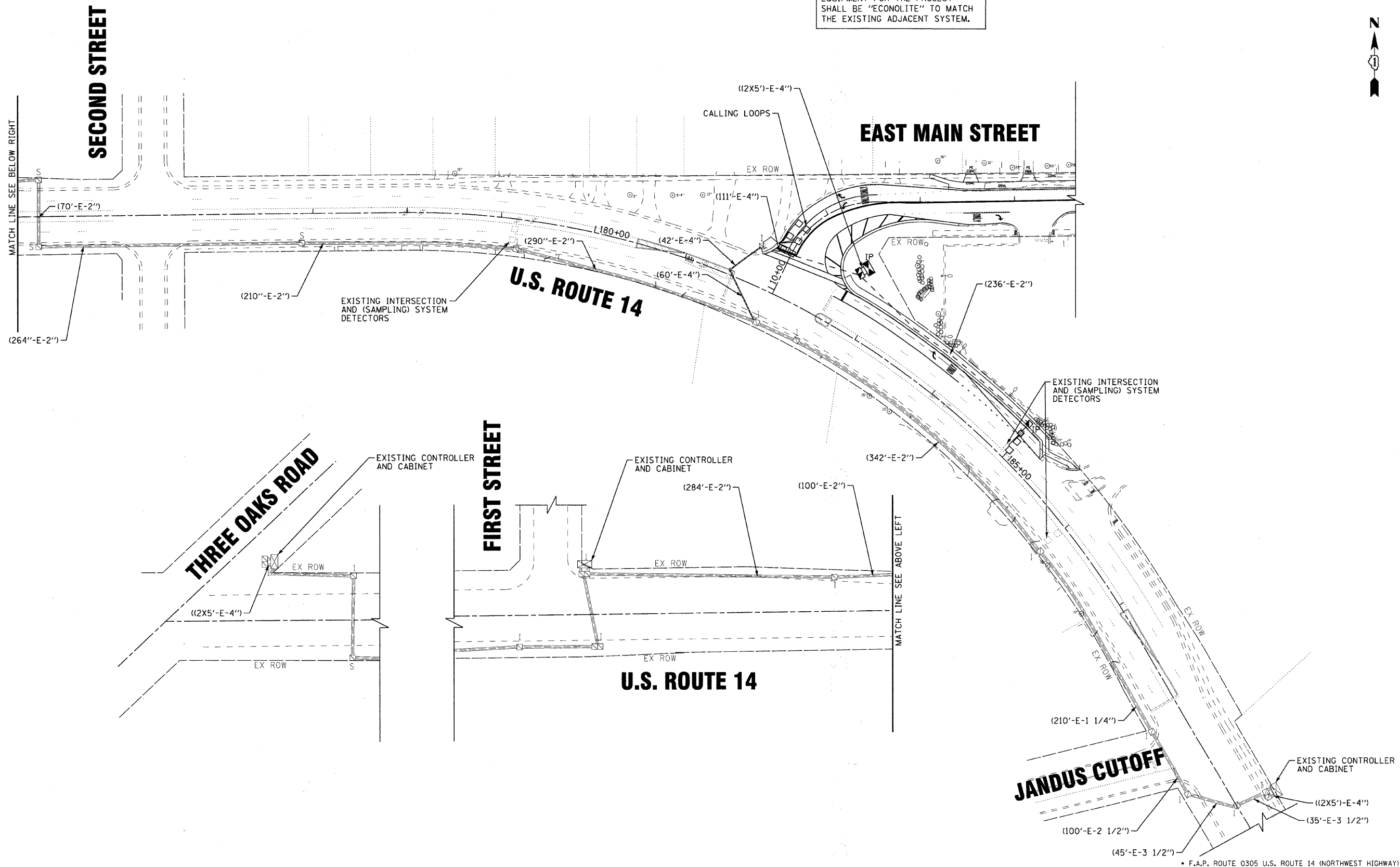

COPYRIGHT © 2009 BY BAXTER & WOODMAN, INC.
 ALL RIGHTS RESERVED. THIS DRAWING IS THE PROPERTY OF BAXTER & WOODMAN, INC. AND IS NOT TO BE REPRODUCED OR TRANSMITTED IN ANY FORM OR BY ANY MEANS, ELECTRONIC OR MECHANICAL, WITHOUT PERMISSION IN WRITING FROM BAXTER & WOODMAN, INC.
 LICENSE NO. 184-00127 - EXPIRES 4/30/2011
 FILE: C:\P\080298-1S_INTER.sht
 11/17/09 10:52:24 AM
 2639c0c



DESIGNED - JJF	REVISED - MCDPD REVIEW 11/3/09
DRAWN - CJC	REVISED - IDOT REVIEW 11/17/09
CHECKED - RWL	REVISED -
DATE - 09/11/09	FILE - 080298-TS_INTER.sht

VILLAGE CARY, ILLINOIS
U.S. ROUTE 14 AT EAST MAIN STREET RIGHT-TURN LANE STP
AND EAST MAIN STREET ARRA IMPROVEMENTS

TRAFFIC SIGNAL INTERCONNECT PLAN	
SCALE: 1" = 50'	STA. TO STA.

F.A. RTE.	SECTION	COUNTY	TOTAL SHEETS	SHEET NO.
C-91-619-09	08-00054-00-CH	McHENRY	56	39
FED. ROAD DIST. NO. 1 ILLINOIS FED. AID PROJECT M-ARA-9003313			CONTRACT NO. 63404	