

QUANTITY  
 4 (100) LINE = 64.1 ft. (19.7 m)  
 21.1 sq. ft. (1.97 sq. m)

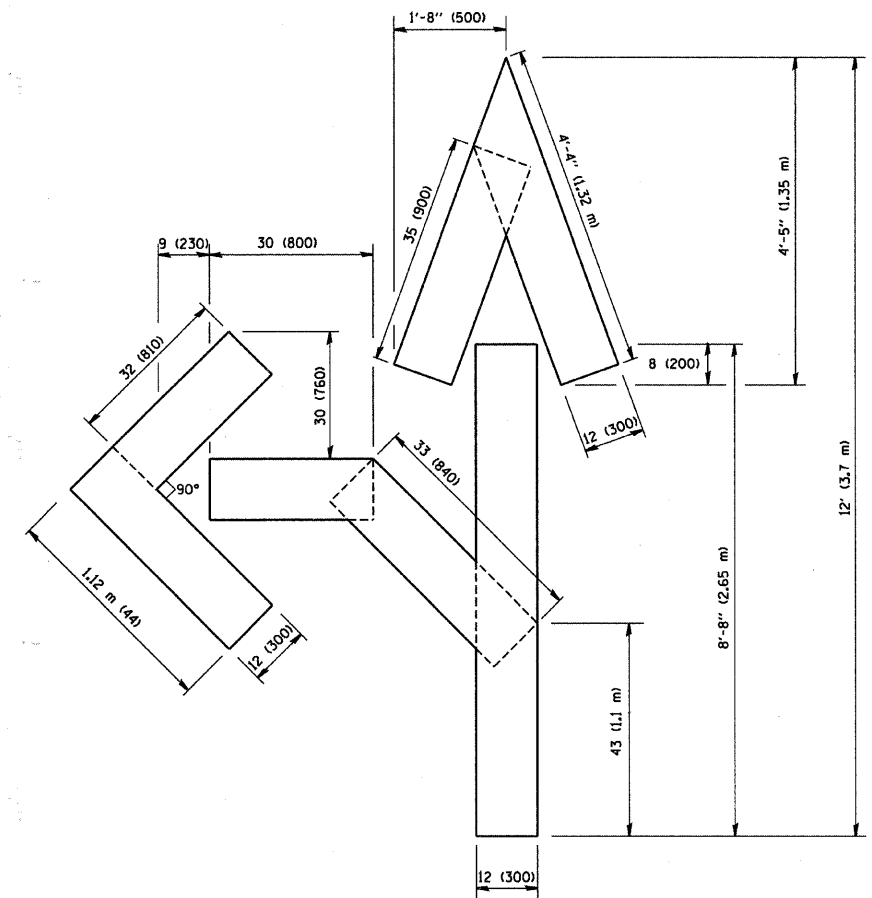

QUANTITY  
 4 (100) LINE = 82.5 ft. (25.3 m)  
 27.5 sq. ft. (2.53 sq. m)

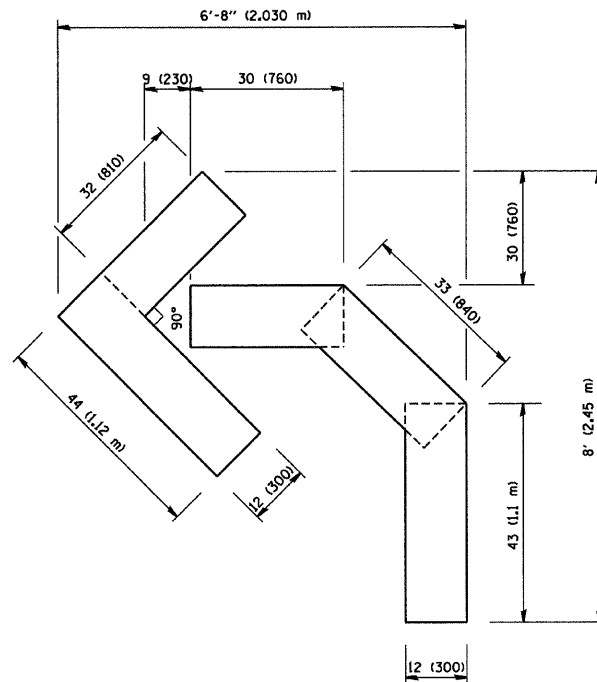

QUANTITY  
 4 (100) LINE = 45.5 ft. (13.9 m)  
 15.2 sq. ft. (1.39 sq. m)

\* F.A.P. ROUTE 0305 U.S. ROUTE 14 (NORTHWEST HIGHWAY)  
 F.A.U. ROUTE 3877 EAST MAIN STREET  
 PROJECT No: M-ARA-9003(313)  
 JOB No: C-91-619-09

All dimensions are in inches (millimeters) unless otherwise shown.

FILE NAME = W:\data\22x34\16.dgn	USER NAME = gaglienobt	DESIGNED - DRAWN -	REVISED -T. RAMMACHER 06-05-96 REVISED -T. RAMMACHER 11-04-97	<b>STATE OF ILLINOIS DEPARTMENT OF TRANSPORTATION</b>	<b>PAVEMENT MARKING LETTERS AND SYMBOLS FOR TRAFFIC STAGING</b>			F.A. - RTE. *	SECTION 08-00054-00-CH	COUNTY MCHENRY	TOTAL SHEETS 56	SHEET NO. 50
	PLOT SCALE = 50,0000 ' / IN.	CHECKED -	REVISED -T. RAMMACHER 03-02-98		SCALE: NONE	SHEET NO. 1 OF 1 SHEETS	STA.	TO STA.	<b>TC-16</b>		<b>CONTRACT NO. 63404</b>	
	PLOT DATE = 1/4/2008	DATE - 09-18-94	REVISED -E. GOMEZ 08-28-00						FED. ROAD DIST. NO. 1 ILLINOIS FED. AID PROJECT			