

PILE DATA

Type and Size: Metal Shell - 14 in. dia. x 0.25 in. walls
 Nominal Required Bearings: 390K
 Factored Resistance Available: 130K
 Est. Length: 80'
 No. Production Piles: 11
 No. Test Piles: 0

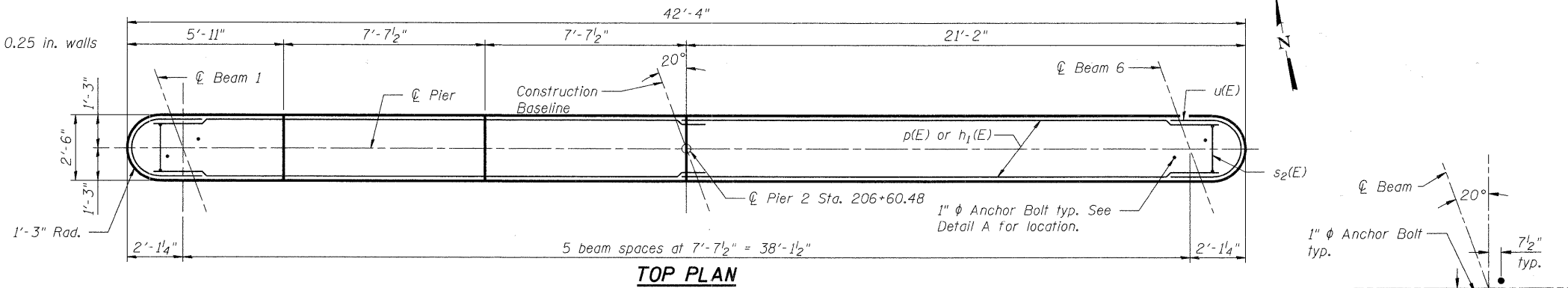

TOP PLAN

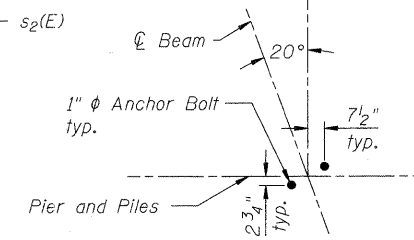

DETAIL A

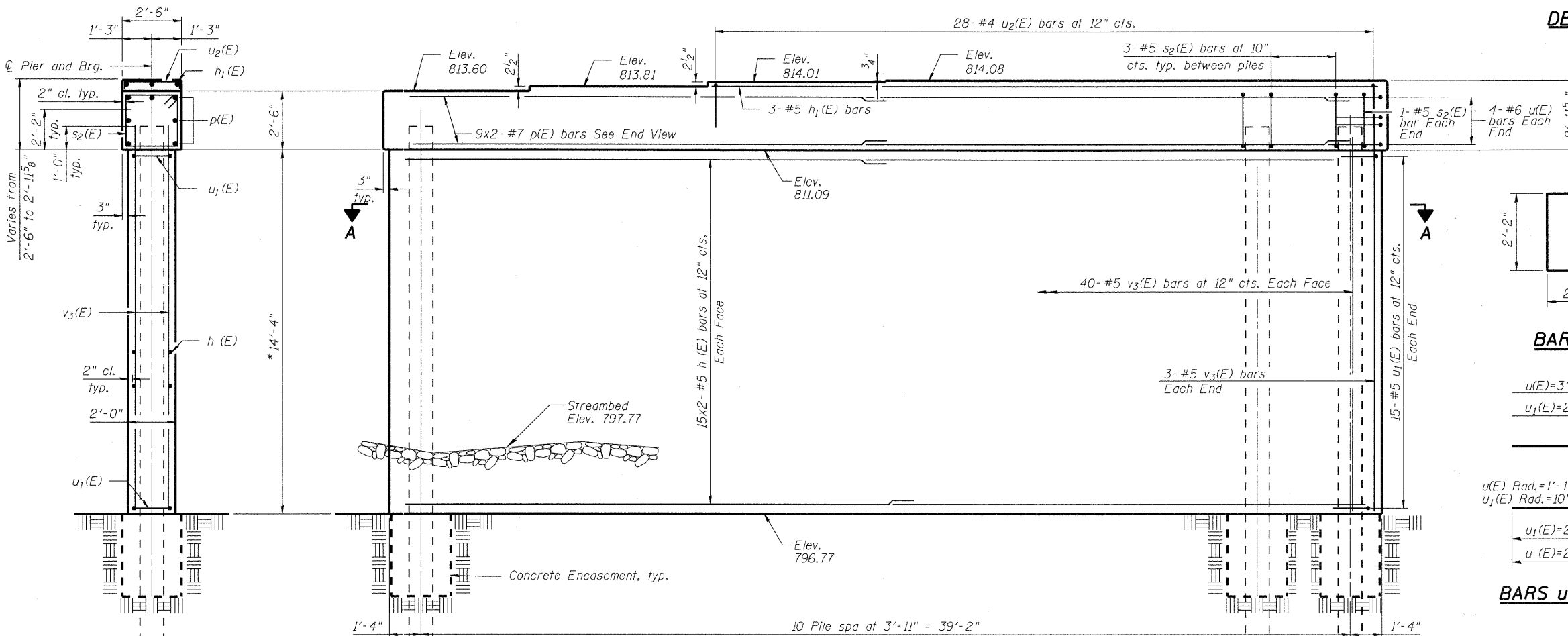

ELEVATION
(Looking North)

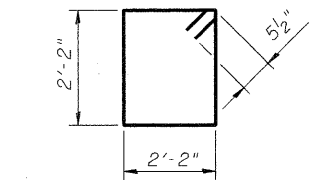

BAR s2(E)

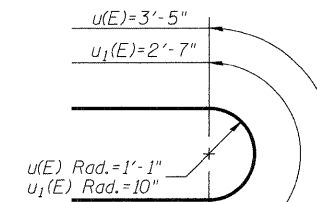

BARS u(E) & u1(E)

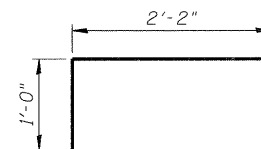

BAR u2(E)

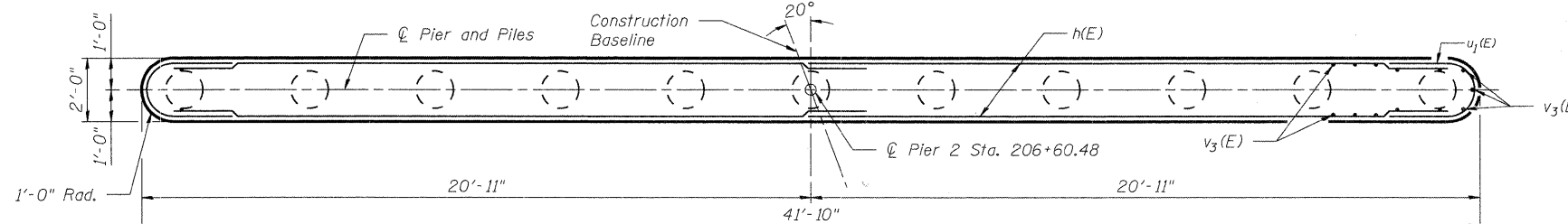

SECTION A-A

BILL OF MATERIAL

| Bar | No. | Size | Length | Shape |
|--|-----|------|---------|-------|
| h(E) | 60 | #5 | 21'-2" | — |
| h1(E) | 3 | #5 | 27'-2" | — |
| p(E) | 18 | #7 | 23'-5" | — |
| s2(E) | 32 | #5 | 9'-7" | □ |
| u(E) | 8 | #6 | 8'-7" | U |
| u1(E) | 30 | #5 | 6'-11" | U |
| u2(E) | 28 | #4 | 4'-2" | □ |
| v3(E) | 86 | #5 | 16'-6" | — |
| Concrete Structures | | | Cu. Yd. | 55.1 |
| Reinforcement Bars, Epoxy Coated | | | Pound | 4,470 |
| Concrete Encasement | | | Cu. Yd. | 6.0 |
| Furnishing Metal Shell Piles - 14" x 0.250" | | | Foot | 880 |
| Driving Piles | | | Foot | 880 |
| Underwater Structure Excavation Protection, Special - Location 2 | | | Each | 1 |

Reinforcement Bars designated (E) shall be epoxy coated.

Notes:
 Space reinforcement in cap to miss anchor bolts.
 Pour steps monolithically with cap.
 For details of pile and Concrete Encasement, see Sheet S-23 of S-25.
 See "Underwater Structure Excavation Protection Special" special provision.

MINIMUM BAR LAP

#5 bar = 2'-2"
 #7 bar = 4'-10"

PIER 2 DETAILS

THOMPSON ROAD
 OVER NIPPERSINK CREEK
 SECTION NO. 06-00005-00-BR
 McHENRY COUNTY
 STATION 206+30.48
 STRUCTURE NO. 056-6006

DATE: 11/18/09

| | |
|----------|---------|
| DESIGNED | MGH/JPG |
| CHECKED | KMA |
| DRAWN | WJH |
| CHECKED | RGD |

FILE NAME: 060561_Pier 2.dwg
 PLOT DRIVER: plot.plt
 PLOT TABLE: standard-trans.tbl



| | | | | | |
|---|-------------|--------------------|---------|--------------|-----------|
| SHEET NO. S-21 | F.A.U. RTE. | SECTION | COUNTY | TOTAL SHEETS | SHEET NO. |
| | 4081 | 06-00005-00-BR | McHENRY | 45 | 32 |
| S-25 SHEETS | | CONTRACT NO. 63409 | | | |
| FED. ROAD DIST. NO. 1 ILLINOIS FED. AID PROJECT | | | | | |