

IRVING AVENUE (NORTH)

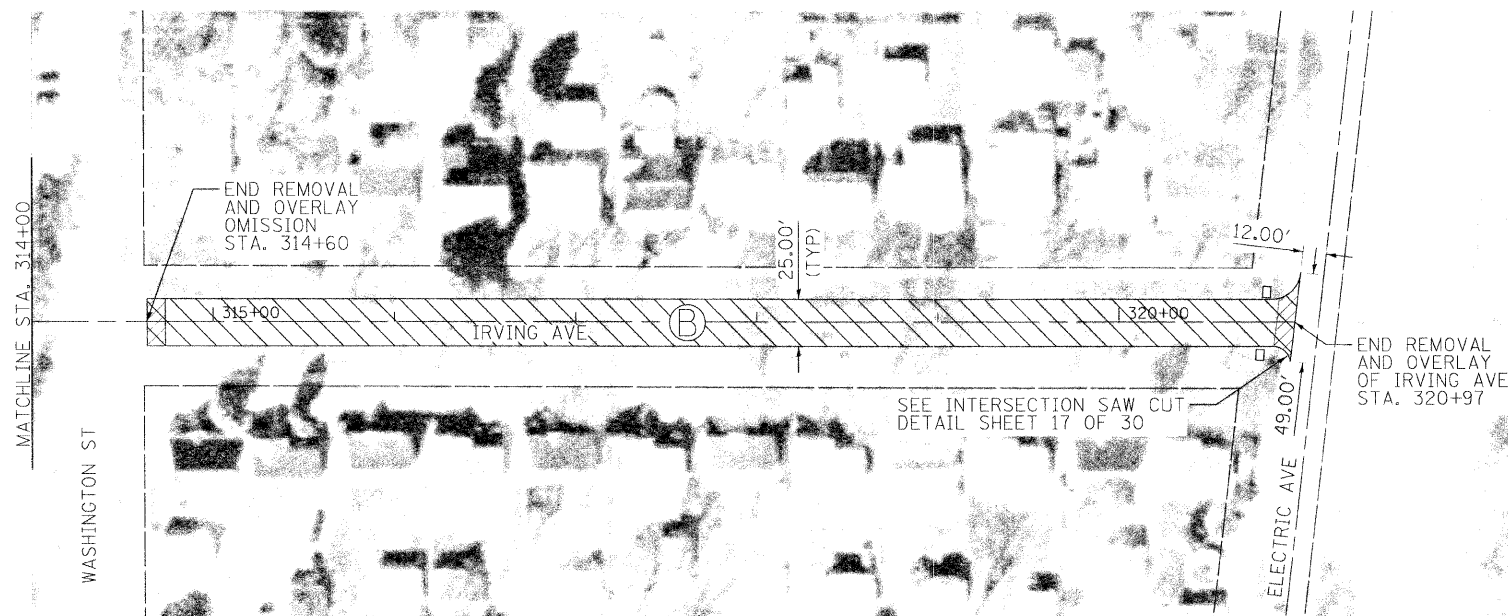

IRVING AVENUE (NORTH)

SEE SCHEDULE OF QUANTITIES FOR LOCATIONS OF SIDEWALK, DETECTABLE WARNINGS, HOT-MIX ASPHALT SURFACE REMOVAL (BUTT-JOINT), CURB AND GUTTER, & FRAMES AND LIDS TO BE ADJUSTED (SPECIAL).

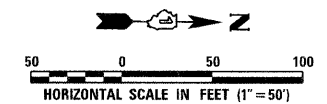
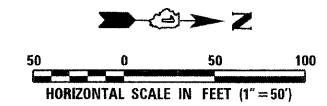

DESIGNED - DWP	REVISED _____	STATE OF ILLINOIS DEPARTMENT OF TRANSPORTATION	IRVING AVENUE (NORTH) PLAN SHEET	F.A. _____	SECTION _____	COUNTY _____	TOTAL SHEET _____	
DRAWN - DWP	REVISED _____			RTE. _____	09-00046-00-RS	COOK	30	11
CHECKED - SJM	REVISED _____			CONTRACT NO. 63414				
DATE - 11/30/09	REVISED _____			ILLINOIS FED. AID PROJECT				
SCALE: 1" = 50'		SHEET NO. 11 OF 30 SHEETS		STA. _____	TO STA. _____			