

HYDRANT TEE PAVEMENT MARKINGS NOT SHOWN FOR CLARITY. SEE DETAIL SHEET 26 OF 30. SEE SCHEDULE OF QUANTITIES FOR ALL PAVEMENT MARKING LOCATIONS AND INFORMATION.

ALL CROSSWALK AND STOP BAR PAVEMENT MARKINGS SHALL IN ACCORDANCE WITH THE LATEST IDOT STANDARDS AND THE MUTCD. STOP BARS NEAR CROSSWALKS SHALL BE LOCATED 4 FEET OFF THE CROSSWALK MARKINGS.

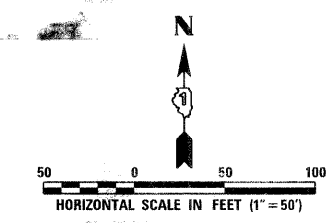
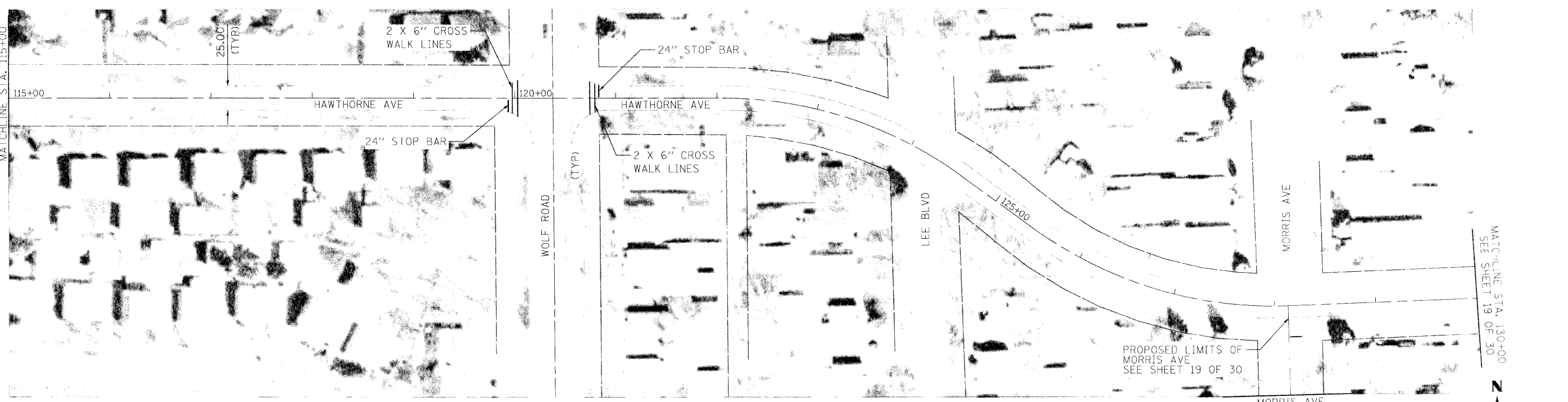
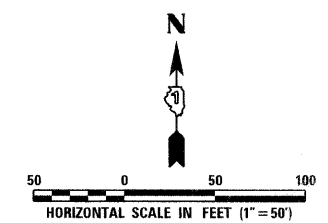

DESIGNED -	DWP
DRAWN -	DWP
CHECKED -	SJM
DATE -	11/30/09

REVISED	_____
REVISED	_____
REVISED	_____
REVISED	_____

STATE OF ILLINOIS
DEPARTMENT OF TRANSPORTATION

HAWTHORNE AVENUE
STA. 100+00 TO STA. 130+00
PAVEMENT MARKING PLAN SHEET

SCALE: 1" = 50' SHEET NO. 18 OF 30 SHEETS STA. TO STA.

F.A. RTE.	SECTION	COUNTY	TOTAL SHEETS NO.
	09-00046-00-RS	COOK	30 18
			CONTRACT NO. 63414
ILLINOIS FFD-AD PROJECT			