

F.A.U. RTE.	SECTION	COUNTY	TOTAL SHEETS	SHEET NO.
2831	09-00041-00-SW	COOK	19	1
FEDERAL ROAD DISTRICT NO. 1 ILLINOIS		CONTRACT NO. 63421		

STATE OF ILLINOIS
DEPARTMENT OF TRANSPORTATION
DIVISION OF HIGHWAYS

PLANS FOR PROPOSED FEDERAL AID PROJECT

INDEX OF SHEETS

- 1 COVER SHEET
- 2 SUMMARY OF QUANTITIES AND GENERAL NOTES
- 3 TYPICAL SECTIONS
- 4 SCHEDULE OF QUANTITIES
- 5-6 SIDEWALK PLAN
- 7-10 DETAILS
- 11-19 CROSS SECTIONS

FOR INDEX OF HIGHWAY STANDARDS AND BENCHMARKS SEE SHEET NO. 2

**KEDZIE AVENUE (FAU 2831)
153RD STREET TO 159TH STREET
SIDEWALK CONSTRUCTION
SECTION No. 09-00041-00-SW
PROJECT No. ARA 9003(395)
JOB No. C-91-783-09
CITY OF MARKHAM
COOK COUNTY**

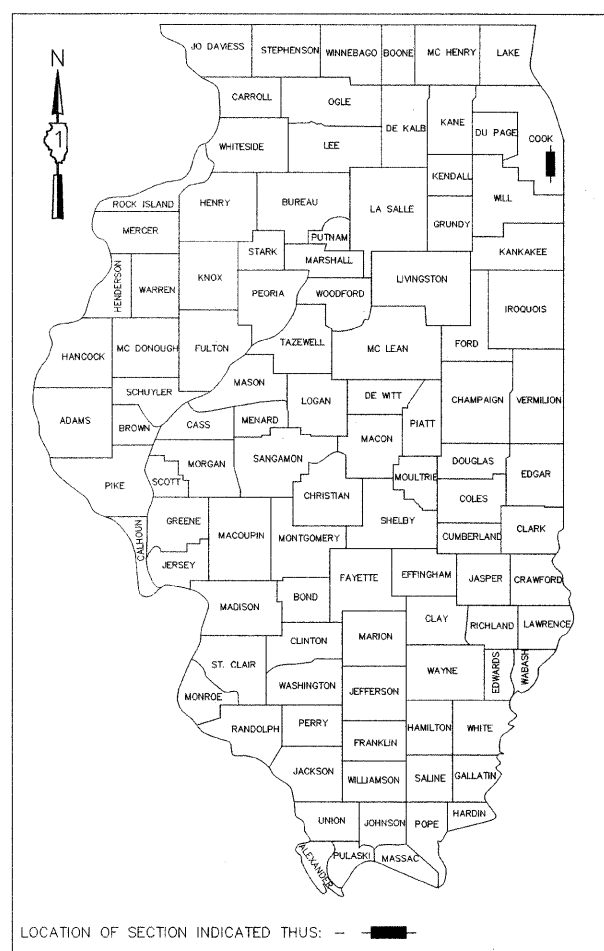

KEDZIE AVENUE MINOR ARTERIAL
ADT= 16,300 (2006)
POSTED SPEED LIMIT=45 M.P.H.

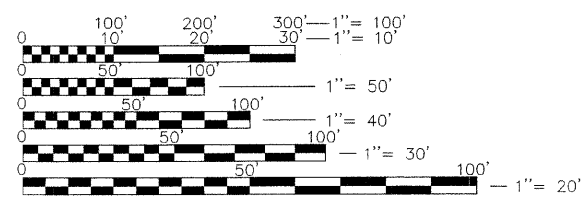

FULL SIZE PLANS HAVE BEEN PREPARED USING STANDARD ENGINEERING SCALES. REDUCED SIZED PLANS WILL NOT CONFORM TO STANDARD SCALES. IN MAKING MEASUREMENTS ON REDUCED PLANS, THE ABOVE SCALES MAY BE USED.

J.U.L.I.E.
JOINT UTILITY LOCATION INFORMATION FOR EXCAVATION
1-800-892-0123 OR 811

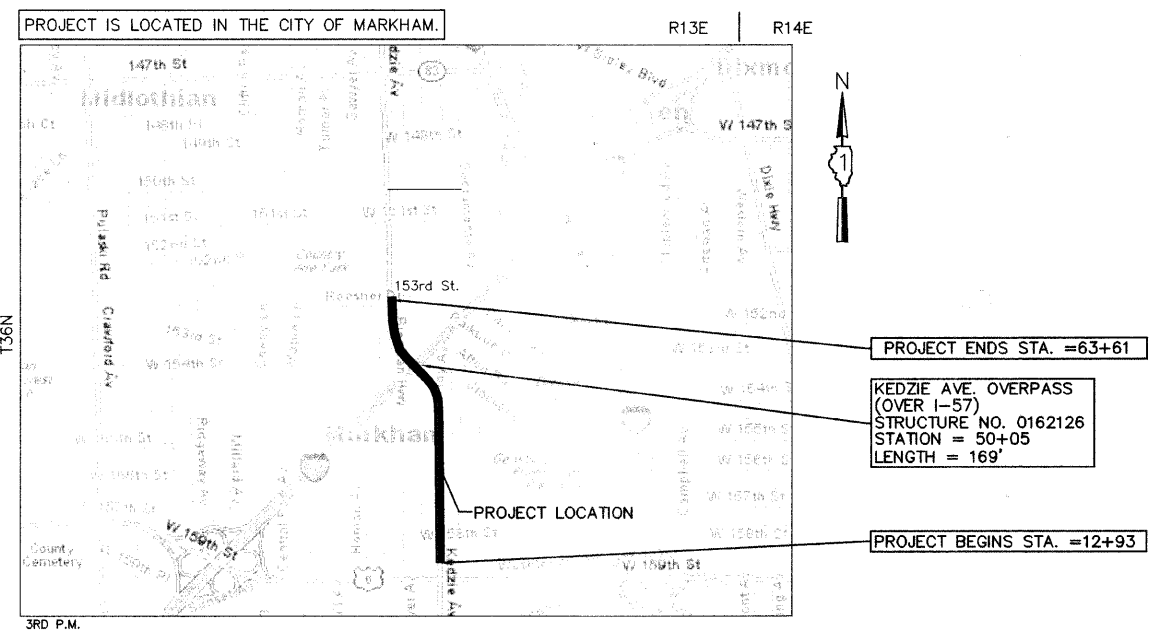

LOCATION MAP
N.T.S.
BREMEN TOWNSHIP

GROSS LENGTH OF PROJECT = 5,068 FEET (0.96 MI)
NET LENGTH OF PROJECT = 5,068 FEET (0.96 MI)

FIELD ENGINEER: MELCHOR MANGOBA (847) 705-4408
CONSULTANTS: BURKE ENGINEERING CORPORATION (708) 326-4000

CONTRACT NO. 63421

STATE OF ILLINOIS
DEPARTMENT OF TRANSPORTATION
DIVISION OF HIGHWAYS

APPROVED 11-30 2009
David Weis
MAYOR, CITY OF MARKHAM

PASSED 12-15 2009
G.Holt/ch
DISTRICT 1 ENGINEER OF LOCAL ROADS AND STREETS

RELEASING FOR BID BASED ON LIMITED REVIEW 12-15 2009
Diana M. O'Keefe
DEPUTY DIRECTOR OF HIGHWAYS, REGION ONE ENGINEER

PRINTED BY THE AUTHORITY
OF THE STATE OF ILLINOIS

Mark A. Wesolowski
ENGINEER DATE 11/30/09

MARK A. WESOLOWSKI
ILLINOIS REGISTRATION NO. 062054598
EXPIRATION DATE: 11/30/11

PLANS PREPARED BY:

BE BURKE ENGINEERING CORPORATION
Civil Engineer Consultants - Planners - Land Surveyors
18330 Distinctive Drive Orland Park, Illinois 60467
Phone: (708) 326-4000 Fax: (708) 326-4050