

**STAGE I CONSTRUCTION**

1. WORK DURING THIS STAGE SHALL CONSIST OF THE REMOVAL AND REPLACEMENT OF UTILITIES AND ROADWAY AS INDICATED ON THE PROPOSED PAVEMENT AND UTILITY PLANS ALONG SOUTH SIDE OF ST. CHARLES RD.
2. ALL THE PRIVATE AND COMMERCIAL DRIVEWAYS TO BE OPENED ALL THE TIME FOR TRAFFIC OR AS DIRECTED BY THE ENGINEER.
3. IDOT STANDARD 701501-05 SHALL BE USED TO ESTABLISH TRAFFIC CONTROL AND PROTECTION NECESSARY FOR SAW CUTTING, THE REMOVAL OF EXISTING PAVEMENT, EARTH EXCAVATION AS NECESSARY AND PERFORMING ALL THE PROPOSED PAVEMENT WORK ALONG SOUTH SIDE OF ST. CHARLES RD.
4. INTERSECTIONS ARE TO REMAIN OPEN AT ALL TIMES, PAID FOR AS TEMPORARY ACCESS (ROAD), EXCEPT FOR PREPARATION, POURING AND CURING OF NEW PAVEMENT. THE CONTRACTOR MUST STAGGER INTERSECTIONS THAT ARE CLOSED SUCH THAT NO TWO INTERSECTIONS ADJACENT TO EACH OTHER ARE CLOSED AT THE SAME TIME.

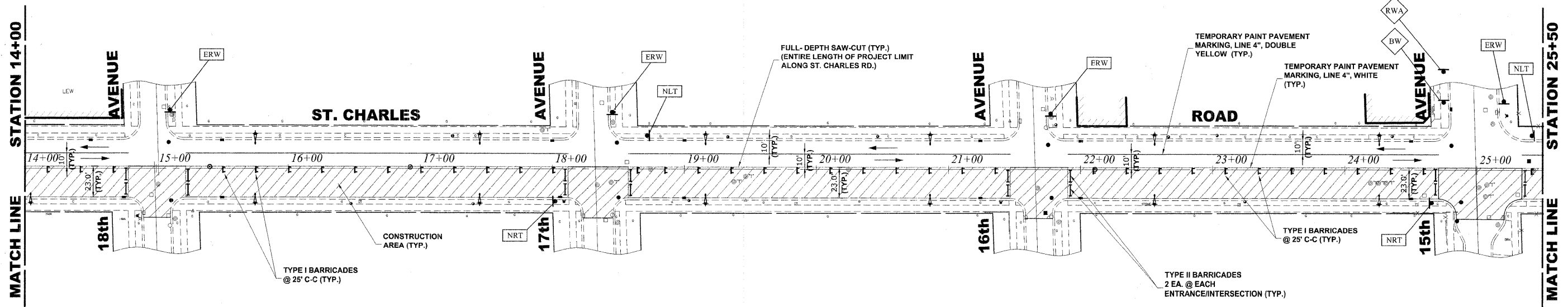
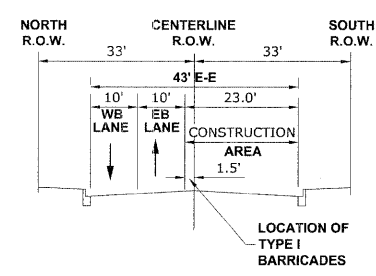
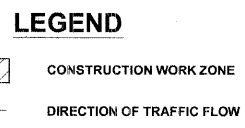

Drawing file: W:\Projects\56500290 - St. Charles Rd\12-St. Charles Staging.dwg Dec 04, 2009 - 1:46pm

**HANCOCK ENGINEERING**  
 Civil Engineers  
 Municipal Consultants  
 Established 1911

USER NAME -	DESIGNED - MK/SBC	REVISED -
DRAWN - MK/LEV	CHECKED - SBC/JGMV	REVISED -
DATE - 11-30-09		

**STATE OF ILLINOIS DEPARTMENT OF TRANSPORTATION**

**MAINTENANCE OF TRAFFIC PLAN STAGE I CONSTRUCTION**

SCALE: 1" = 40' SHEET NO. 1 OF 3 SHEETS STA. 3+50 TO STA. 25+50

F.A.U. RTE. 1397	SECTION 09-00129-00-PV	COUNTY COOK	TOTAL SHEETS 103	SHEET NO. 13
CONTRACT NO. 63428				
FED. ROAD DIST. NO. 1 ILLINOIS FED. AID PROJECT M-9003 (267)				
(BOOK NOS. 1579, 1583, 1589) E.H.E PROJECT NO. 565-08-29001				