

STAGE I CONSTRUCTION

1. WORK DURING THIS STAGE SHALL CONSIST OF THE REMOVAL AND REPLACEMENT OF UTILITIES AND ROADWAY AS INDICATED ON THE PROPOSED PAVEMENT AND UTILITY PLANS ALONG SOUTH SIDE OF ST. CHARLES RD.
2. ALL THE PRIVATE AND COMMERCIAL DRIVEWAYS TO BE OPENED ALL THE TIME FOR TRAFFIC OR AS DIRECTED BY THE ENGINEER.
3. IDOT STANDARD 701501-05 SHALL BE USED TO ESTABLISH TRAFFIC CONTROL AND PROTECTION NECESSARY FOR SAW CUTTING, THE REMOVAL OF EXISTING PAVEMENT, EARTH EXCAVATION AS NECESSARY AND PERFORMING ALL THE PROPOSED PAVEMENT WORK ALONG SOUTH SIDE OF ST. CHARLES RD.
4. INTERSECTIONS ARE TO REMAIN OPEN AT ALL TIMES, PAID FOR AS TEMPORARY ACCESS (ROAD), EXCEPT FOR PREPARATION, POURING AND CURING OF NEW PAVEMENT. THE CONTRACTOR MUST STAGGER INTERSECTIONS THAT ARE CLOSED SUCH THAT NO TWO INTERSECTIONS ADJACENT TO EACH OTHER ARE CLOSED AT THE SAME TIME.

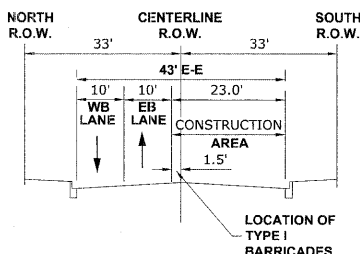

TYPICAL SECTION DURING STAGE I CONSTRUCTION

LEGEND

- CONSTRUCTION WORK ZONE
- DIRECTION OF TRAFFIC FLOW

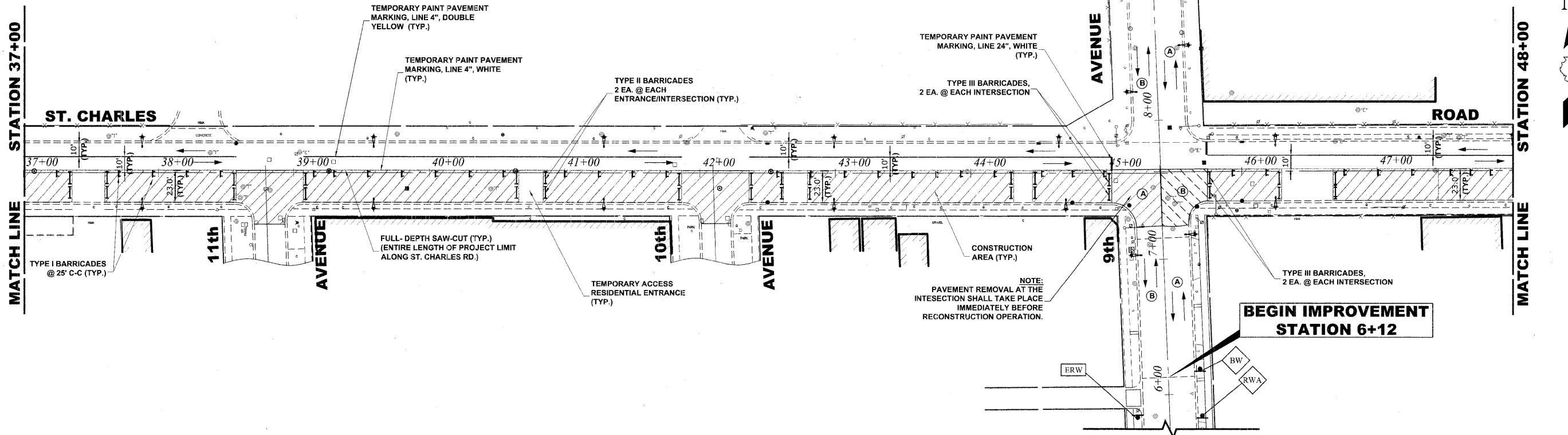

END IMPROVEMENT STATION 10+45

BEGIN IMPROVEMENT STATION 6+12

NOTE:
PAVEMENT REMOVAL AT THE INTERSECTION SHALL TAKE PLACE IMMEDIATELY BEFORE RECONSTRUCTION OPERATION.

Drawing file: W:\Projects\56508290 - St. Charles Rd\12_St. Charles Staging.dwg Dec 04, 2009 1:49pm

<p>HANCOCK ENGINEERING Civil Engineers Municipal Consultants Established 1911</p>	USER NAME -	DESIGNED - MK/SBC	REVISED -	STATE OF ILLINOIS DEPARTMENT OF TRANSPORTATION	MAINTENANCE OF TRAFFIC PLAN STAGE I CONSTRUCTION	F.A.U. RTE.	SECTION	COUNTY	TOTAL SHEETS	SHEET NO.
	PLOT SCALE -	DRAWN - MK/LEV	REVISED -			1397	09-00129-00-PV	COOK	103	14
	PLOT DATE -	CHECKED - SBC/JG/MV	REVISED -			CONTRACT NO. 63428				
		DATE - 11-30-09	REVISED -			FED. ROAD DIST. NO. 1 ILLINOIS FED. AID PROJECT M-9003 (267)				
					SCALE: 1" = 40'	SHEET NO. 2 OF 3 SHEETS		STA. 25+50 TO STA. 48+00		(BOOK NOS. 1579, 1583, 1589) E.H.E PROJECT NO. 565-08-29001