

MATCH LINE STATION 48+00

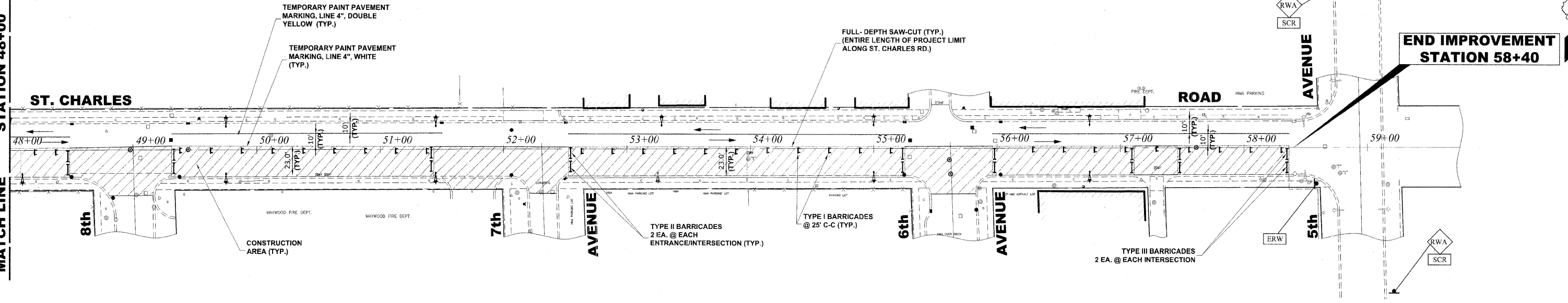

END IMPROVEMENT STATION 58+40

STAGE I CONSTRUCTION

1. WORK DURING THIS STAGE SHALL CONSIST OF THE REMOVAL AND REPLACEMENT OF UTILITIES AND ROADWAY AS INDICATED ON THE PROPOSED PAVEMENT AND UTILITY PLANS ALONG SOUTH SIDE OF ST. CHARLES RD.
2. ALL THE PRIVATE AND COMMERCIAL DRIVEWAYS TO BE OPENED ALL THE TIME FOR TRAFFIC OR AS DIRECTED BY THE ENGINEER.
3. IDOT STANDARD 701501-05 SHALL BE USED TO ESTABLISH TRAFFIC CONTROL AND PROTECTION NECESSARY FOR SAW CUTTING, THE REMOVAL OF EXISTING PAVEMENT, EARTH EXCAVATION AS NECESSARY AND PERFORMING ALL THE PROPOSED PAVEMENT WORK ALONG SOUTH SIDE OF ST. CHARLES RD.
4. INTERSECTIONS ARE TO REMAIN OPEN AT ALL TIMES, PAID FOR AS TEMPORARY ACCESS (ROAD), EXCEPT FOR PREPARATION, POURING AND CURING OF NEW PAVEMENT. THE CONTRACTOR MUST STAGGER INTERSECTIONS THAT ARE CLOSED SUCH THAT NO TWO INTERSECTIONS ADJACENT TO EACH OTHER ARE CLOSED AT THE SAME TIME.

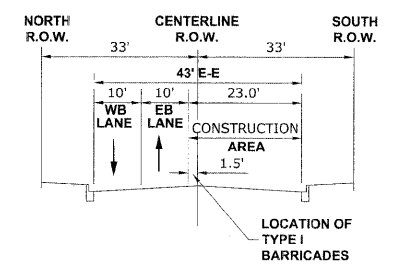

TYPICAL SECTION DURING STAGE I CONSTRUCTION

LEGEND

CONSTRUCTION WORK ZONE

DIRECTION OF TRAFFIC FLOW

Drawing file: W:\Projects\56508290 - St. Charles Rd\12_St. Charles Staging.dwg Dec 04, 2009 1:49pm

HANCOCK ENGINEERING
 Civil Engineers
 Municipal Consultants
 Established 1911

9311 Riverfront Road
 Winnetka, Illinois 60094-1790
 Phone: 708.942.4300
 Fax: 708.942.1222

USER NAME -	DESIGNED - MK/SBC	REVISED -
	DRAWN - MK/LEV	REVISED -
PLOT SCALE -	CHECKED - SBC/JG/MV	REVISED -
PLOT DATE -	DATE - 11-30-09	REVISED -

STATE OF ILLINOIS DEPARTMENT OF TRANSPORTATION

MAINTENANCE OF TRAFFIC PLAN STAGE I CONSTRUCTION

SCALE: 1" = 40' SHEET NO. 3 OF 3 SHEETS STA. 48+00 TO STA. 58+95

F.A.U. RTE.	SECTION	COUNTY	TOTAL SHEETS	SHEET NO.
1397	09-00129-00-PV	COOK	103	15
CONTRACT NO. 63428			FED. ROAD DIST. NO. 1 ILLINOIS FED. AID PROJECT M-9003 (267)	
(BOOK NOS. 1579, 1583, 1589) E.H.E PROJECT NO. 565-08-29001				