

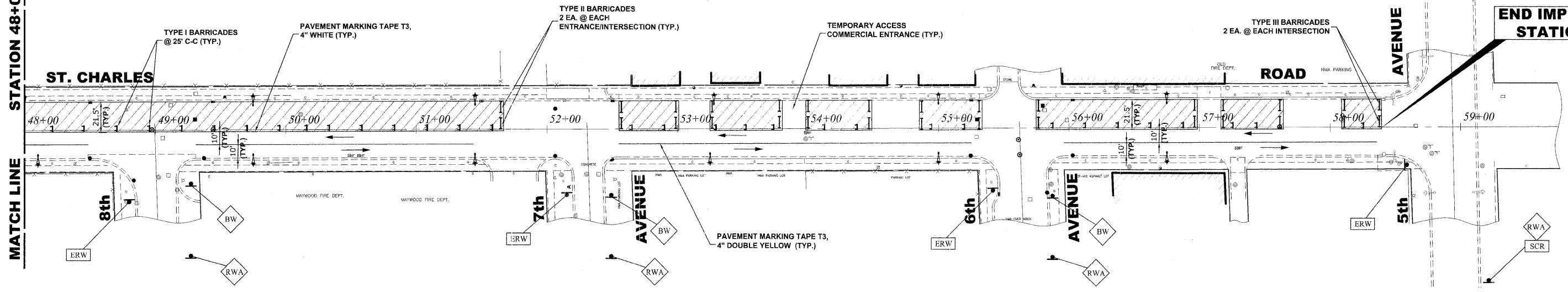

MATCH LINE STATION 48+00

END IMPROVEMENT STATION 58+40



STAGE II CONSTRUCTION

1. WORK DURING THIS STAGE SHALL CONSIST OF THE REMOVAL AND REPLACEMENT OF UTILITIES AND ROADWAY AS INDICATED ON THE PROPOSED PAVEMENT AND UTILITY PLANS ALONG NORTH SIDE OF ST. CHARLES RD.
2. ALL THE PRIVATE AND COMMERCIAL DRIVEWAYS TO BE OPENED ALL THE TIME FOR TRAFFIC OR AS DIRECTED BY THE ENGINEER.
3. IDOT STANDARD 701501-05 SHALL BE USED TO ESTABLISH TRAFFIC CONTROL AND PROTECTION NECESSARY FOR SAW CUTTING, THE REMOVAL OF EXISTING PAVEMENT, EARTH EXCAVATION AS NECESSARY AND PERFORMING ALL THE PROPOSED PAVEMENT WORK ALONG NORTH SIDE OF ST. CHARLES RD.
4. INTERSECTIONS ARE TO REMAIN OPEN AT ALL TIMES, PAID FOR AS TEMPORARY ACCESS (ROAD), EXCEPT FOR PREPARATION, POURING AND CURING OF NEW PAVEMENT. THE CONTRACTOR MUST STAGGER INTERSECTIONS THAT ARE CLOSED SUCH THAT NO TWO INTERSECTIONS ADJACENT TO EACH OTHER ARE CLOSED AT THE SAME TIME.

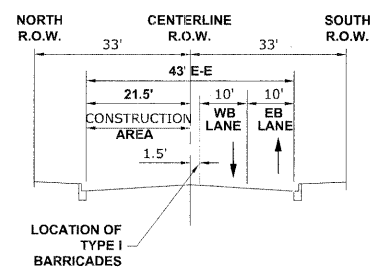

TYPICAL SECTION DURING STAGE II CONSTRUCTION

LEGEND

- CONSTRUCTION WORK ZONE
- DIRECTION OF TRAFFIC FLOW

Drawing file: W:\Projects\55502230 - St. Charles Rd\12...St. Charles Staging.dwg Dec 04, 2009 - 1:49pm



USER NAME -	DESIGNED - MK/SBC	REVISED -
	DRAWN - MK/LEV	REVISED -
PLOT SCALE -	CHECKED - SBC/JG/MV	REVISED -
PLOT DATE -	DATE - 11-30-09	REVISED -

**STATE OF ILLINOIS
DEPARTMENT OF TRANSPORTATION**

**MAINTENANCE OF TRAFFIC PLAN
STAGE II CONSTRUCTION**

SCALE: 1" = 40' SHEET NO. 3 OF 3 SHEETS STA. 48+00 TO STA. 58+40

F.A.U. R.T.E. NO.	SECTION	COUNTY	TOTAL SHEETS	SHEET NO.
1397	09-00129-00-PV	COOK	103	18
CONTRACT NO. 63428				
FED. ROAD DIST. NO. 1 ILLINOIS FED. AID PROJECT M-9003 (267)				
(BOOK NOS. 1579, 1583, 1589) E.H.E PROJECT NO. 565-08-29001				