

EXISTING TOPOGRAPHY

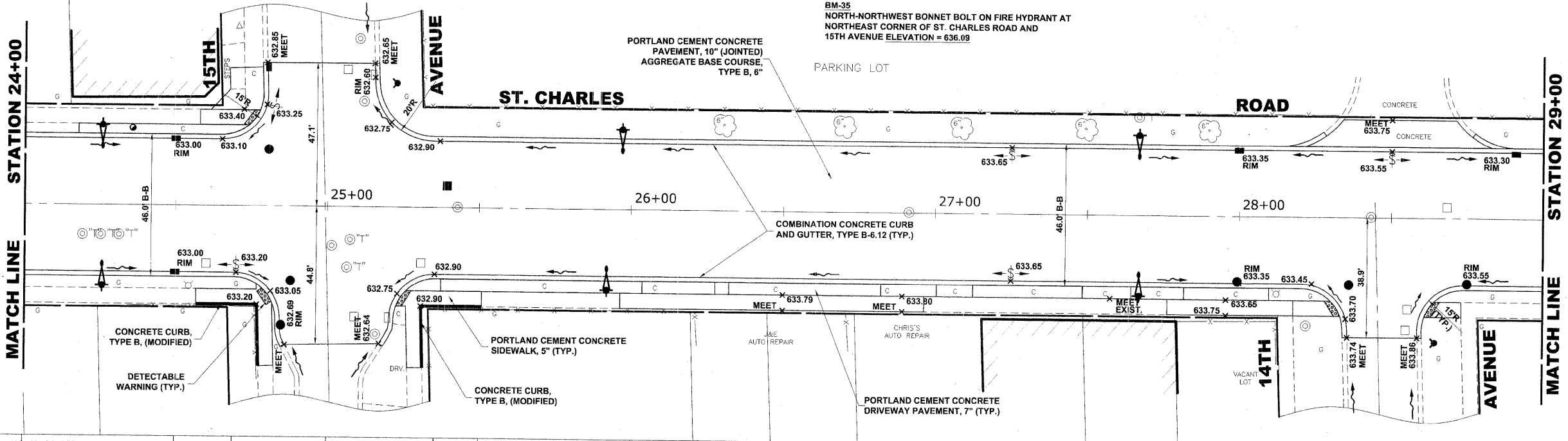

PROPOSED IMPROVEMENT

STA.	24+00	+50	+69	25+00	+35	+50	26+00	+50	27+00	+25	+50	28+00	+23	+45	+75	+91	29+00
634																	
632		633.20 (N,S)		633.00 (NL) (N) 633.00 (NL) (S)	632.90 (N,S)	632.85 (N,S)	633.15 (N,S)	633.35 (N,S)	633.55 (N,S)	633.65 (SUMMIT)	633.55 (N,S)	633.35 (NL) (N) 633.35 (RDCB) (S)	633.45 (PC) (S)	633.55 (SUMMIT) (N)	633.55 (RDCB) (S)	633.30 (NL) (N)	633.35 633.65
630				633.10 (PT) (N) 633.20 (PC) (S) (SUMMIT)	CL-CL												
628																	
626																	

HANCOCK ENGINEERING
 Civil Engineers
 Municipal Consultants
 Established 1911

USER NAME --
 DESIGNED -- MK/SBC
 DRAWN -- MK/LEV
 CHECKED -- SBC/JG/MV
 DATE -- 11-30-09

REVISED --
 REVISED --
 REVISED --
 REVISED --

**STATE OF ILLINOIS
 DEPARTMENT OF TRANSPORTATION**

**ST. CHARLES ROAD
 PAVING PLAN AND PROFILE**

SCALE: 1"=20'H./2'V. SHEET NO. 5 OF 11 SHEETS STA 24+00 TO STA 29+00

F.A.U. RTE. 1997	SECTION 09-00129-00-PV	COUNTY COOK	TOTAL SHEETS 103	SHEET NO. 25
------------------	------------------------	-------------	------------------	--------------

CONTRACT NO. 63428
 FED. ROAD DIST. NO. 1 ILLINOIS FED. AID PROJECT M-9003 (267)
 (BOOK NOS. 1579, 1583, 1589) E.H.E PROJECT NO. 565-08-29001

Drawing file: W:\Projects\1550290 - St. Charles Rd\St. Charles Rd.dwg Dec 07, 2009 - 10:16am