

N
↑
EXISTING TOPOGRAPHY

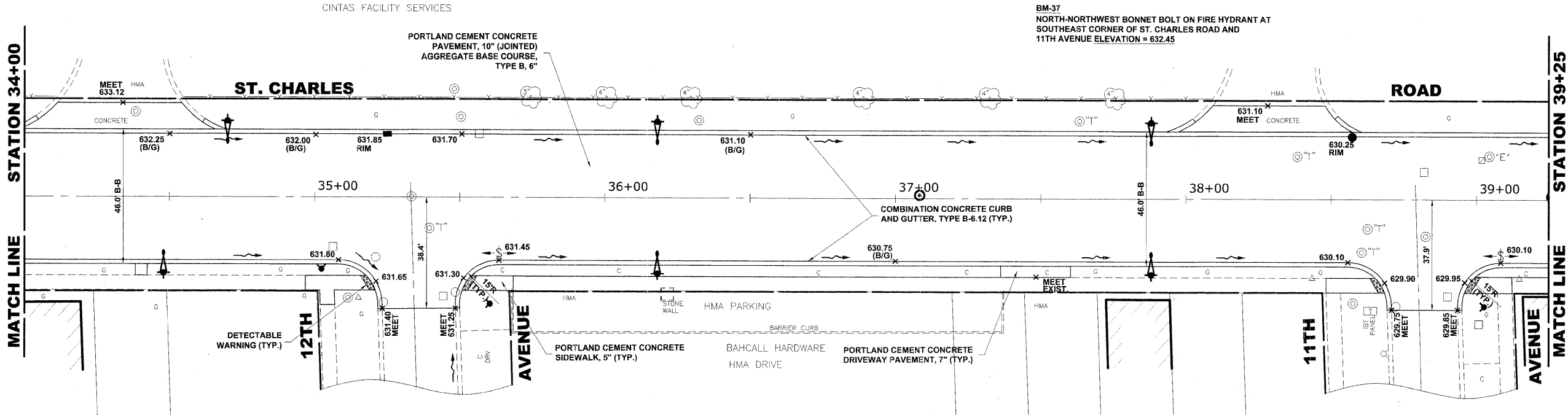

N
↑
PROPOSED IMPROVEMENT

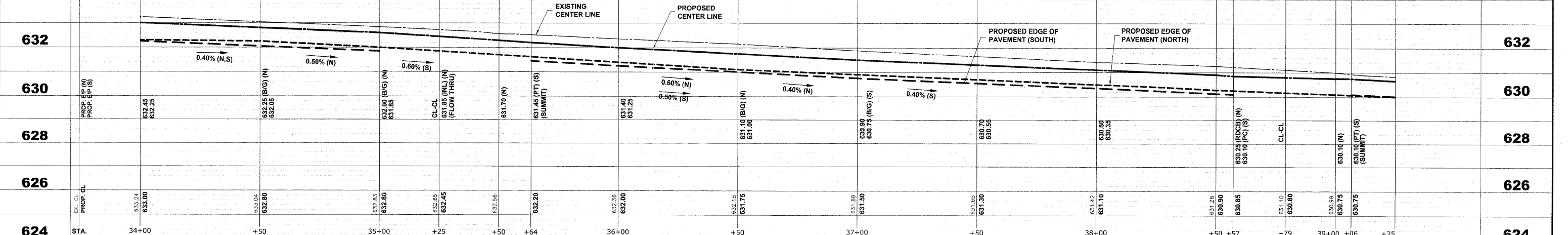

624	STA.	34+00	+50	35+00	+25	+50	+64	36+00	+50	37+00	+50	38+00	+50 +57	+79	39+00	+06	+25	624
		USER NAME - DESIGNED - MK/SBC DRAWN - MK/LEV CHECKED - SBC/JGMV PLOT DATE -		REVISED - REVISED - REVISED - REVISED -		STATE OF ILLINOIS DEPARTMENT OF TRANSPORTATION		ST. CHARLES ROAD PAVING PLAN AND PROFILE		P.A.U. RTE. 1397 SECTION 09-00129-00-PV COUNTY COOK TOTAL SHEETS 103 SHEET NO. 27		CONTRACT NO. 63428 M-9003 (267)		SCALE: 1"=20'H/2V. SHEET NO. 7 OF 11 SHEETS STA. 34+00 TO STA. 39+25		FED. ROAD DIST. NO. 1 ILLINOIS FED. AID PROJECT M-9003 (267) (BOOK NOS. 1579, 1583, 1589) E.H.E. PROJECT NO. 565-08-29001		

Drawing file: W:\Projects\565082900 - St. Charles Rd\St. Charles Rd\St. Charles Rd.dwg Dec 07, 2008 - 10:17am