

STATE OF ILLINOIS  
DEPARTMENT OF TRANSPORTATION  
DIVISION OF HIGHWAYS

**PLANS FOR PROPOSED  
FEDERAL AID HIGHWAY**

**SANGAMON STREET - WAYNE DR TO NAOMA DR  
EXCHANGE STREET (FAU 1638) - INDEPENDENCE BLVD TO PEORIA AVE  
SIDEWALK CONSTRUCTION / PAVEMENT STRIPING**

**PROJECT NO.: CMM-9003 (077)**

**SECTION NO.: 06-00162-01-SW**

**LEAD LOCAL AGENCY: VILLAGE of LANSING**

**LOCATED IN: VILLAGE of CRETE**

**WILL COUNTY**

**C-91-022-09**

F. A. I. D. NO.	SECTION	COUNTY	TOTAL SHEETS	SHEET NO.
1638	06-00162-01-SW	WILL	17	1
STA.	TO STA.			
FED. ROAD DIST. NO.	ILLINOIS	FED. AID PROJECT	CMM-9003 (077)	

CONTRACT #63435

**INDEX OF SHEETS**

1. COVER SHEET
2. SUMMARY OF QUANTITIES  
TYPICAL CROSS SECTION  
AND GENERAL NOTES
- 3.-4. PLAN SHEET
- 5.-7. IDOT DISTRICT 1 STANDARD DETAILS (BD-01, TC-10 & TC-13)
- 8.-17. CROSS SECTIONS

**HIGHWAY STANDARDS**

- 000001-05 STANDARD SYMBOLS, ABBREVIATIONS AND PATTERNS
- 280001-05 TEMPORARY EROSION CONTROL SYSTEMS
- 424001-05 CURB RAMPS FOR SIDEWALKS
- 606001-04 CONCRETE CURB TYPE B AND  
COMBINATION CONCRETE CURB AND GUTTER
- 701001-02 OFF-ROAD OPERATIONS, 2L, 2W, MORE THAN 15' (4.5m) AWAY
- 701006-03 OFF-ROAD OPERATIONS, 2L, 2W, 15' (4.5m) TO 24"  
(600mm) FROM PAVEMENT EDGE
- 701011-02 OFF-ROAD MOVING OPERATIONS, 2L, 2W, DAY ONLY
- 701301-03 LANE CLOSURE, 2L, 2W, SHORT TIME OPERATIONS
- 701501-05 URBAN LANE CLOSURE, 2L, 2W, UNDIVIDED
- 701502-03 URBAN LANE CLOSURE, 2L, 2W, WITH BI-DIRECTIONAL LEFT TURN LANE
- 701701-06 URBAN LANE CLOSURE, MULTILANE INTERSECTION
- 701801-04 LANE CLOSURE, MULTILANE 1W OR 2W CROSSWALK  
OR SIDEWALK CLOSURE
- 701901-01 TRAFFIC CONTROL DEVICES

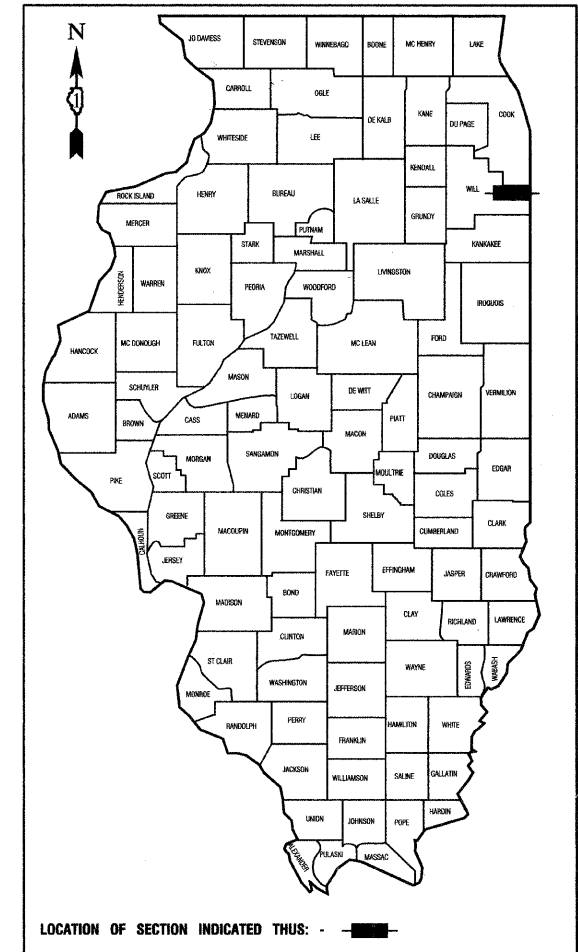

LOCATION OF SECTION INDICATED THIS: - [black rectangle]

STATE OF ILLINOIS DEPARTMENT OF TRANSPORTATION  
DIVISION OF HIGHWAYS

Approved: *Norman F. [Signature]*  
11/30/09  
President, Village of Lansing

Passed: *DECEMBER 3, 2009*  
*C. [Signature]*  
District 1 Engineer of Local Roads & Streets

Released for Bid  
Based on Limited  
Review: *DECEMBER 8, 2009*  
*Diana M. O'Keefe*  
Deputy Director of Highways, Region 7 Engineer

PRINTED BY THE AUTHORITY OF  
THE STATE OF ILLINOIS

PREPARED BY OR UNDER THE  
DIRECT SUPERVISION OF:

*Joseph M. [Signature]*  
11/30/09

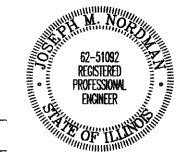

LICENSE EXPIRES: 11/30/11

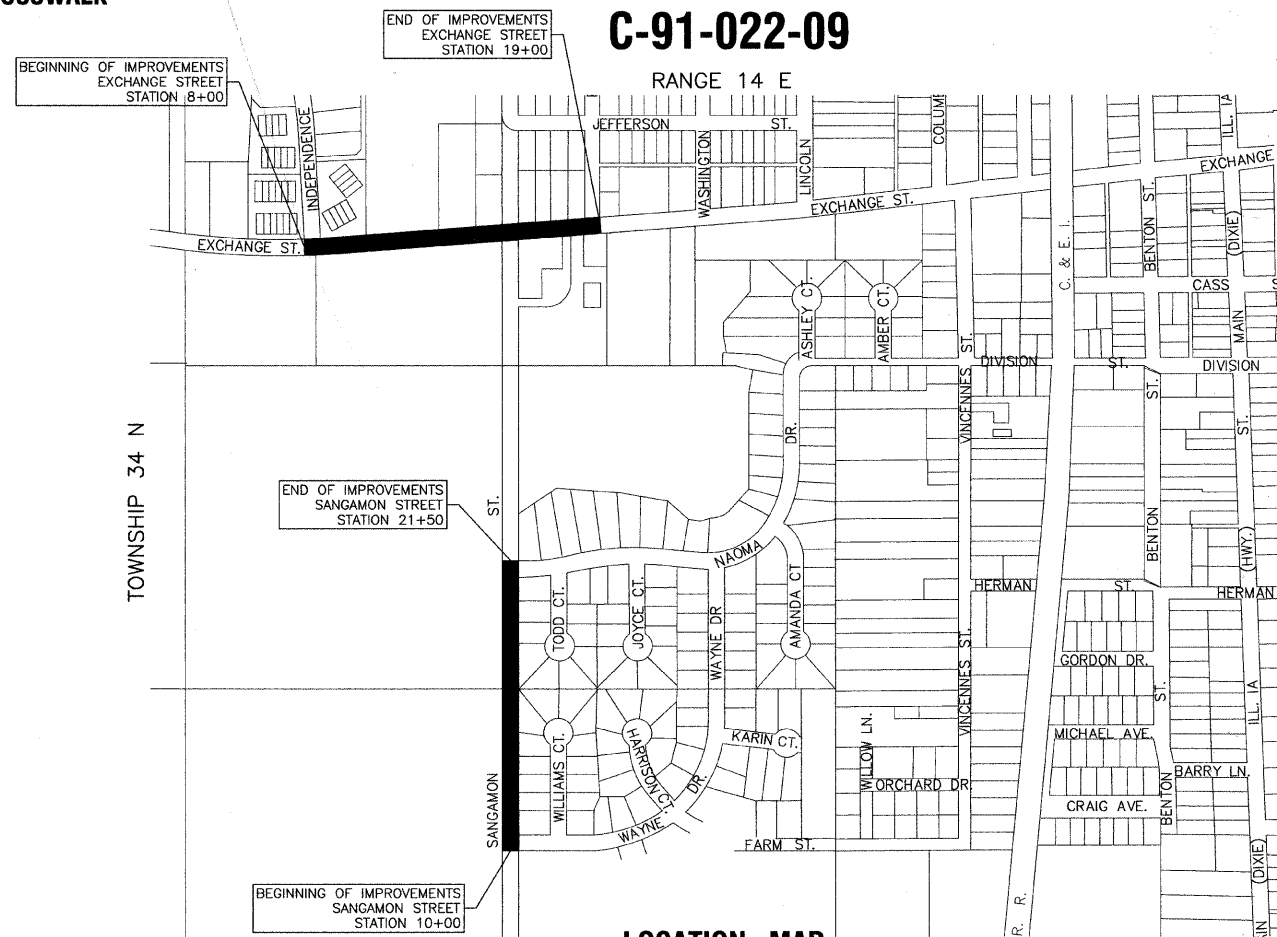

**LOCATION MAP**

GROSS LENGTH=2250.00 FEET=0.43 MILES  
NET LENGTH=2250.00 FEET=0.43 MILES

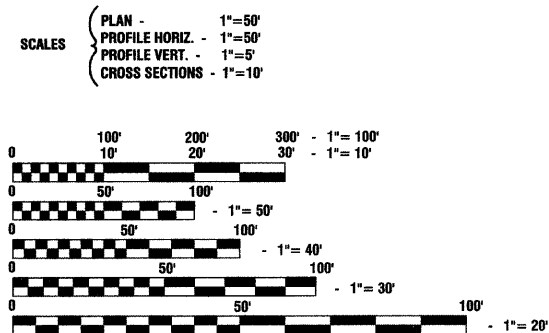

FULL SIZE PLANS HAVE BEEN PREPARED USING STANDARD  
ENGINEERING SCALES, REDUCED SIZED PLANS WILL NOT  
CONFORM TO STANDARD SCALES, IN MAKING MEASUREMENTS  
ON REDUCED PLANS, THE ABOVE SCALES MAY BE USED.

J. U. L. I. E.  
JOINT UTILITY LOCATION INFORMATION FOR EXCAVATION  
1-800-892-0123 or 811

**CONTRACT NO. 63435**

I.D.O.T. FIELD ENGINEER: MELCHOR MANGOBA (847) 705-4408  
CONSULTANTS: ROBINSON ENGINEERING, LTD. 708-331-6700

SUMMARY OF QUANTITIES					PAVEMENT		
S.I.	CODE NO.	PAY ITEM	UNIT	QUAN	CONSTRUCTION TYPE CODE		
					SPY-1B		
	20100110	TREE REMOVAL (6 TO 15 UNITS DIAMETER)	UNIT	18	18		
	20101100	TREE TRUNK PROTECTION	EACH	2	2		
	20101200	TREE ROOT PRUNING	EACH	2	2		
	20101700	SUPPLEMENTAL WATERING	UNIT	1	1		
	20200100	EARTH EXCAVATION	CU YD	550	550		
	25000400	NITROGEN FERTILIZER NUTRIENT	POUND	20	20		
	25000500	PHOSPHORUS FERTILIZER NUTRIENT	POUND	20	20		
	25000600	POTASSIUM FERTILIZER NUTRIENT	POUND	20	20		
	21101615	TOPSOIL FURNISH AND PLACE, 4"	SQ YD	1520	1520		
	21400100	GRADING AND SHAPING DITCHES	FOOT	15	15		
	25200110	SODDING, SALT TOLERANT	SQ YD	1520	1520		
	28000400	PERIMETER EROSION BARRIER	FOOT	2250	2250		
	31101200	SUB-BASE GRANULAR MATERIAL, TYPE B 4"	SQ YD	1182	1182		
	35501308	HOT-MIX ASPHALT BASE COURSE, 6"	SQ YD	49	49		
	40603310	HOT-MIX ASPHALT SURFACE COURSE, MIX "C", N50	TON	6	6		
	42400200	PORTLAND CEMENT CONCRETE SIDEWALK 5 INCH	SQ FT	10244	10244		
	42400400	PORTLAND CEMENT CONCRETE SIDEWALK 7 INCH	SQ FT	390	390		
	42400800	DETECTABLE WARNINGS	SQ FT	88	88		
	44000200	DRIVEWAY PAVEMENT REMOVAL	SQ YD	75	75		
	44000500	COMBINATION CURB AND GUTTER REMOVAL	FOOT	121	121		
	44000600	SIDEWALK REMOVAL	SQ FT	75	75		
	44201749	CLASS D PATCHES, TYPE 1, 9 INCH	SQ YD	16	16		
	60300305	FRAMES AND LIDS TO BE ADJUSTED	EACH	5	5		
	60603800	COMBINATION CONCRETE CURB AND GUTTER, TYPE B-6.12	FOOT	12	12		
	60604400	COMBINATION CONCRETE CURB AND GUTTER, TYPE B-6.18	FOOT	125	125		
	67100100	MOBILIZATION	L SUM	1	1		
	70102620	TRAFFIC CONTROL AND PROTECTION, STANDARD 701501	L SUM	1	1		
	70102622	TRAFFIC CONTROL AND PROTECTION, STANDARD 701502	L SUM	1	1		
	70102635	TRAFFIC CONTROL AND PROTECTION, STANDARD 701701	L SUM	1	1		
	70102640	TRAFFIC CONTROL AND PROTECTION, STANDARD 701801	L SUM	1	1		
*	78000600	THERMOPLASTIC PAVEMENT MARKING - LINE 12"	FOOT	744	744		
	78300100	PAVEMENT MARKING REMOVAL	SQ FT	55	55		
	XX001621	BRICK PAVER REMOVAL	SQ FT	13	13		
	XX007761	BUFFALO BOX ADJUSTMENT, SPECIAL	EACH	1	1		
	X7240505	RELOCATE SIGN PANEL AND POST	EACH	6	6		

\* - INDICATES SPECIALTY ITEMS

HOT-MIX ASPHALT MIXTURE REQUIREMENTS

MIXTURE TYPE	AIR VOIDS
PAVEMENT PATCHING	
CLASS D PATCHES (HMA BINDER IL-19mm)	4% @ 70 Gyr.
DRIVEWAYS	
HOT MIX ASPHALT SURFACE COURSE, MIX "C", N50(IL-9.5mm); 2"	4% @ 50 Gyr.
HOT MIX ASPHALT BASE COURSE, (HMA BINDER IL-19.0mm); 6"	4% @ 50 Gyr.

NOTE:  
THE UNIT WEIGHT USED TO CALCULATE ALL HOT-MIX ASPHALT SURFACE MIXTURE QUANTITIES IS 112 LBS/SY/IN.  
THE "AC-TYPE" FOR POLYMERIZED HMA MIXES SHALL BE "SBS/SBR PG 70-22" AND FOR NON-POLYMERIZED HMA THE "AC-TYPE" SHALL BE "PG 64-22" UNLESS MODIFIED BY DISTRICT ONE SPECIAL PROVISIONS. FOR "PERCENT OF RAP" SEE DISTRICT ONE SPECIAL PROVISIONS.

GENERAL NOTES

- ROBINSON ENGINEERING SHALL BE NOTIFIED TWO (2) WORKING DAYS PRIOR TO CONSTRUCTION. CALL (708) 331-6700.
- THE CONTRACTOR SHALL PROVIDE AND INSTALL TWO (2) WEIGHTED SANDBAGS ON EACH TYPE 1 AND TYPE 2 BARRICADE USED. ONE (1) WEIGHTED SANDBAG SHALL BE INSTALLED ON EACH BOTTOM RAIL.
- THE REMOVAL OF ANY DRIVEWAYS, PAVEMENT, CURB, ETC. SHALL BE ACCOMPLISHED BY MEANS OF A SAW CUT JOINT, AT THE DIRECTION OF THE ENGINEER. THIS WORK SHALL NOT BE PAID FOR SEPARATELY, BUT SHALL BE INCLUDED IN THE UNIT PRICE BID FOR THE VARIOUS REMOVAL ITEMS.
- WHEN, IN THE CONSTRUCTION OPERATION, ANY LOOSE MATERIAL IS DEPOSITED IN THE FLOW LINE OF DITCHES, GUTTERS OR OTHER DRAINAGE STRUCTURES SO THAT THE NATURAL FLOW OF WATER IS OBSTRUCTED, IT SHALL BE REMOVED AT THE CLOSE OF EACH DAY BY THE CONTRACTOR AT HIS EXPENSE. AT THE CONCLUSION OF THE CONSTRUCTION OPERATIONS, ALL DRAINAGE STRUCTURES SHALL BE FREE FROM ALL DIRT AND DEBRIS. THIS WORK SHALL NOT BE PAID FOR SEPARATELY BUT SHALL BE INCLUDED IN THE COST OF THE CONTRACT.
- BEFORE STARTING ANY EXCAVATION, THE CONTRACTOR SHALL CALL J.U.L.I.E. AT (800) 892-0123 FOR FIELD LOCATIONS OF BURIED ELECTRIC, COMMUNICATIONS, AND GAS UTILITIES. (48 HOUR NOTIFICATION REQUIRED.)
- IT SHALL BE THE CONTRACTORS RESPONSIBILITY TO VERIFY ALL DIMENSIONS AND CONDITIONS EXISTING IN THE FIELD PRIOR TO CONSTRUCTION AND ORDERING OF MATERIALS.
- AREAS DISTURBED BY CONSTRUCTION SHALL BE KEPT TO A MINIMUM. ALL AREAS DISTURBED WHICH WERE NOT SCHEDULED FOR REPAIR OR REPLACEMENT SHALL BE RESTORED AT THE CONTRACTORS EXPENSE.
- UTILITIES INDICATED ON THE PLANS ARE PROVIDED FOR THE CONTRACTORS USE AND ARE BASED UPON INFORMATION AVAILABLE AT THE TIME OF THE ADVERTISEMENT FOR BIDS. THE OWNER AND ENGINEER DO NOT GUARANTEE THE ACCURACY OF THE UTILITY INFORMATION.
- ITEMS OF WORK LISTED IN THE SUMMARY OF QUANTITIES NOT SPECIFICALLY CALLED OUT ON THE PLANS SHALL BE PERFORMED AS DIRECTED BY THE ENGINEER.
- ANY REFERENCE TO THE STANDARDS THROUGHOUT THE PLANS OR SPECIAL PROVISIONS SHALL BE INTERPRETED TO BE THE LATEST STANDARDS OF THE ILLINOIS DEPARTMENT OF TRANSPORTATION.
- THE APPROXIMATE LOCATION OF KNOWN PUBLIC UTILITIES ARE SHOWN ON THE PLANS. HOWEVER, THE DEPARTMENT DOES NOT GUARANTEE ITS ACCURACY. PRIOR TO COMMENCING OPERATIONS ON THE PROJECT WHICH MAY IN ANY WAY CREATE THE POSSIBILITY OF INVOLVEMENT WITH EXISTING UTILITIES, THE CONTRACTOR SHALL CONTACT THE FIRM (OR COMMUNITY) INVOLVED. ADJUSTMENT OF ALL PUBLIC UTILITIES WITHIN THE LIMITS OF THIS IMPROVEMENT WILL BE DONE BY THE RESPECTIVE OWNERS. NO ADDITIONAL COMPENSATION WILL BE ALLOWED DUE TO DELAYS OR INCONVENIENCE CAUSED BY THESE ADJUSTMENTS. IT SHALL BE THE CONTRACTOR'S RESPONSIBILITY TO VERIFY LOCATIONS OF UNDERGROUND INSTALLATION BEFORE STARTING CONSTRUCTION OPERATIONS.
- THE CONTRACTOR SHALL COORDINATE CONSTRUCTION ACTIVITIES WITH UTILITY COMPANIES.
- CONTRACTOR SHALL BE RESPONSIBLE AT ALL TIMES FOR TRAFFIC CONTROL AND PROTECTION IN ACCORDANCE WITH THE LATEST IDOT STANDARD SPECIFICATIONS ADOPTED, THE LATEST EDITION OF THE ILLINOIS MANUAL ON UNIFORM TRAFFIC CONTROL DEVICES FOR STREETS AND HIGHWAYS.
- THE CONTRACTOR SHALL MAINTAIN ACCESS TO ALL DRIVEWAYS THROUGHOUT THE CONSTRUCTION LIMITS AT ALL TIMES. IF DRIVEWAY ACCESS MUST BE RESTRICTED, THE CONTRACTOR SHALL NOTIFY THE RESIDENT/PROPERTY OWNER IN WRITING 24 HOURS IN ADVANCE.
- SIDEWALK SLOPES SHALL NOT EXCEED A 2% CROSS SLOPE, 5% LONGITUDINAL SLOPE.

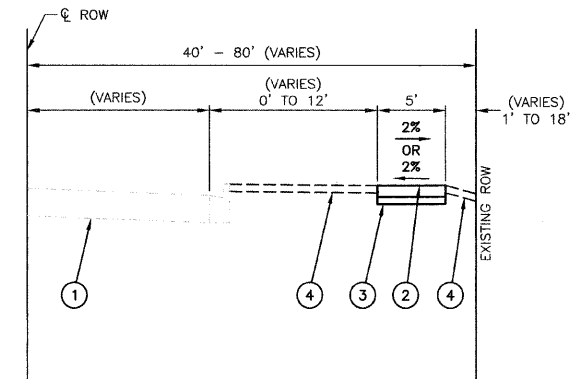

PROPOSED TYPICAL CROSS SECTION

PROPOSED LEGEND

- ① EXISTING ROADWAY TO REMAIN
- ② PROPOSED P.C.C. SIDEWALK, 5"
- ③ PROPOSED SUB-BASE GRANULAR MATERIAL, TYPE B 4"
- ④ PROPOSED TOPSOIL, FURNISH AND PLACE, 4" FERTILIZER NUTRIENTS (NITROGEN, PHOSPHORUS, POTASSIUM) SODDING, SALT TOLERANT

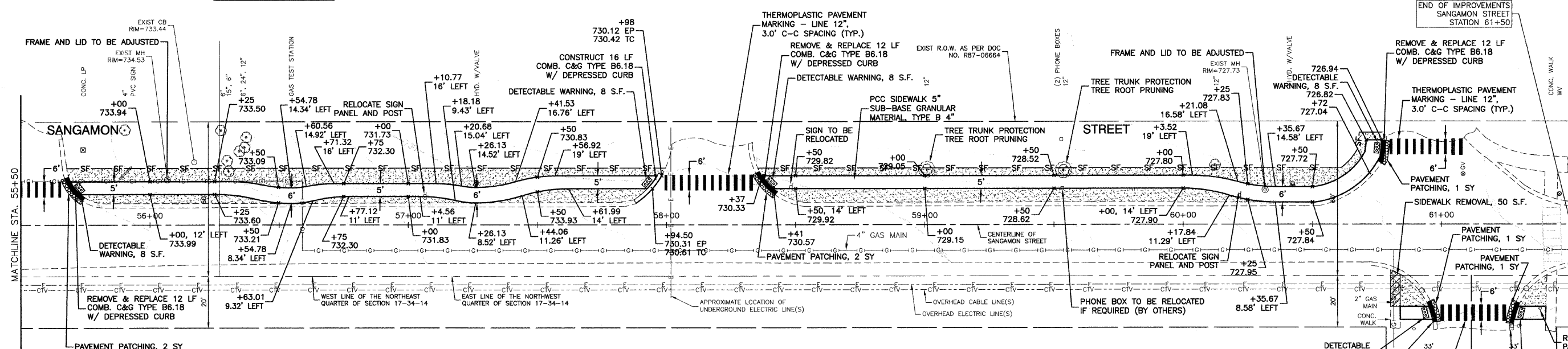
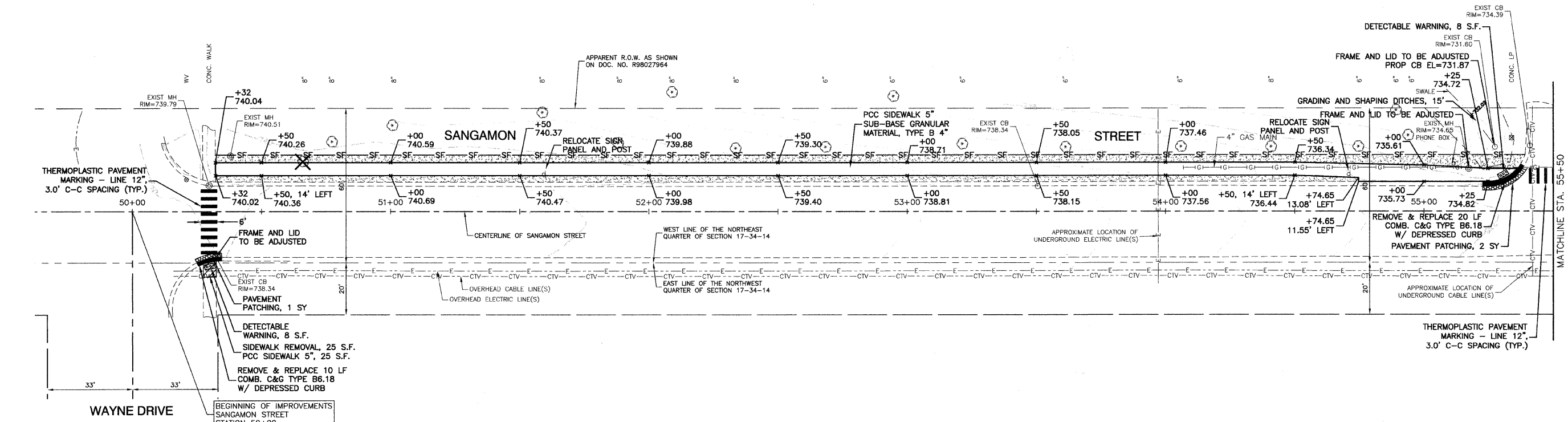
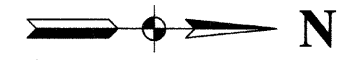

**LEGEND**

- |  |   |
|--|---|
|  | PROPOSED PCC SIDEWALK 5\"/>                       |
|  | TOPSOIL, FURNISH AND PLACE, 4\"/>                 |
|  | COMBINATION CURB AND GUTTER REMOVAL               |
|  | COMBINATION CONCRETE CURB AND GUTTER, TYPE B-6.12 |
|  | COMBINATION CONCRETE CURB AND GUTTER, TYPE B-6.18 |
|  | TREE REMOVAL                                      |
|  | PERIMETER EROSION BARRIER                         |
|  | DRIVEWAY PAVEMENT REMOVAL                         |
|  | CLASS D PATCHES, TYPE 1, 9\"/>                    |
|  | TREE REMOVAL                                      |
|  | DETECTABLE WARNING                                |
|  | SIDEWALK REMOVAL                                  |
|  | BRICK PAVER REMOVAL                               |

**NOTES**

- SIDEWALK WIDTHS TO BE 5' UNLESS STATED OTHERWISE.
- OFFSETS ARE TAKEN FROM THE CENTERLINE OF SANGAMON STREET.
- PROPOSED SIDEWALK SHALL BE 5" DEPTH EXCEPT DRIVEWAY LOCATIONS SHALL BE 7" DEPTH AS INDICATED IN THE PLANS.

FILE NAME = 06912_01-PLAN-01 - SANGAMON	USER NAME =	DESIGNED = JN/MN	REVISED =
		CHECKED = JN/MN	REVISED =
PLOT SCALE =	DRAWN = KWM	REVISED =	
PLOT DATE = 12-01-09	CHECKED = KWM	REVISED =	

STATE OF ILLINOIS  
DEPARTMENT OF TRANSPORTATION

EXCHANGE ST. AND SANGAMON ST. SOUTHLAND SAFE ROUTE TO SCHOOL PROGRAM PLAN SHEET		F.A.U. RTE 1638	SECTION 06-00162-01-SW	COUNTY WILL	TOTAL SHEETS 17	SHEET NO. 3
SCALE: 1"=20'		SHEET NO. 3 OF 17 SHEETS		STA. TO STA.	CONTRACT NO. 63435	
		FED. ROAD DIST. NO. 1		ILLINOIS	FED. AID PROJECT CMM-9003 (077)	

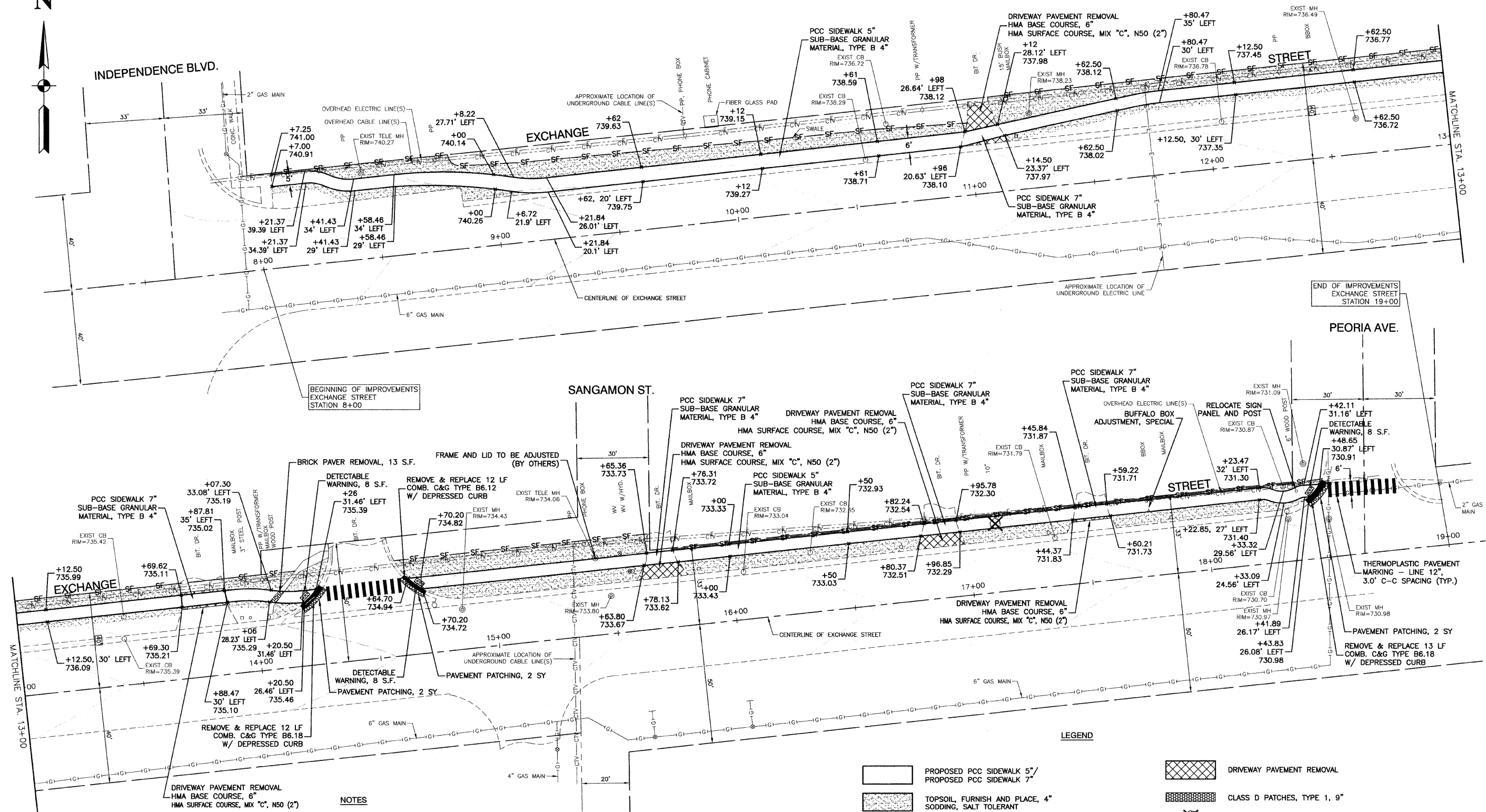

- NOTES**
1. SIDEWALK WIDTHS TO BE 5' UNLESS STATED OTHERWISE.
  2. OFFSETS ARE TAKEN FROM THE CENTERLINE OF EXCHANGE STREET.
  3. PROPOSED SIDEWALK SHALL BE 5" DEPTH EXCEPT DRIVEWAY LOCATIONS SHALL BE 7" DEPTH AS INDICATED IN THE PLANS.

**LEGEND**

	PROPOSED PCC SIDEWALK 5"/PROPOSED PCC SIDEWALK 7"		DRIVEWAY PAVEMENT REMOVAL
	TOPSOIL, FURNISH AND PLACE, 4" SODDING, SALT TOLERANT		CLASS D PATCHES, TYPE 1, 9"
	COMBINATION CURB AND GUTTER REMOVAL		TREE REMOVAL
	COMBINATION CONCRETE CURB AND GUTTER, TYPE B-6.12		DETECTABLE WARNING
	COMBINATION CONCRETE CURB AND GUTTER, TYPE B-6.18		SIDEWALK REMOVAL
	TREE REMOVAL		BRICK PAVER REMOVAL
	PERIMETER EROSION BARRIER		

FILE NAME = 05612_01_PLAN 01 - EXCHANGE	USER NAME =	DESIGNED = JN/MN	REVISED =
		CHECKED = JN/MN	REVISED =
PLOT SCALE =		DRAWN = KWM	REVISED =
PLOT DATE = 12-01-09		CHECKED = KWM	REVISED =

**STATE OF ILLINOIS**  
**DEPARTMENT OF TRANSPORTATION**

EXCHANGE ST. AND SANGAMON ST.  
SOUTHLAND SAFE ROUTE TO SCHOOL PROGRAM  
PLAN SHEET

SCALE: 1"=20'    SHEET NO. 4 OF 17 SHEETS    STA. TO STA.

F.A.U. RTE. 1638	SECTION 06-00162-01-SW	COUNTY WILL	TOTAL SHEETS 17	SHEET NO. 4
FED. ROAD DIST. NO. 1 ILLINOIS		FED. AID PROJECT CMM-9003 (077)		
CONTRACT NO. 63435				

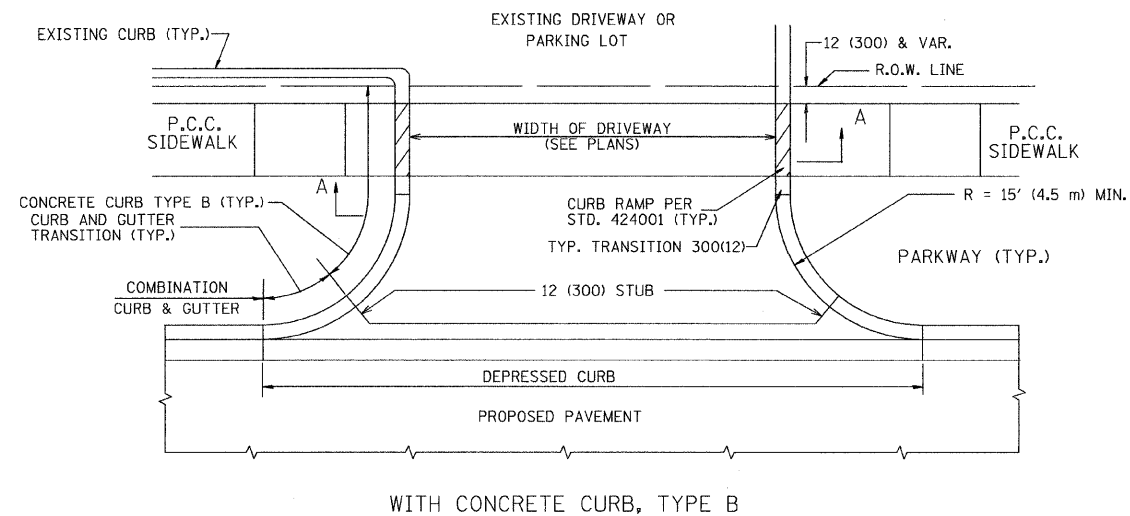

WITH CONCRETE CURB, TYPE B

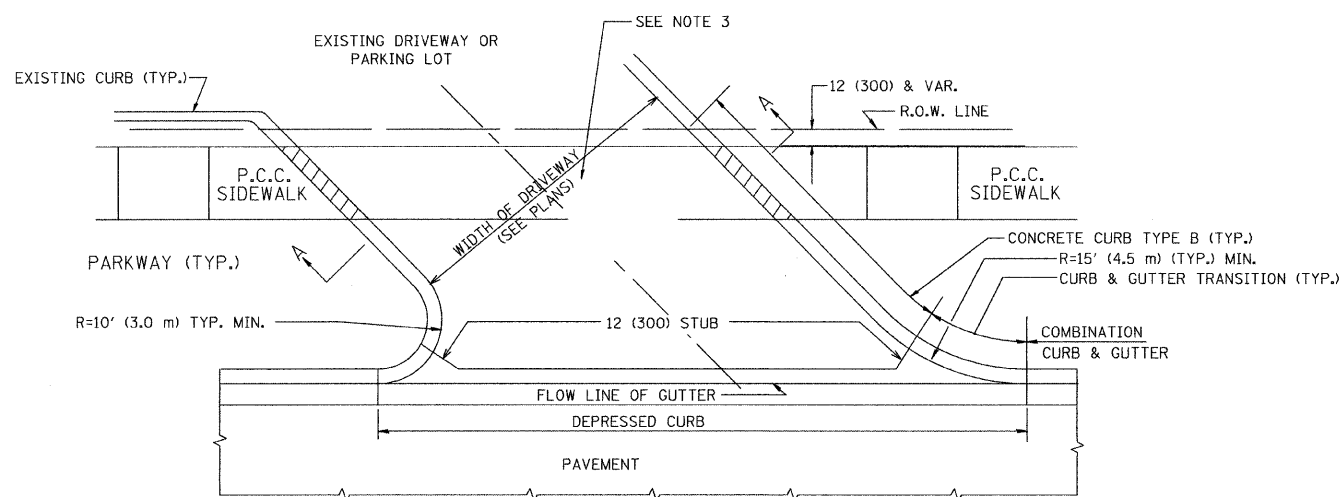

WITH CONCRETE CURB, TYPE B

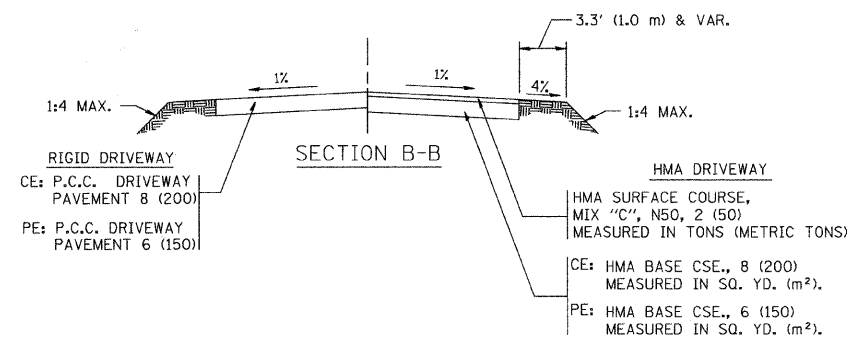
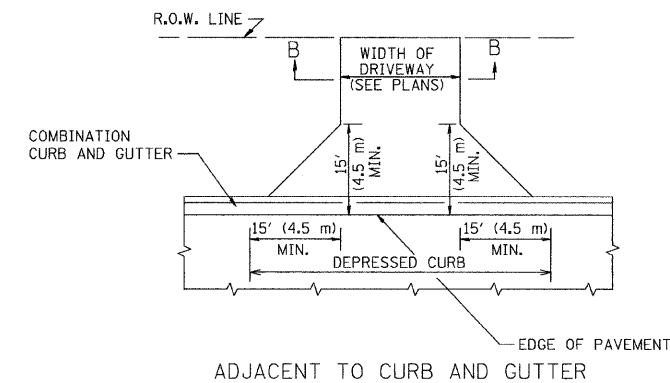
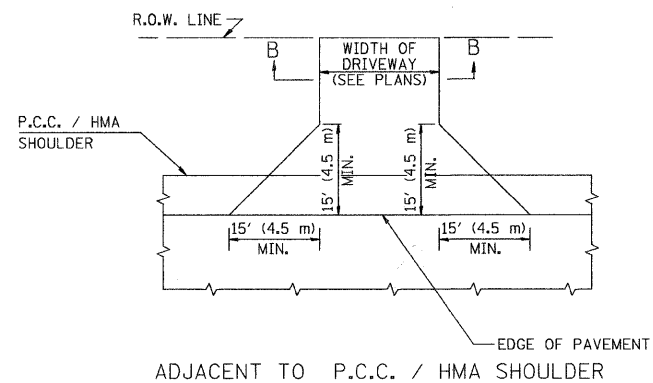
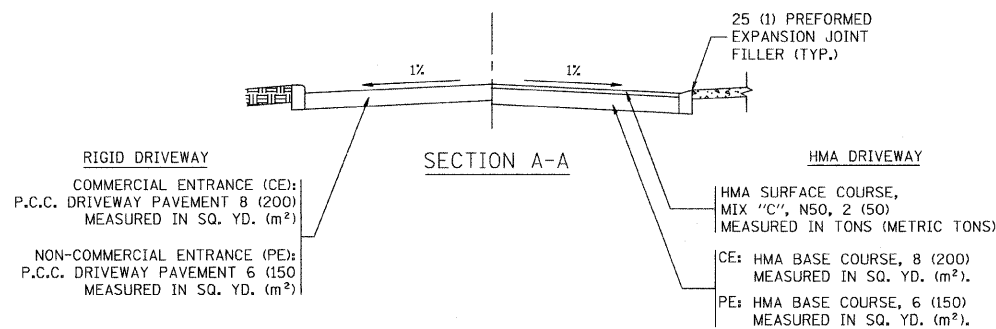

GENERAL NOTES:

DRIVEWAY SLOPES, LOCATIONS, & GEOMETRIC LAYOUT SHALL BE IN ACCORDANCE WITH THE LATEST EDITION OF THE "HANDBOOK FOR POLICY ON PERMITS FOR ACCESS DRIVEWAYS TO STATE HIGHWAYS". FOR FURTHER LAYOUT REQUIREMENTS, REFER TO ILLUSTRATIONS IN THE PERMIT HANDBOOK. DRIVEWAYS SHALL BE REPLACED IN KIND, UNLESS OTHERWISE NOTED ON THE PLANS.

COMMERCIAL DRIVEWAYS SHALL BE CONSTRUCTED WITH CONCRETE CURB, TYPE B RETURNS EXCEPT WHEN THE SIDEWALK EDGE IS 4 FEET (1.2 METERS) OR LESS FROM THE BACK OF CURB, CONSTRUCT A FLARE DRIVEWAY WITHOUT CURB.

THE RESIDENT ENGINEER SHALL CONTACT THE TRAFFIC PERMIT OFFICE AT 847/ 705-4131 FOR ANY QUESTIONS ON DRIVEWAYS SHOWN IN THE PLANS; SPECIFICALLY IN REFERENCE TO ADDITIONAL AND/OR RELOCATION/REMOVAL OF A DRIVEWAY.

COMBINATION CONCRETE CURB & GUTTER SHALL BE MEASURED STRAIGHT ACROSS THE DRIVEWAY. NO ADDITIONAL COMPENSATION WILL BE ALLOWED FOR THE CURB & GUTTER TRANSITION.

1 (25) PREFORMED EXPANSION JOINT FILLER WILL NOT BE PAID SEPARATELY, BUT SHALL BE CONSIDERED INCLUDED IN THE COST OF THE P.C.C. DRIVEWAY PAVEMENT OR P.C.C. SIDEWALK.

WHEN THE P.C.C. SIDEWALK EXTENDS THROUGH THE DRIVEWAY, THE THICKNESS OF THE SIDEWALK IN THE DRIVEWAY AREA SHALL BE THE SAME AS THE DRIVEWAY THICKNESS. SIDEWALK WILL BE PAID FOR AS P.C.C. SIDEWALK OF THE THICKNESS SPECIFIED. SIDEWALK CROSS SLOPE THRU DRIVEWAY AREA TO BE A MAXIMUM OF 1:50.

FILE NAME = 05912\_01-DTL9-03 - BD-01

USER NAME = bauerdl  
PLOT SCALE = 49.9999' / IN.  
PLOT DATE = 6/12/2008

DESIGNED - R. SHAH  
CHECKED -  
DRAWN -  
CHECKED - 11-04-95

REVISED - M. GOMEZ 04-06-01  
REVISED - P. LofLUER 04-15-03  
REVISED - R. BORO 01-01-07  
REVISED - R. BORO 06-11-08

STATE OF ILLINOIS  
DEPARTMENT OF TRANSPORTATION

DRIVEWAY DETAILS - DISTANCE BETWEEN R.O.W.  
AND FACE OF CURB & EDGE OF SHOULDER >= 15' (4.5 m)  
SCALE: SHEET NO. 5 OF 17 SHEETS STA. TO STA.

F.A.U. RTE.	SECTION	COUNTY	TOTAL SHEETS	SHEET NO.
1638	06-00162-01-SW	WILL	17	5
BD0156-07 (BD-01)			CONTRACT NO. 63435	
FED. ROAD DIST. NO. 1 ILLINOIS FED. AID PROJECT CMM-9003 (077)				

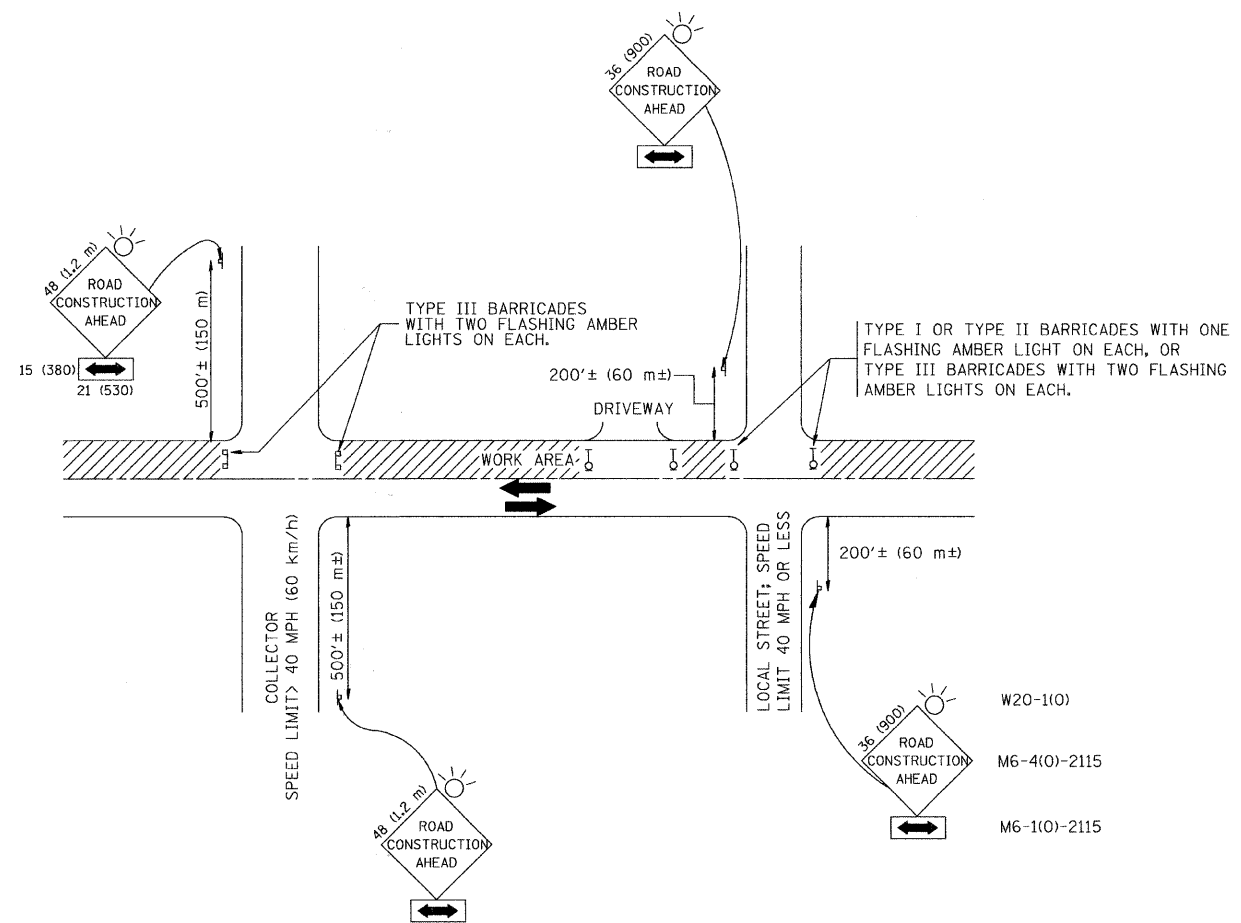

TRAFFIC CONTROL AND PROTECTION FOR SIDE ROADS, INTERSECTIONS, AND DRIVEWAYS

NOTES:

- A. FOR NO LANE RESTRICTION ON THE SIDE ROAD OR DRIVEWAYS
  1. SIDE ROAD WITH A SPEED LIMIT OF 40 MPH (60 km/h) OR LESS AS SHOWN ON THE DRAWING AND AS DIRECTED BY THE ENGINEER:
    - a) ONE **ROAD CONSTRUCTION AHEAD** SIGN 36 x 36 (900x900) WITH A FLASHER AND FLAG MOUNTED ON IT APPROXIMATELY 200' (60 m) IN ADVANCE OF THE MAIN ROUTE.
    - b) THE CLOSED PORTION OF THE MAIN ROUTE SHALL BE PROTECTED BY BLOCKING WITH TYPE I, TYPE II OR TYPE III BARRICADES, 1/3 OF THE CROSS SECTION OF THE CLOSED PORTION.
  2. SIDE ROAD WITH A SPEED LIMIT GREATER THAN 40 MPH (60 km/h) AS SHOWN ON THE DRAWING AND AS DIRECTED BY THE ENGINEER:
    - a) ONE **ROAD CONSTRUCTION AHEAD** SIGN 48 x 48 (1.2 m x 1.2 m) WITH A FLASHER MOUNTED ON IT APPROXIMATELY 500' (150 m) IN ADVANCE OF THE MAIN ROUTE.
    - b) THE CLOSED PORTION OF THE MAIN ROUTE SHALL BE PROTECTED BY BLOCKING WITH TYPE III BARRICADES, 1/2 OF THE CROSS SECTION OF THE CLOSED PORTION.
  3. WHEN THE SIDE ROAD LIES BETWEEN THE BEGINNING OF THE MAINLINE SIGNING AND THE WORK ZONE, A SINGLE HEADED ARROW (M6-1) SHALL BE USED IN LIEU OF THE DOUBLE HEADED ARROW (M6-4).
- B. FOR A LANE CLOSURE ON A SIDE ROAD OR DRIVEWAY:
 

USE APPLICABLE PORTIONS OF THE TYPICAL APPLICATION OF TRAFFIC CONTROL DEVICES (STD. 701501, STD. 701606 OR THE APPROPRIATE STANDARD). THE SPACING OF SIGNS AND BARRICADES SHALL BE ADJUSTED FOR FIELD CONDITIONS AS DIRECTED BY THE ENGINEER. THE DIRECTIONAL ARROW SHALL BE COVERED OR REMOVED WHEN NO LONGER CONSISTENT WITH THE SIDE ROAD LANE CLOSURE.
- C. ADVANCE WARNING SIGNS ARE TO BE OMITTED ON DRIVEWAY UNLESS OTHERWISE NOTED.
- D. THE TRAFFIC CONTROL AND PROTECTION FOR SIDE ROADS, INTERSECTIONS, AND DRIVEWAYS SHALL BE INCIDENTAL TO THE COST OF SPECIFIED TRAFFIC CONTROL STANDARDS OR ITEMS.

All dimensions are in millimeters (inches) unless otherwise shown.

FILE NAME = 05612_01-DTLS-01 - TC-10	USER NAME = gegl.enobt	DESIGNED — LHA	REVISED — J. OBERLE 10-18-95
		CHECKED —	REVISED — A. HOUSEH 03-06-96
	PLOT SCALE = 50.000 / IN.	DRAWN —	REVISED — A. HOUSEH 10-15-96
	PLOT DATE = 1/4/2008	CHECKED — 06-89	REVISED — T. RAMMACHER 01-06-00

STATE OF ILLINOIS  
DEPARTMENT OF TRANSPORTATION

TRAFFIC CONTROL AND PROTECTION FOR SIDE ROADS, INTERSECTIONS, AND DRIVEWAYS		F.A.U. RTE.	SECTION	COUNTY	TOTAL SHEETS	SHEET NO.
		1638	06-00162-01-SW	WILL	17	6
SCALE:		SHEET NO. 6 OF 17 SHEETS		STA.	TO STA.	
		FED. ROAD DIST. NO. 1	ILLINOIS	FED. AID PROJECT	CMM-9003 (077)	

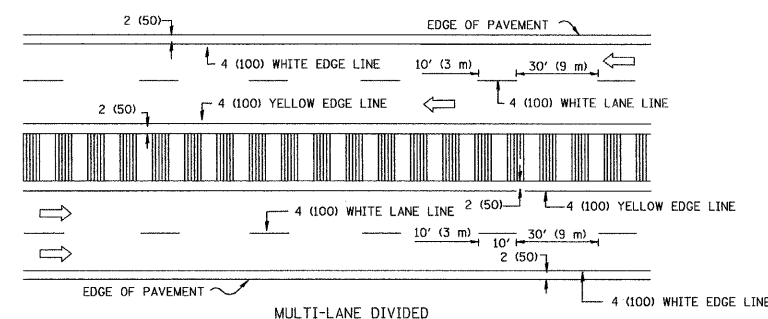
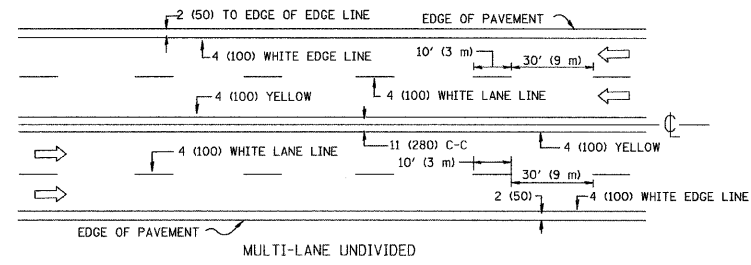
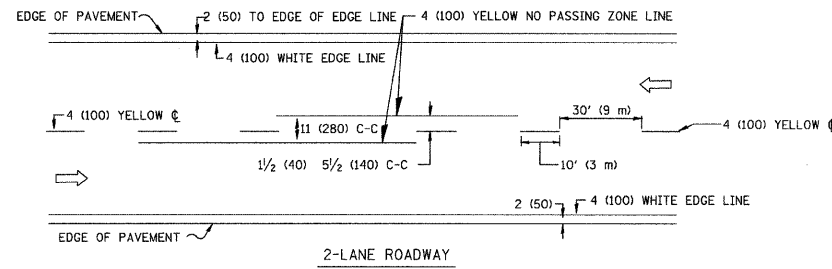

NOTE: MEDIANS WITH BARRIER CURB DO NOT REQUIRE AN EDGE LINE

TYPICAL LANE AND EDGE LINE MARKING

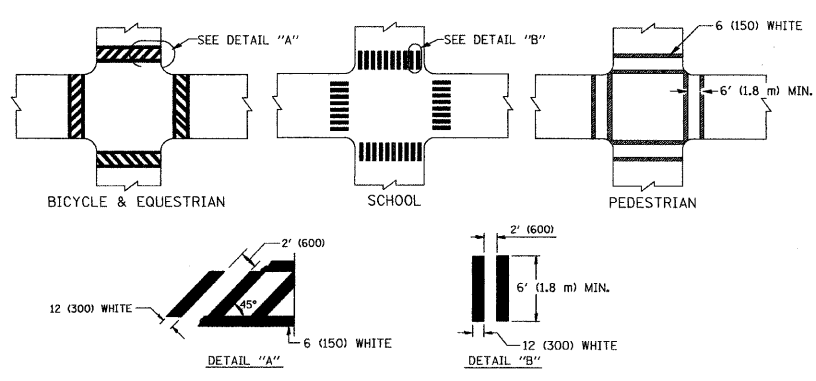

TYPICAL CROSSWALK MARKING

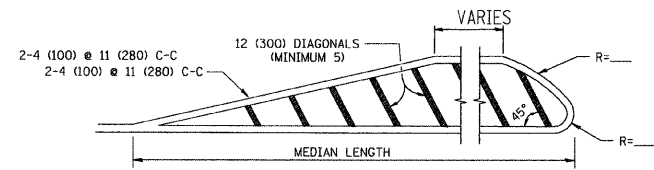
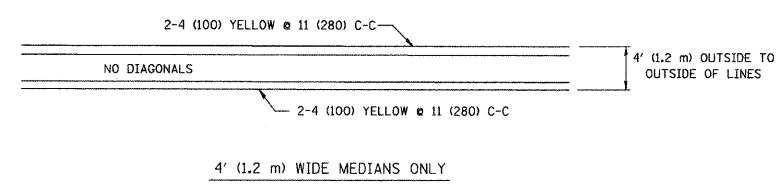

FOR MEDIAN LENGTHS WHERE DIAGONAL SPACING CANNOT BE ATTAINED, USE 5 (FIVE) EQUALLY SPACED DIAGONAL LINES.  
 DIAGONAL LINE SPACING: 50' (15 m) C-C (LESS THAN 30MPH (50 km/h))  
 75' (25 m) C-C 30MPH (50 km/h) TO 45MPH (70 km/h)  
 150' (45 m) C-C (MORE THAN 45MPH (70 km/h))

MEDIANS OVER 4' (1.2 m) WIDE

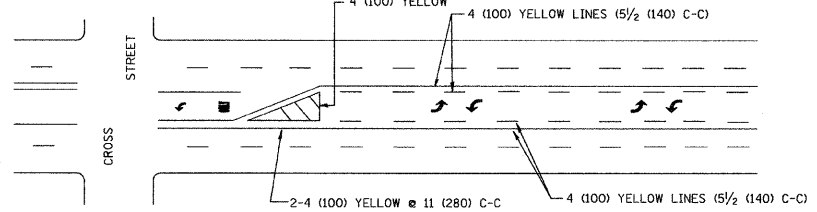

A MINIMUM OF TWO PAIRS OF TURN ARROWS SHALL BE USED, WHITE IN COLOR. ADDITIONAL PAIRS SHALL BE PLACED AT 200' (60 m) TO 300' (90 m) INTERVALS.

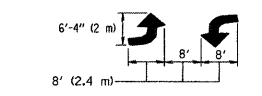

MEDIAN WITH TWO-WAY LEFT TURN LANE

TYPICAL PAINTED MEDIAN MARKING

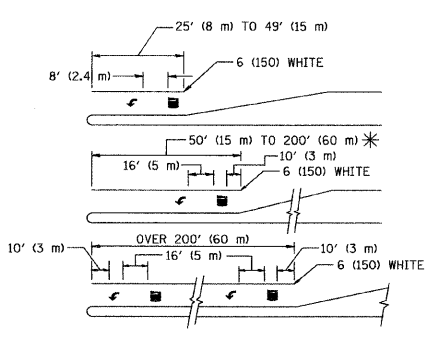

FULL SIZE LETTERS 8' (2.4 m) AND ARROWS SHALL BE USED.  
 \* AREA = 15.6 SQ. FT. (1.5 m<sup>2</sup>) ONLY AREA = 20.8 SQ. FT. (1.9 m<sup>2</sup>)  
 \* TURN LANES IN EXCESS OF 400' (120 m) IN LENGTH MAY HAVE AN ADDITIONAL SET OF ARROW - "ONLY" INSTALLED MIDWAY BETWEEN THE OTHER TWO SETS OF ARROW - "ONLY".

TYPICAL LEFT (OR RIGHT) TURN LANE

TYPICAL TURN LANE MARKING

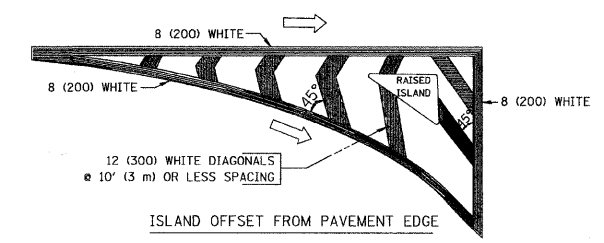

ISLAND OFFSET FROM PAVEMENT EDGE

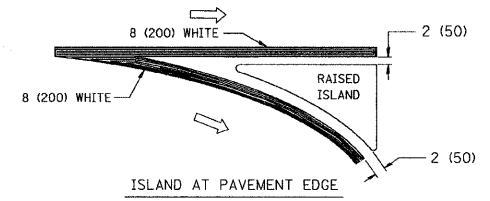

ISLAND AT PAVEMENT EDGE

TYPICAL ISLAND MARKING

TYPE OF MARKING	WIDTH OF LINE	PATTERN	COLOR	SPACING / REMARKS
CENTERLINE ON 2 LANE PAVEMENT	4 (100)	SKIP-DASH	YELLOW	10' (3 m) LINE WITH 30' (9 m) SPACE
CENTERLINE ON MULTI-LANE UNDIVIDED PAVEMENT	2 @ 4 (100)	SOLID	YELLOW	11 (280) C-C
NO PASSING ZONE LINES: FOR ONE DIRECTION	4 (100)	SOLID	YELLOW	5 1/2 (140) C-C FROM SKIP-DASH CENTERLINE
NO PASSING ZONE LINES: FOR BOTH DIRECTIONS	2 @ 4 (100)	SOLID	YELLOW	11 (280) C-C OMIT SKIP-DASH CENTERLINE BETWEEN
LANE LINES	4 (100)	SKIP-DASH	WHITE	10' (3 m) LINE WITH 30' (9 m) SPACE
LANE LINES	5 (125) ON FREEWAYS	SKIP-DASH	WHITE	
DOTTED LINES (EXTENSIONS OF CENTER, LANE OR TURN LANE MARKINGS)	SAME AS LINE BEING EXTENDED	SKIP-DASH	SAME AS LINE BEING EXTENDED	2' (600) LINE WITH 6' (1.8 m) SPACE
EDGE LINES	4 (100)	SOLID	YELLOW-LEFT WHITE-RIGHT	OUTLINE MOUNTABLE MEDIANS IN YELLOW; EDGE LINES ARE NOT USED NEXT TO BARRIER CURB
TURN LANE MARKINGS	6 (150) LINE; FULL SIZE LETTERS & SYMBOLS (8' (2.4m))	SOLID	WHITE	SEE TYPICAL TURN LANE MARKING DETAIL
TWO WAY LEFT TURN MARKING	2 @ 4 (100) EACH DIRECTION	SKIP-DASH AND SOLID	YELLOW	10' (3 m) LINE WITH 30' (9 m) SPACE FOR SKIP-DASH; 5 1/2 (140) C-C BETWEEN SOLID LINE AND SKIP-DASH LINE
TWO WAY LEFT TURN MARKING	8' (2.4m) LEFT ARROW	IN PAIRS	WHITE	SEE TYPICAL TWO-WAY LEFT TURN MARKING DETAIL
CROSSWALK LINES (PEDESTRIAN) A. DIAGONALS (BIKE & EQUESTRIAN) B. LONGITUDINAL BARS (SCHOOL)	2 @ 6 (150) 12 (300) @ 45° 12 (300) @ 90°	SOLID SOLID SOLID	WHITE WHITE WHITE	NOT LESS THAN 6' (1.8 m) APART 2' (600) APART SEE TYPICAL CROSSWALK MARKING DETAILS.
STOP LINES	24 (600)	SOLID	WHITE	PLACE 4' (1.2 m) IN ADVANCE OF AND PARALLEL TO CROSSWALK, IF PRESENT. OTHERWISE, PLACE AT DESIRED STOPPING POINT. PARALLEL TO CROSSROAD CENTERLINE, WHERE POSSIBLE
PAINTED MEDIANS	2 @ 4 (100) WITH 12 (300) DIAGONALS @ 45° NO DIAGONALS USED FOR 4' (1.2 m) WIDE MEDIANS	SOLID	YELLOW: TWO WAY TRAFFIC WHITE: ONE WAY TRAFFIC	11 (280) C-C FOR THE DOUBLE LINE SEE TYPICAL PAINTED MEDIAN MARKING.
GORE MARKING AND CHANNELIZING LINES	8 (200) WITH 12 (300) DIAGONALS @ 45°	SOLID	WHITE	DIAGONALS: 15' (4.5 m) C-C (LESS THAN 30MPH (50 km/h)) 20' (6 m) C-C 30MPH (50 km/h) TO 45MPH (70 km/h) 30' (9 m) C-C (OVER 45MPH (70 km/h))
RAILROAD CROSSING	24 (600) TRANSVERSE LINES; "RR" IS 6' (1.8 m) LETTERS; 16 (400) LINE FOR "X"	SOLID	WHITE	SEE STATE STANDARD 780001 AREA OF: "R"=3.6 SQ. FT. (0.33 m <sup>2</sup> ) EACH "X"=54.0 SQ. FT. (5.0 m <sup>2</sup> )
SHOULDER DIAGONALS	12 (300) @ 45°	SOLID	WHITE - RIGHT YELLOW - LEFT	50' (15 m) C-C (LESS THAN 30MPH (50 km/h)) 75' (25 m) C-C (30 MPH (50 km/h) TO 45MPH (70 km/h)) 150' (45 m) C-C (OVER 45MPH (70 km/h))

FOR FURTHER DETAILS ON PAVEMENT MARKING REFER TO STANDARD SPECIFICATIONS FOR ROAD AND BRIDGE CONSTRUCTION AND STATE STANDARD 780001.

All dimensions are in inches (millimeters) unless otherwise shown.

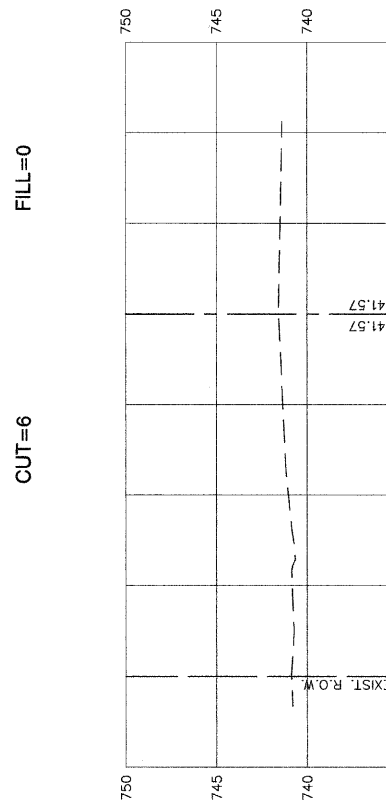
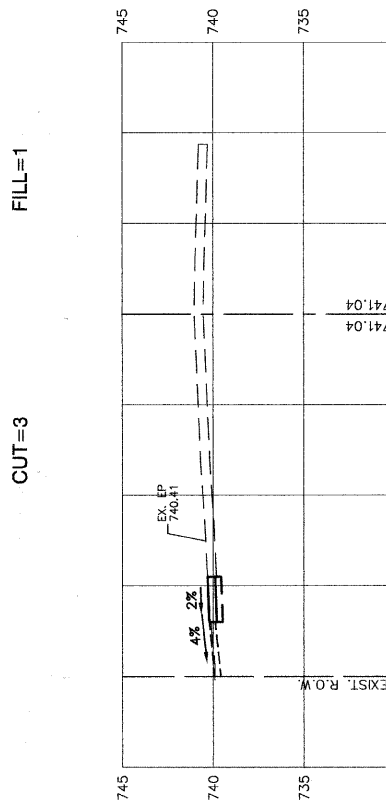
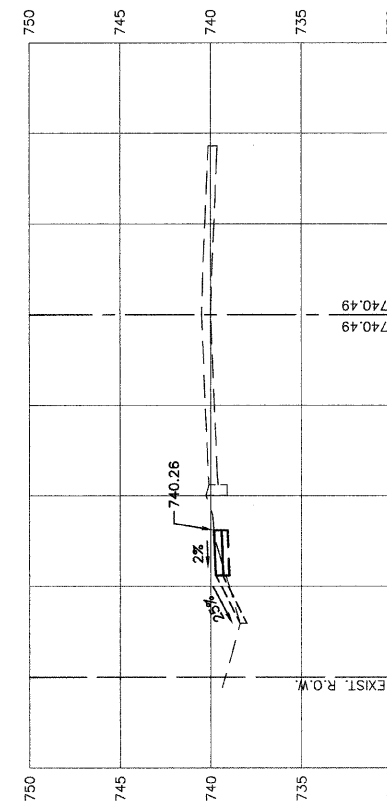
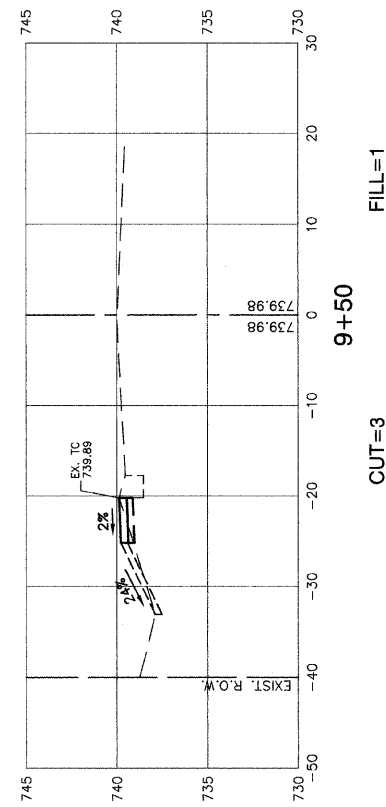
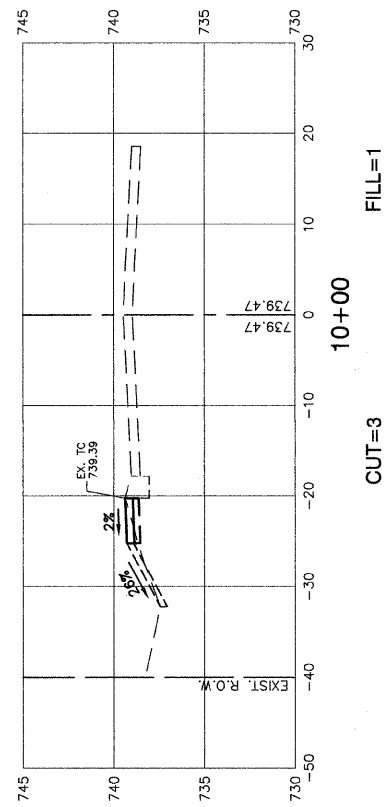
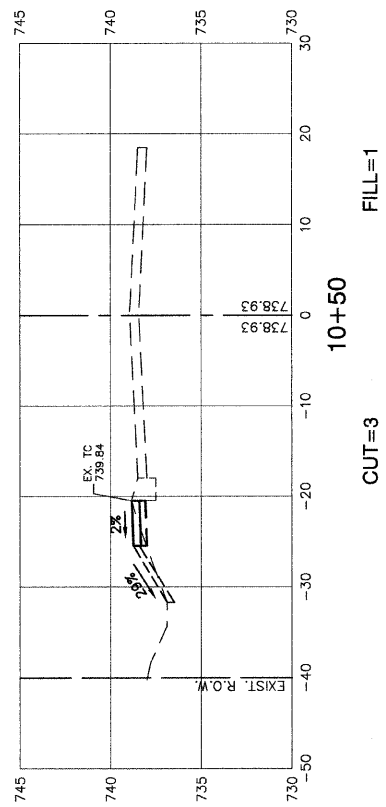

FILE NAME = 05612\_01.XSCT-01

USER NAME =	DESIGNED -- JN/MN	REVISED --
	CHECKED -- JN/MN	REVISED --
PLOT SCALE =	DRAWN -- KWM	REVISED --
PLOT DATE = 12-01-09	CHECKED -- KWM	REVISED --

STATE OF ILLINOIS  
DEPARTMENT OF TRANSPORTATION

EXCHANGE ST. AND SANGAMON ST.  
SOUTHLAND SAFE ROUTE TO SCHOOL PROGRAM  
CROSS SECTIONS  
SCALE: H 1"=10' V 1"=5' SHEET NO. 8 OF 17 SHEETS STA. 8+00 TO STA. 10+50

F.A.U. RTE.	SECTION	COUNTY	TOTAL SHEETS	SHEET NO.
1638	06-00162-01-SW	WILL	17	8
FED. ROAD DIST. NO. 1 ILLINOIS			FED. AID PROJECT CMM-8003 (077)	
CONTRACT NO. 63435				



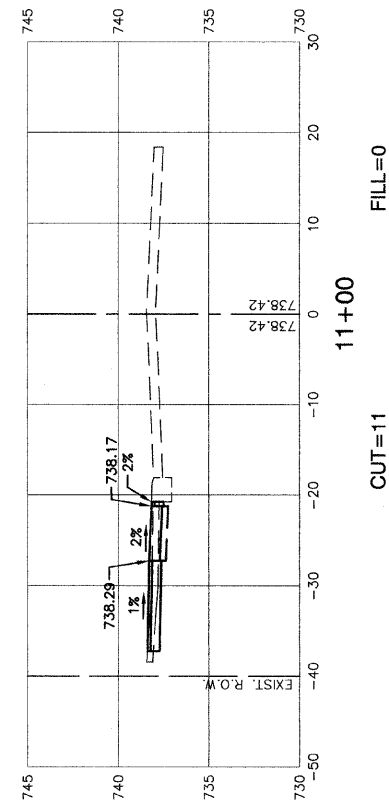
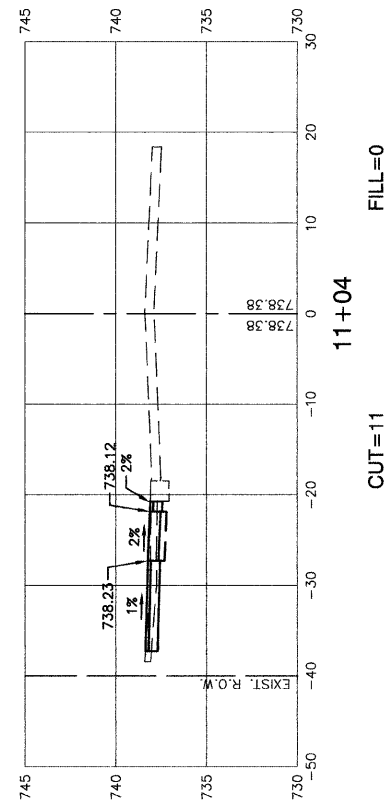
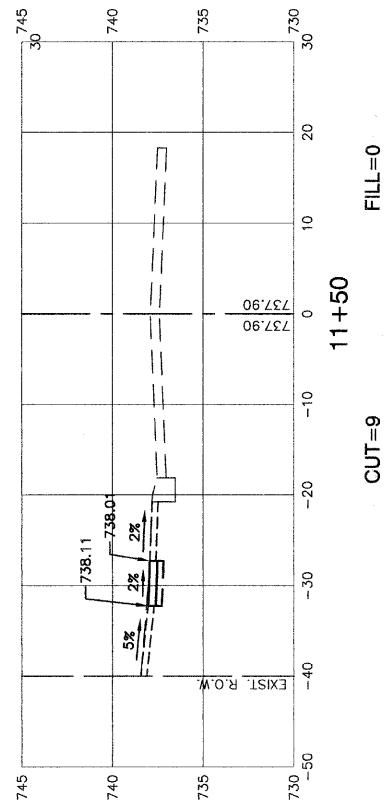
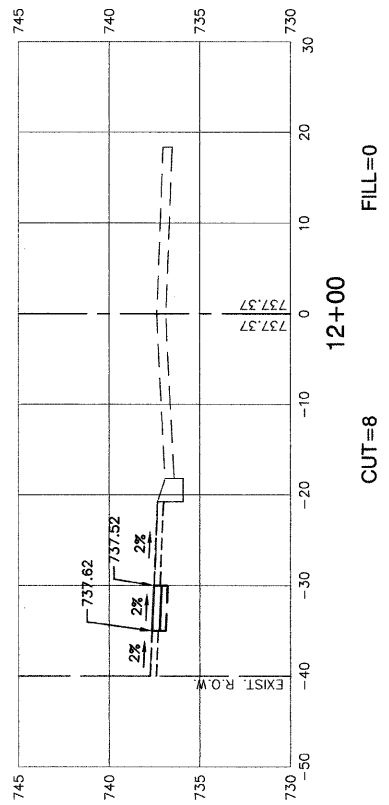
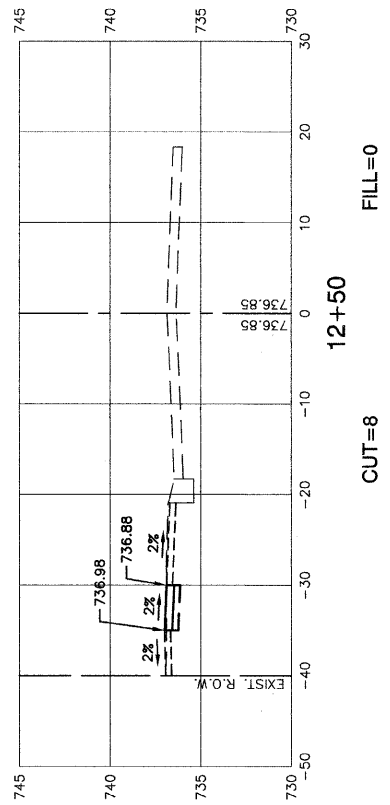
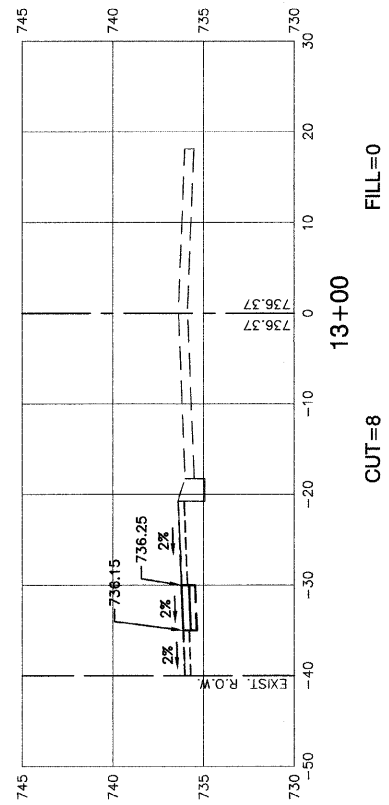

FILE NAME = 05612\_01.XBCT-01

USER NAME =	DESIGNED -- JN/MN	REVISED --
	CHECKED -- JN/MN	REVISED --
PLOT SCALE =	DRAWN -- KWM	REVISED --
PLOT DATE = 12-01-09	CHECKED -- KWM	REVISED --

STATE OF ILLINOIS  
DEPARTMENT OF TRANSPORTATION

EXCHANGE ST. AND SANGAMON ST.  
SOUTHLAND SAFE ROUTE TO SCHOOL PROGRAM  
CROSS SECTIONS

SCALE: H 1"=10' V 1"=5' SHEET NO. 9 OF 17 SHEETS STA. 11+00 TO STA. 13+00

F.A.U. RTE	SECTION	COUNTY	TOTAL SHEETS	SHEET NO.
1638	06-00162-01-SW	WILL	17	9
FED. ROAD DIST. NO. 1 ILLINOIS			FED. AID PROJECT CMM-9003 (077)	
CONTRACT NO. 63435				

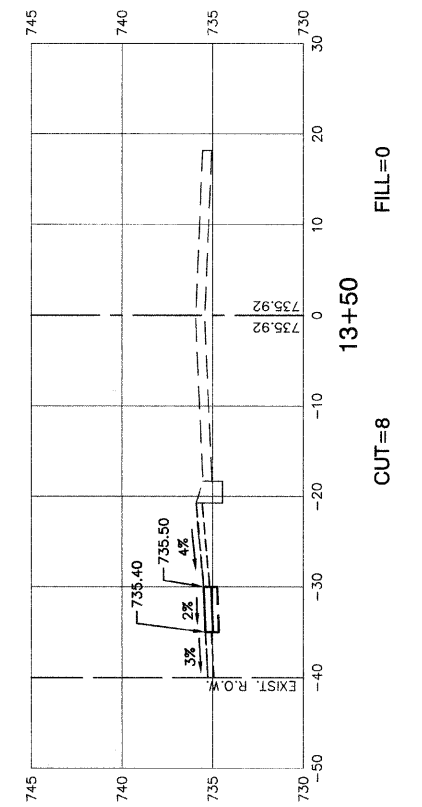
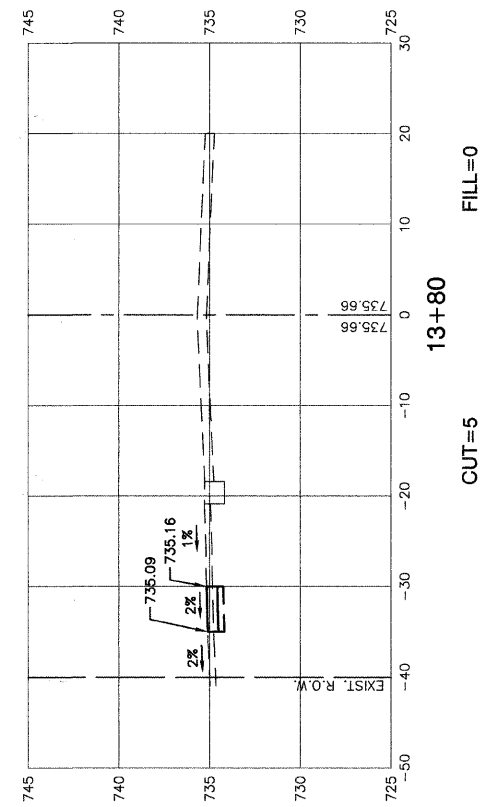
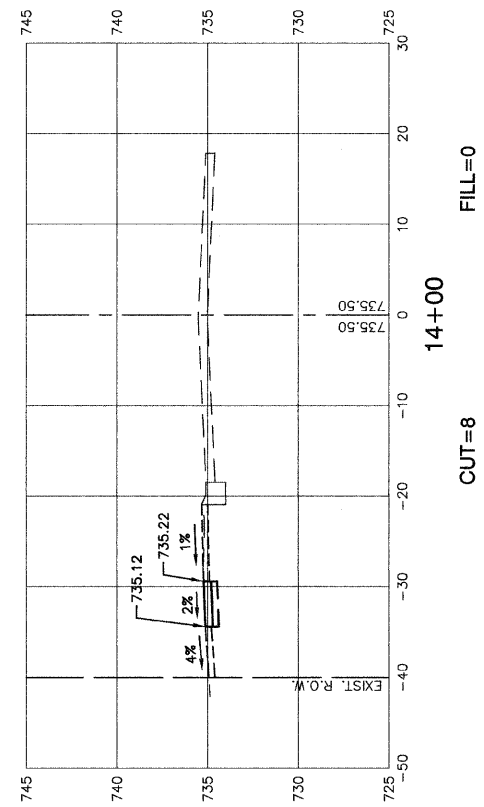
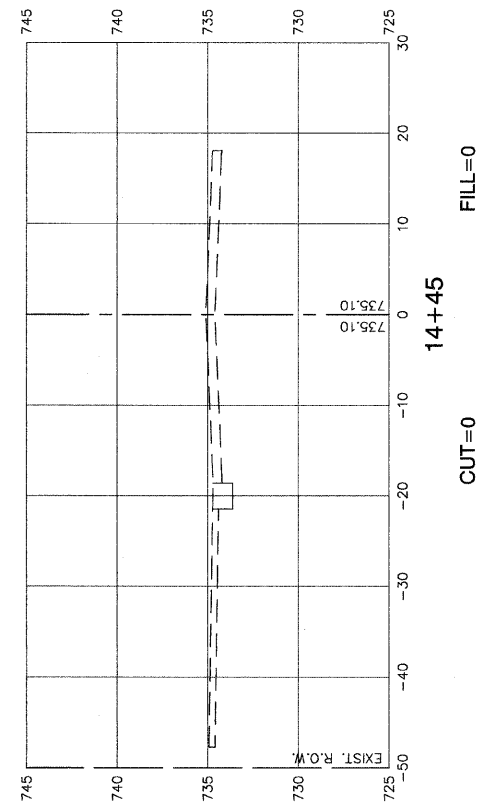
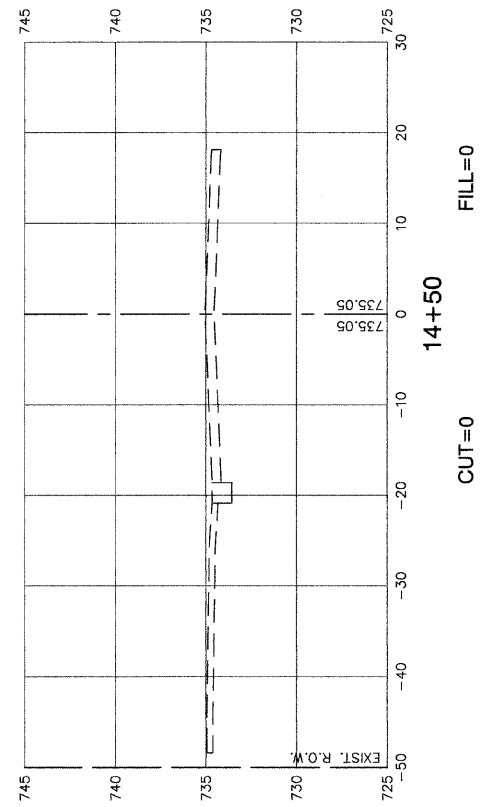

FILE NAME = 05612\_01.XSCT-01

USER NAME =	DESIGNED -- JN/MN	REVISED --
	CHECKED -- JN/MN	REVISED --
PLOT SCALE =	DRAWN -- KWM	REVISED --
PLOT DATE = 12-01-09	CHECKED -- KWM	REVISED --

STATE OF ILLINOIS  
DEPARTMENT OF TRANSPORTATION

EXCHANGE ST. AND SANGAMON ST.  
SOUTHLAND SAFE ROUTE TO SCHOOL PROGRAM  
CROSS SECTIONS

SCALE: H 1"=10' V 1"=5' SHEET NO. 10 OF 17 SHEETS STA. 13+50 TO STA. 14+50

F.A.U. RTE.	SECTION	COUNTY	TOTAL SHEETS	SHEET NO.
1638	06-00162-01-SW	WILL	17	10
FED. ROAD DIST. NO. 1 ILLINOIS FED. AID PROJECT CMM-9003 (077)			CONTRACT NO. 63435	

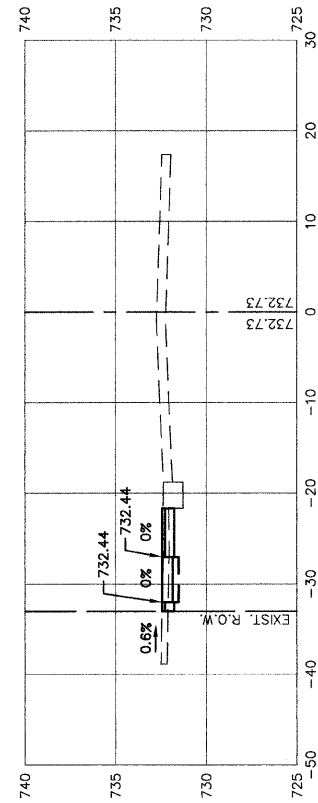

CUT=8  
16+88  
FILL=0

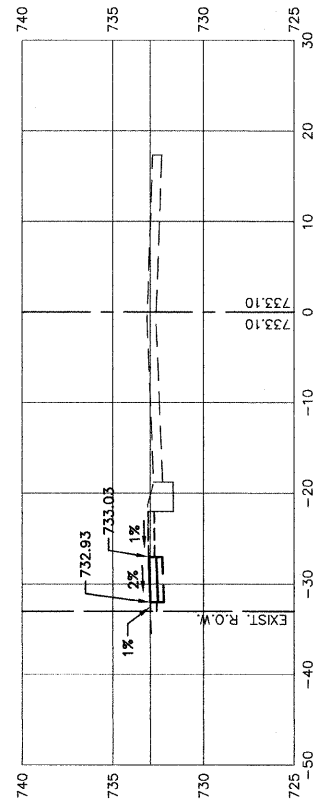

CUT=6  
16+50  
FILL=0

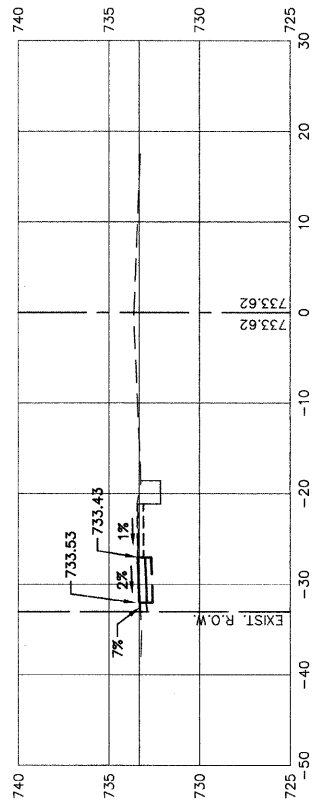

CUT=6  
16+00  
FILL=0

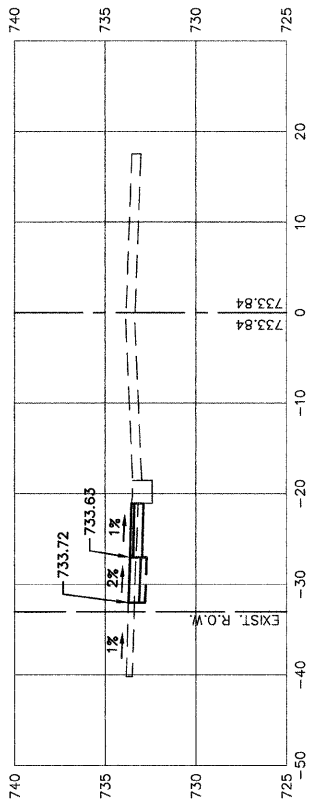

CUT=8  
15+73  
FILL=0

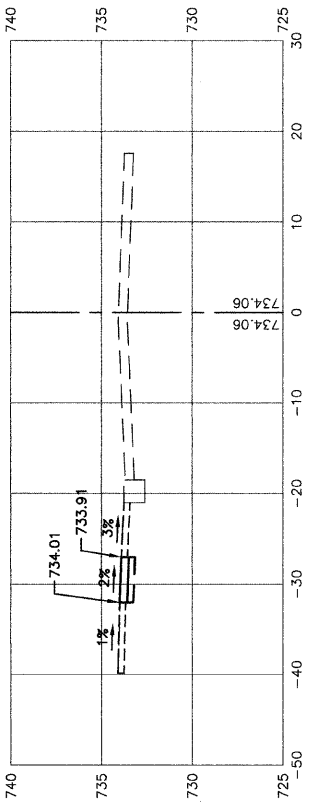

CUT=8  
15+50  
FILL=0

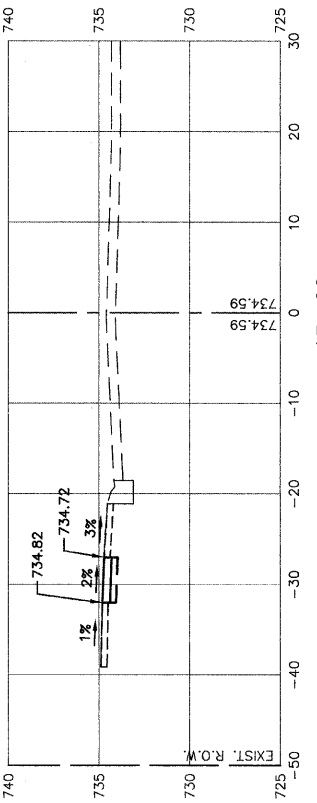

CUT=8  
15+00  
FILL=0

FILE NAME = 05612\_01.XSCT-01

USER NAME =	DESIGNED -- JN/MN	REVISED --
CHECKED -- JN/MN	REVISIONS --	
PLOT SCALE =	DRAWN -- KWM	REVISED --
PLOT DATE = 12-01-09	CHECKED -- KWM	REVISED --

STATE OF ILLINOIS  
DEPARTMENT OF TRANSPORTATION

EXCHANGE ST. AND SANGAMON ST.  
SOUTHLAND SAFE ROUTE TO SCHOOL PROGRAM  
CROSS SECTIONS

SCALE: H 1"=10' V 1"=5' SHEET NO. 11 OF 17 SHEETS STA. 15+00 TO STA. 16+88

F.A.U. RTE.	SECTION	COUNTY	TOTAL SHEETS	SHEET NO.
1638	06-00162-01-SW	WILL	17	11
FED. ROAD DIST. NO. 1 ILLINOIS			CONTRACT NO. 63435	
FED. AID PROJECT CMM-9003 (077)				

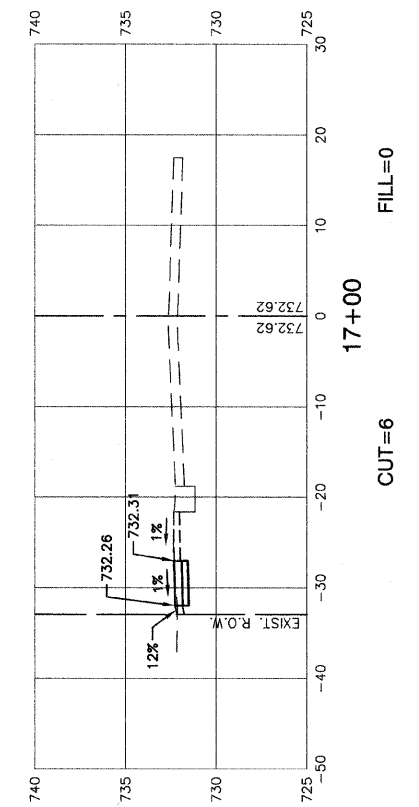
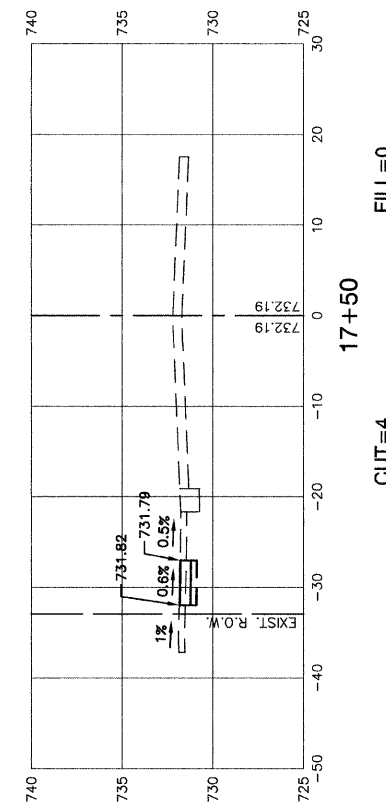
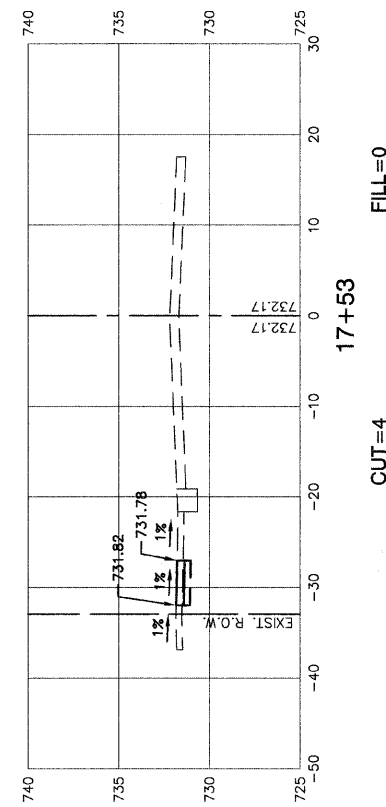
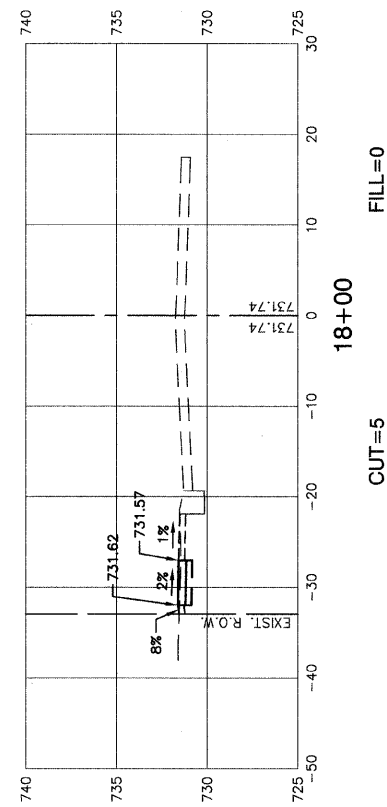
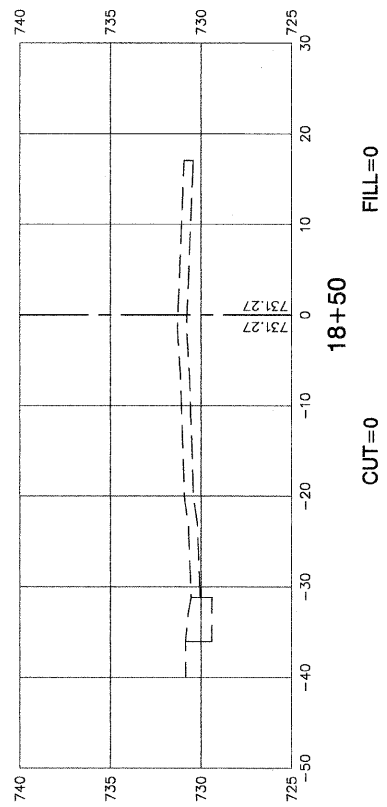

FILE NAME = 05612_01.XSCT-01	USER NAME =	DESIGNED -- JN/MN	REVISED --
		CHECKED -- JN/MN	REVISED --
	PLOT SCALE =	DRAWN -- KWM	REVISED --
	PLOT DATE = 12-01-09	CHECKED -- KWM	REVISED --

**STATE OF ILLINOIS  
DEPARTMENT OF TRANSPORTATION**

EXCHANGE ST. AND SANGAMON ST. SOUTHLAND SAFE ROUTE TO SCHOOL PROGRAM CROSS SECTIONS			
SCALE: H 1"=10' V 1"=5'	SHEET NO. 12 OF 17 SHEETS	STA. 17+00 TO STA. 18+50	

F.A.U. RTE.	SECTION	COUNTY	TOTAL SHEETS	SHEET NO.
1638	06-00162-01-SW	WILL	17	12
FED. ROAD DIST. NO. 1 ILLINOIS			FED. AID PROJECT CMM-9003 (077)	
CONTRACT NO. 63435				

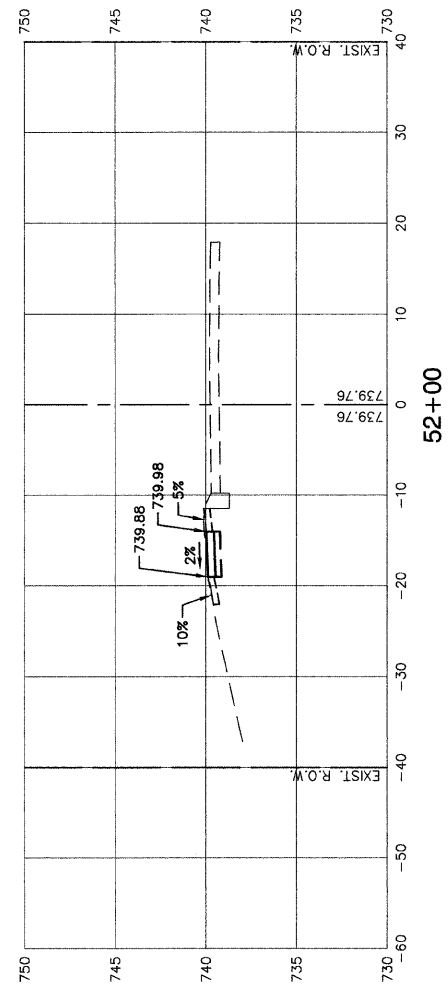

CUT=6  
FILL=0

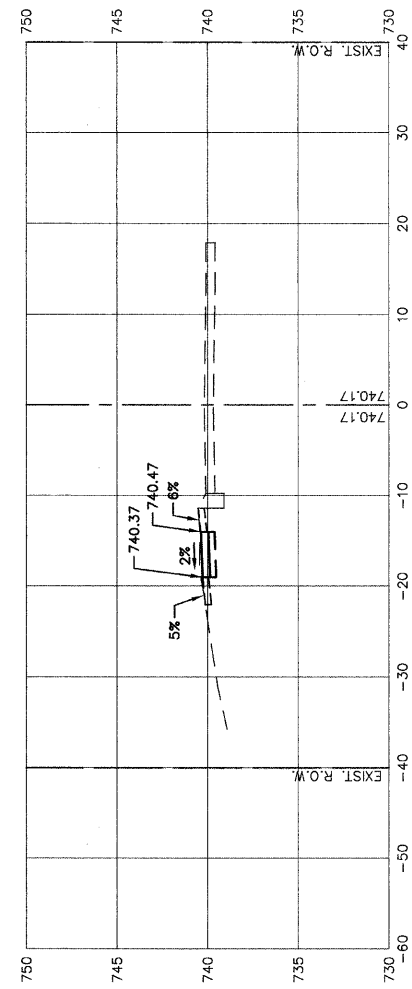

CUT=7  
FILL=0

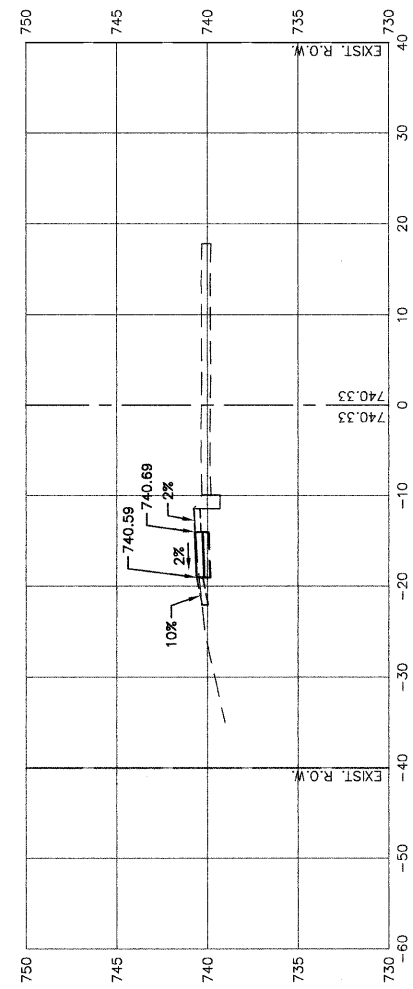

CUT=5  
FILL=0

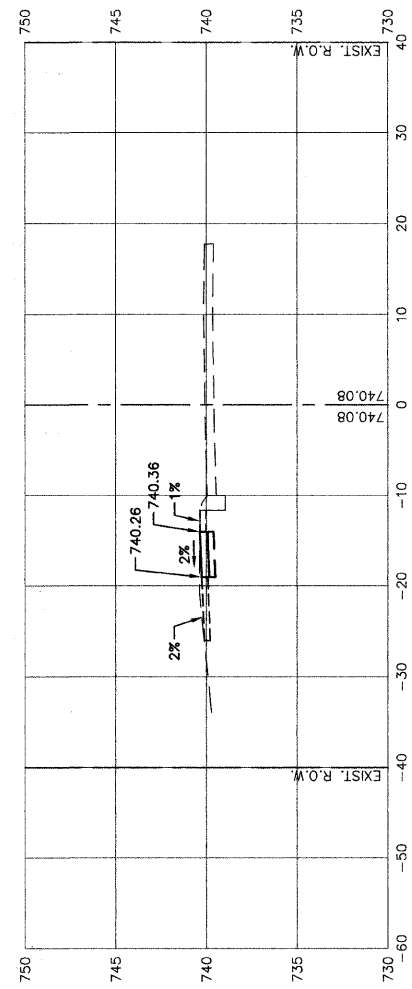

CUT=7  
FILL=0

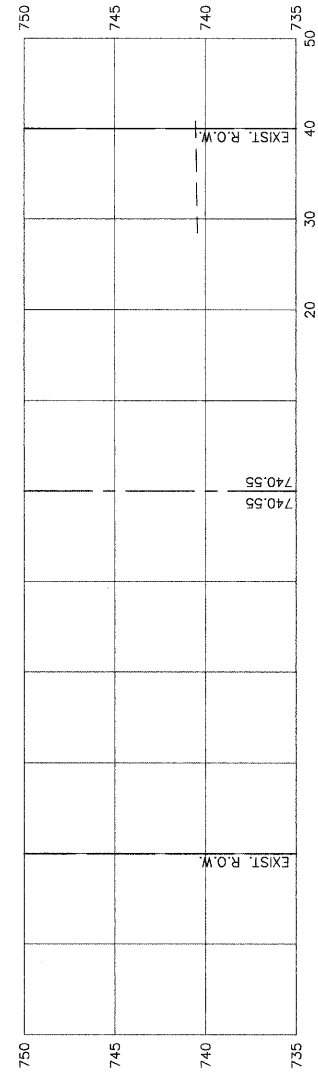

CUT=0  
FILL=0

FILE NAME = 06612\_01.XSCT-01

USER NAME =	DESIGNED -- JN/MN	REVISED --
	CHECKED -- JN/MN	REVISED --
PLOT SCALE =	DRAWN -- KWM	REVISED --
PLOT DATE = 12-01-09	CHECKED -- KWM	REVISED --

STATE OF ILLINOIS  
DEPARTMENT OF TRANSPORTATION

EXCHANGE ST. AND SANGAMON ST.  
SOUTHLAND SAFE ROUTE TO SCHOOL PROGRAM  
CROSS SECTIONS

SCALE: H 1"=10' V 1"=5' SHEET NO. 13 OF 17 SHEETS STA. 50+00 TO STA. 52+00

F.A.U. RTE.	SECTION	COUNTY	TOTAL SHEETS	SHEET NO.
1638	06-00162-01-SW	WILL	17	13
FED. ROAD DIST. NO. 1 ILLINOIS			FED. AID PROJECT CMM-9003 (077)	
CONTRACT NO. 63435				

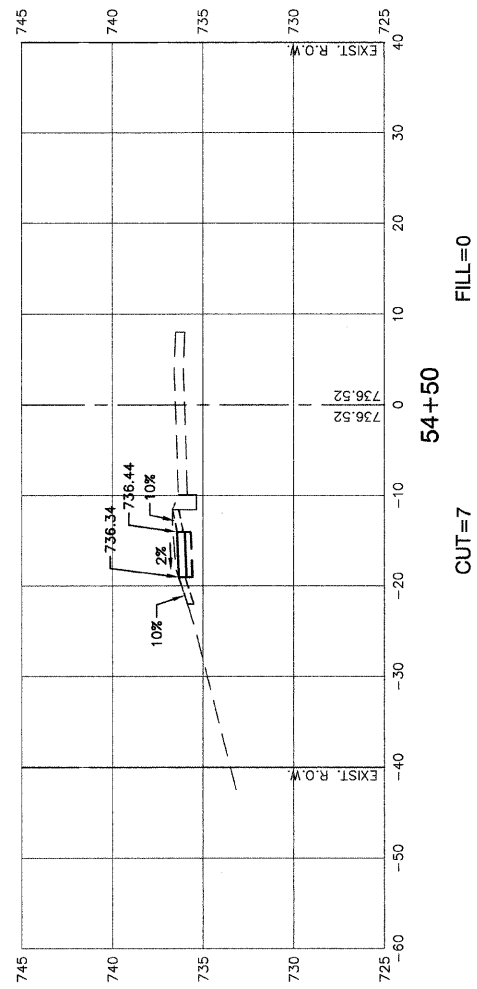

CUT=7 FILL=0

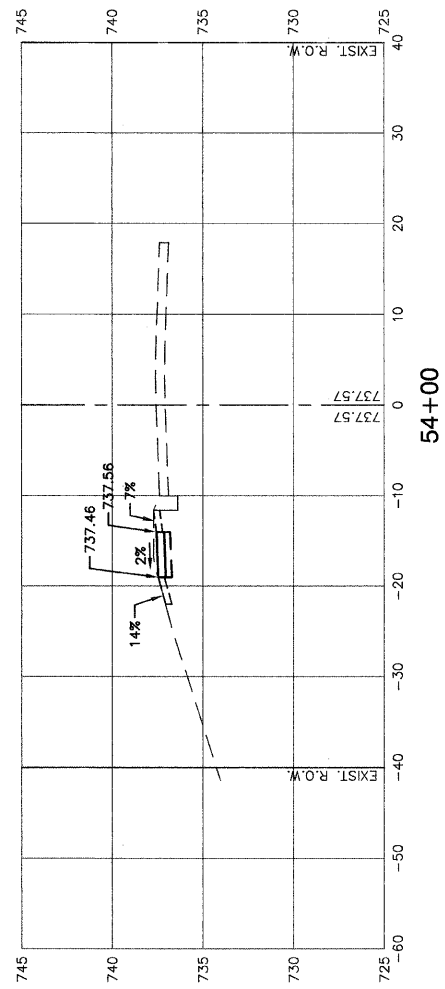

CUT=7 FILL=0

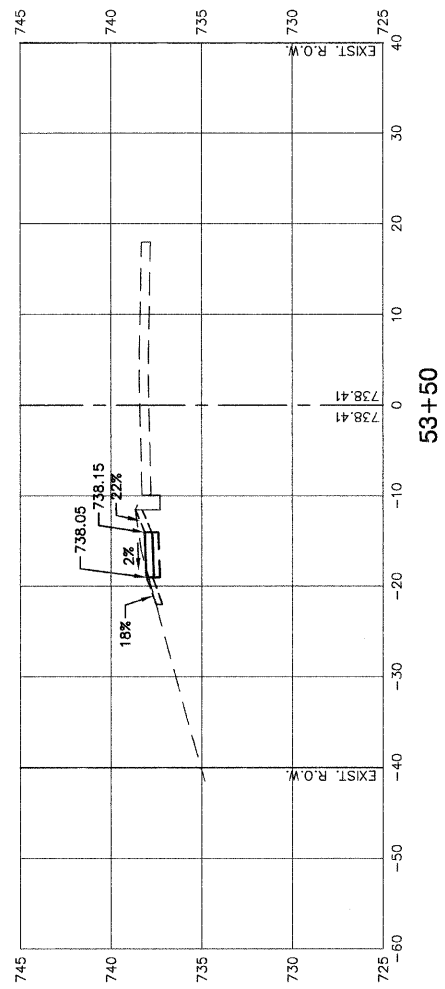

CUT=7 FILL=0

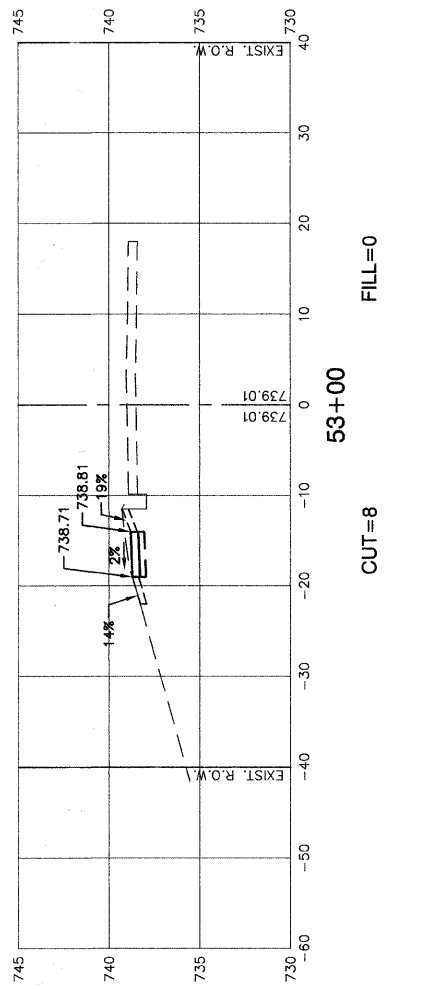

CUT=8 FILL=0

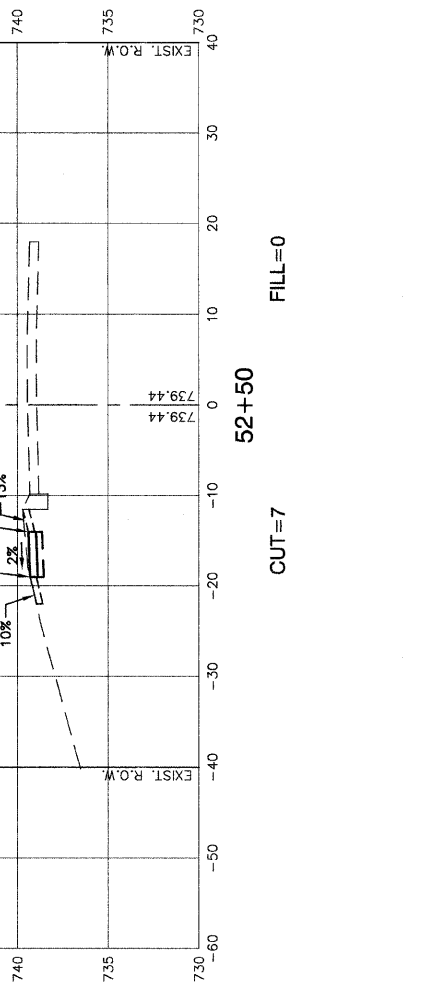

CUT=7 FILL=0

FILE NAME = 05612\_01.XSCT-01

USER NAME =	DESIGNED -- JN/MN	REVISED --
	CHECKED -- JN/MN	REVISED --
PLOT SCALE =	DRAWN -- KWM	REVISED --
PLOT DATE = 12-01-09	CHECKED -- KWM	REVISED --

STATE OF ILLINOIS  
DEPARTMENT OF TRANSPORTATION

EXCHANGE ST. AND SANGAMON ST.  
SOUTHLAND SAFE ROUTE TO SCHOOL PROGRAM  
CROSS SECTIONS

SCALE: H 1"=10' V 1"=5' SHEET NO. 14 OF 17 SHEETS STA. 52+50 TO STA. 54+50

F.A.U. RTE.	SECTION	COUNTY	TOTAL SHEETS	SHEET NO.
1838	06-00162-01-SW	WILL	17	14
FED. ROAD DIST. NO. 1 ILLINOIS FED. AID PROJECT CMM-9003 (077)				
CONTRACT NO. 63435				

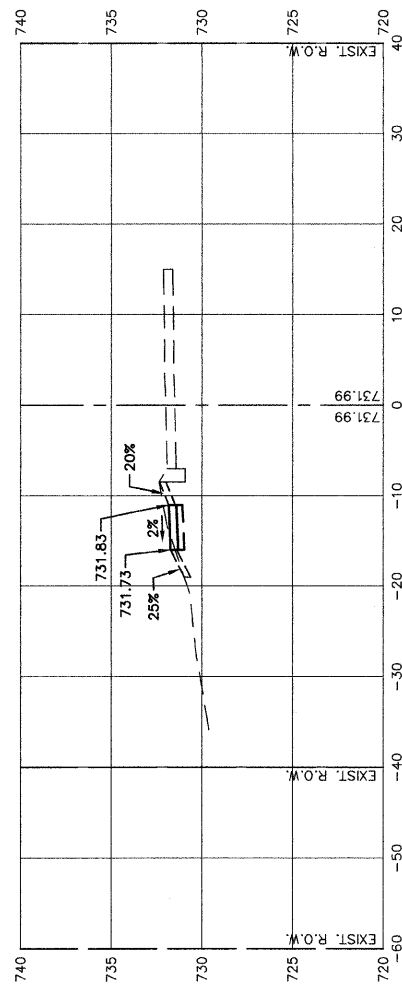

CUT=6 FILL=0

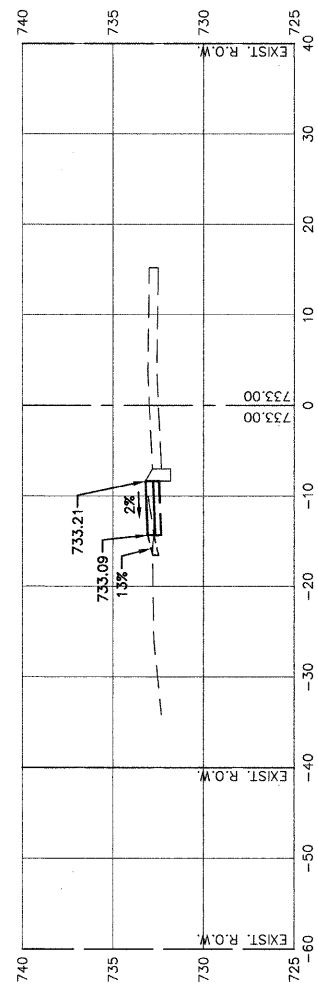

CUT=4 FILL=0

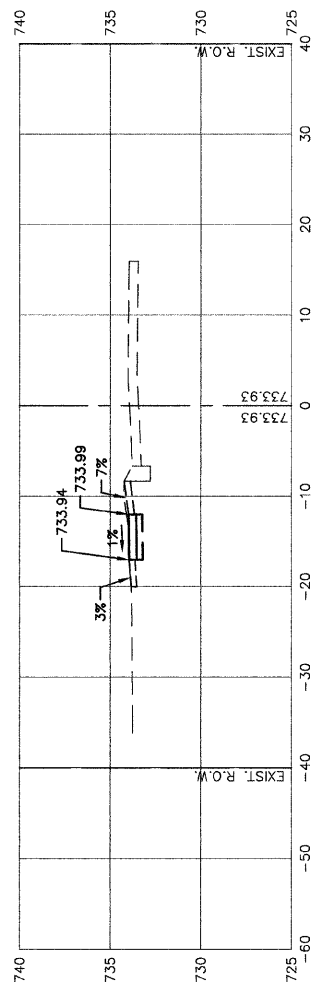

CUT=7 FILL=0

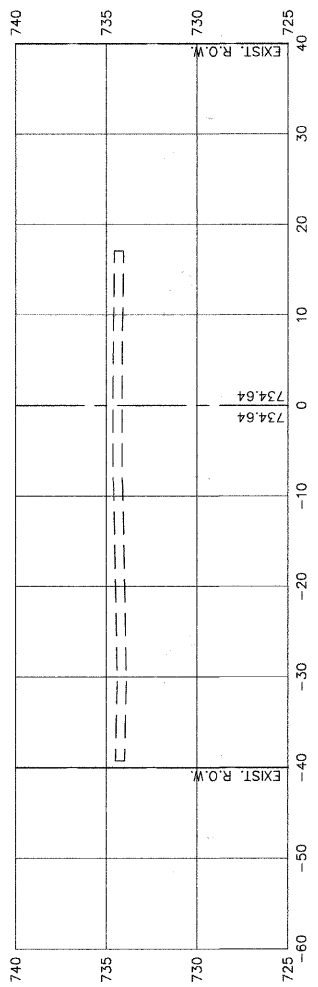

CUT=0 FILL=0

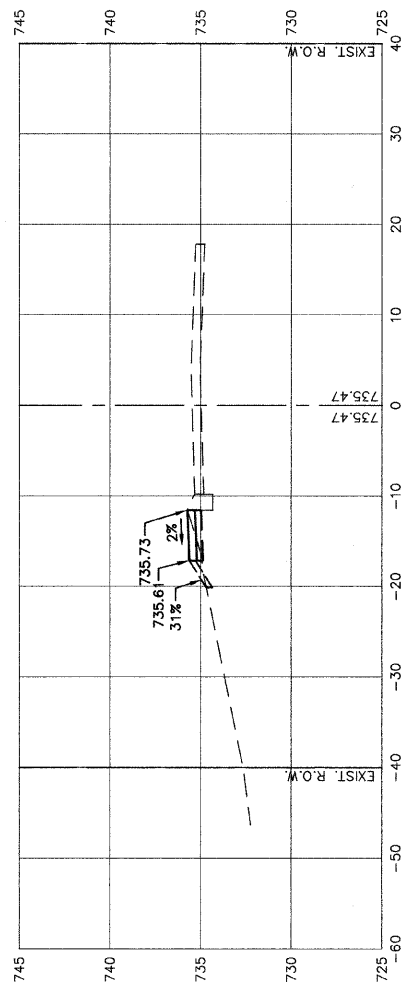

CUT=3 FILL=1

FILE NAME = 05612\_01.XSCT-01

USER NAME =	DESIGNED - JN/MN	REVISED -
	CHECKED - JN/MN	REVISED -
PLOT SCALE =	DRAWN - KWM	REVISED -
PLOT DATE = 12-01-09	CHECKED - KWM	REVISED -

STATE OF ILLINOIS  
DEPARTMENT OF TRANSPORTATION

EXCHANGE ST. AND SANGAMON ST.  
SOUTHLAND SAFE ROUTE TO SCHOOL PROGRAM  
CROSS SECTIONS

SCALE: H 1"=10' V 1"=5' SHEET NO. 15 OF 17 SHEETS STA. 55+00 TO STA. 57+00

F.A.U. RTE. 1638	SECTION 06-00162-01-SW	COUNTY WILL	TOTAL SHEETS 17	SHEET NO. 15
FED. ROAD DIST. NO. 1 ILLINOIS			FED. AID PROJECT CMM-9003 (077)	
CONTRACT NO. 63435				

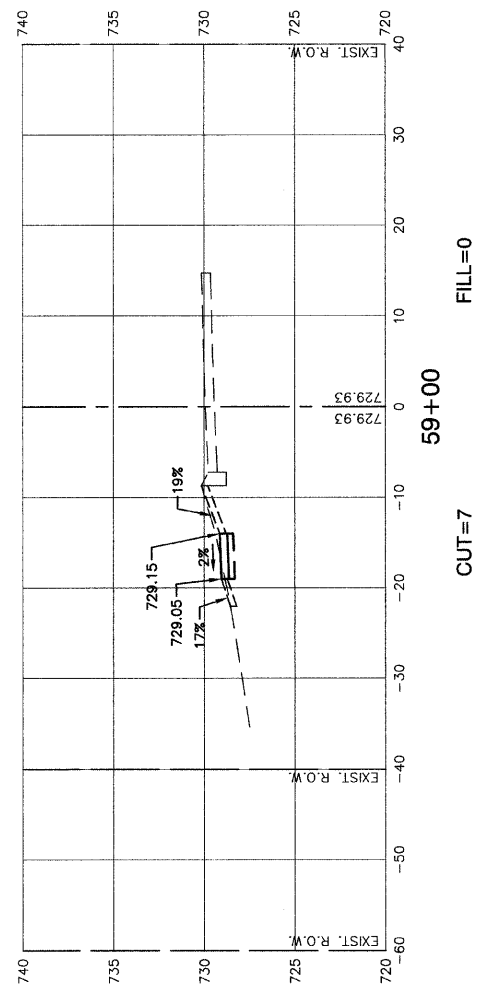

CUT=7 FILL=0

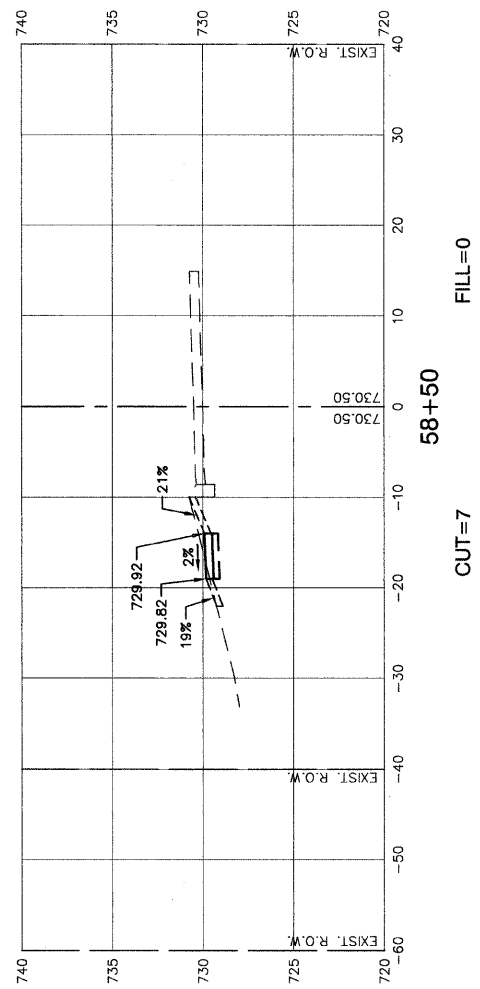

CUT=7 FILL=0

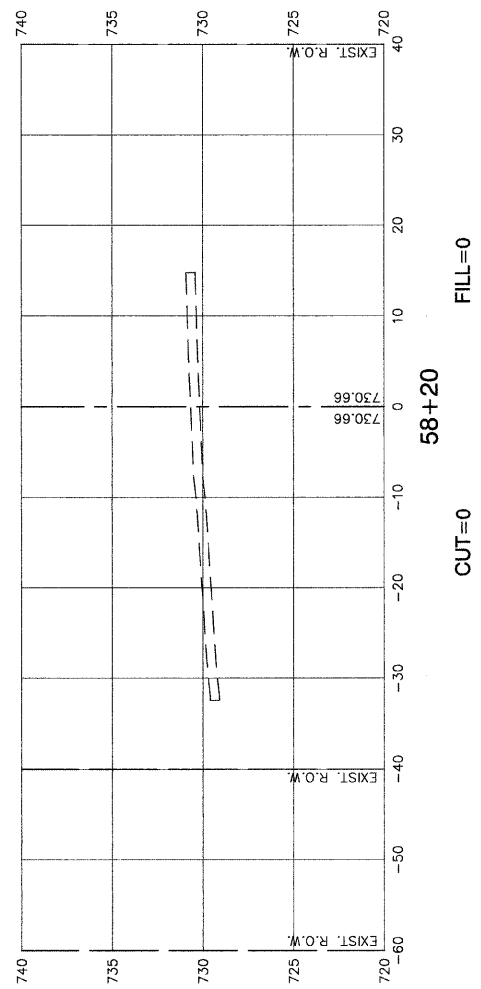

CUT=0 FILL=0

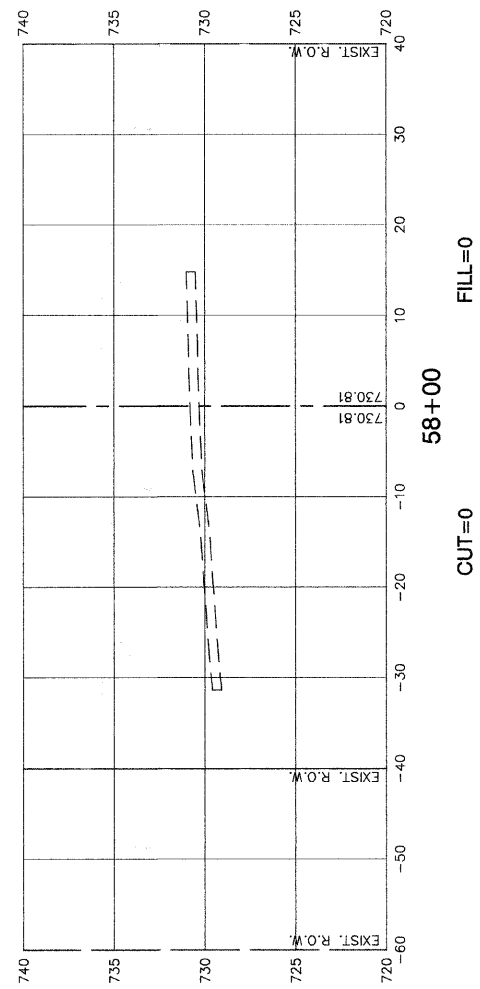

CUT=0 FILL=0

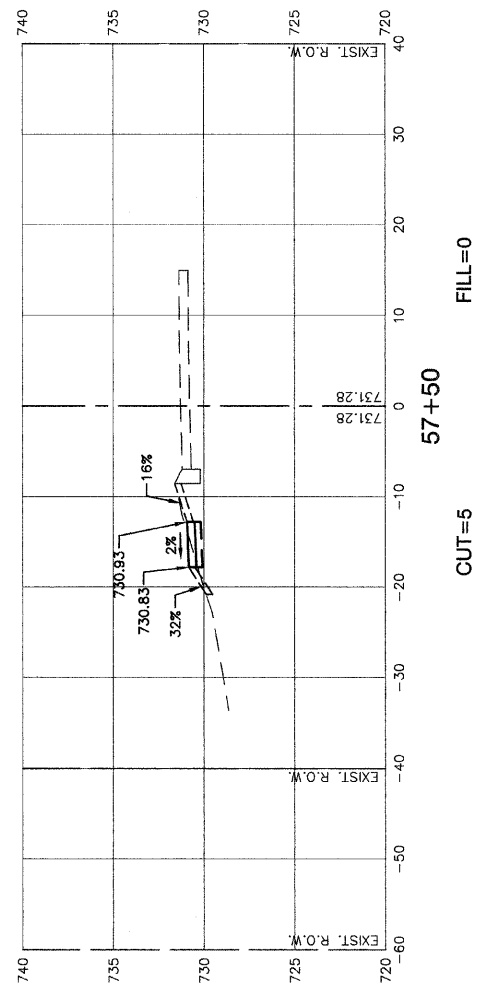

CUT=5 FILL=0

FILE NAME = 05612\_01.XSCT-01

USER NAME =	DESIGNED -- JN/MN	REVISED --
	CHECKED -- JN/MN	REVISED --
PLOT SCALE =	DRAWN -- KWM	REVISED --
PLOT DATE = 12-01-09	CHECKED -- KWM	REVISED --

STATE OF ILLINOIS  
DEPARTMENT OF TRANSPORTATION

EXCHANGE ST. AND SANGAMON ST.  
SOUTHLAND SAFE ROUTE TO SCHOOL PROGRAM  
CROSS SECTIONS

SCALE: H 1"=10' V 1"=5' SHEET NO. 16 OF 17 SHEETS STA. 57+50 TO STA. 59+00

F.A.U. RTE.	SECTION	COUNTY	TOTAL SHEETS	SHEET NO.
1638	06-00162-01-SW	WILL	17	16
CONTRACT NO. 63435				
FED. ROAD DIST. NO. 1 ILLINOIS FED. AID PROJECT CMM-9003 (077)				



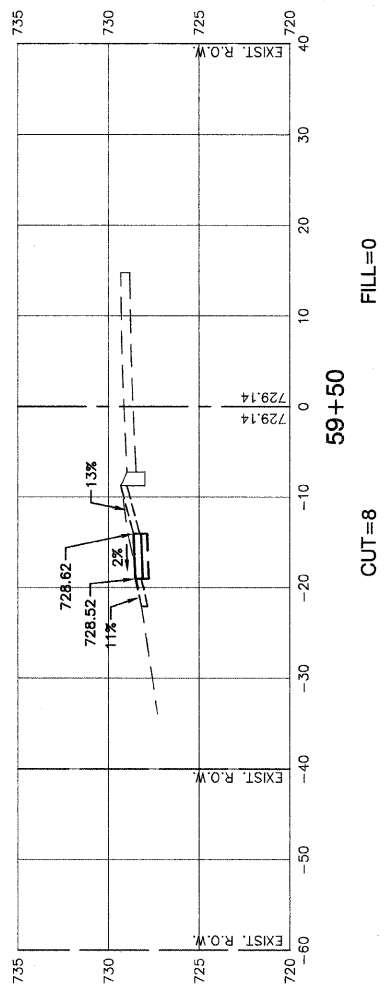
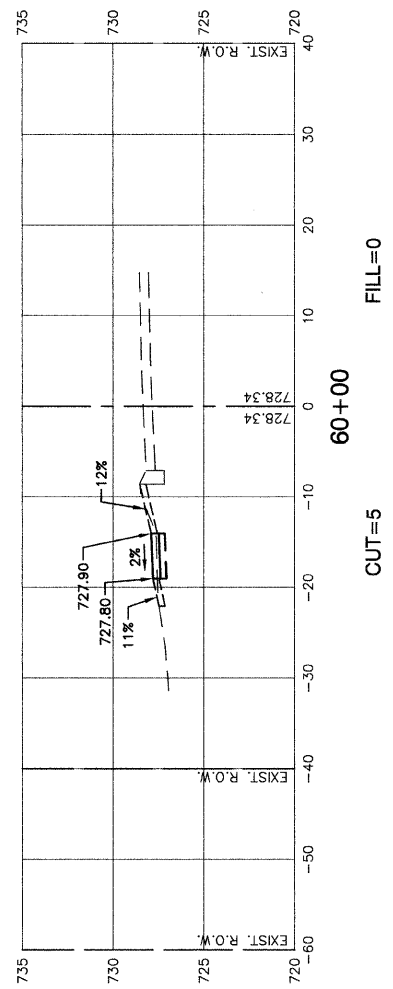
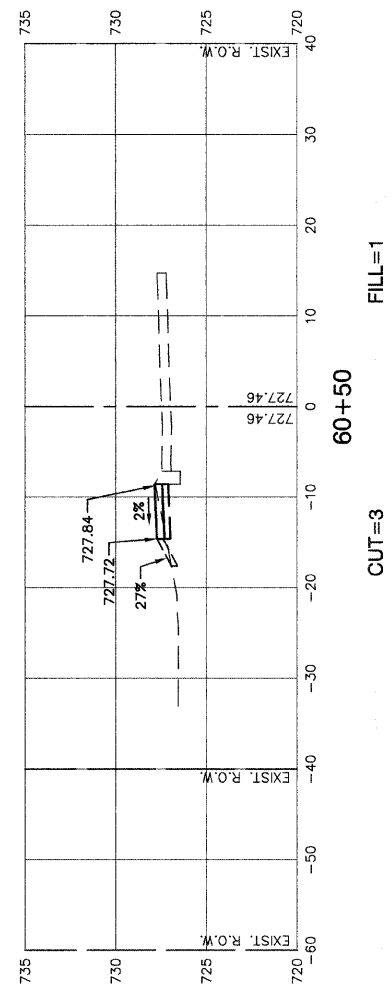
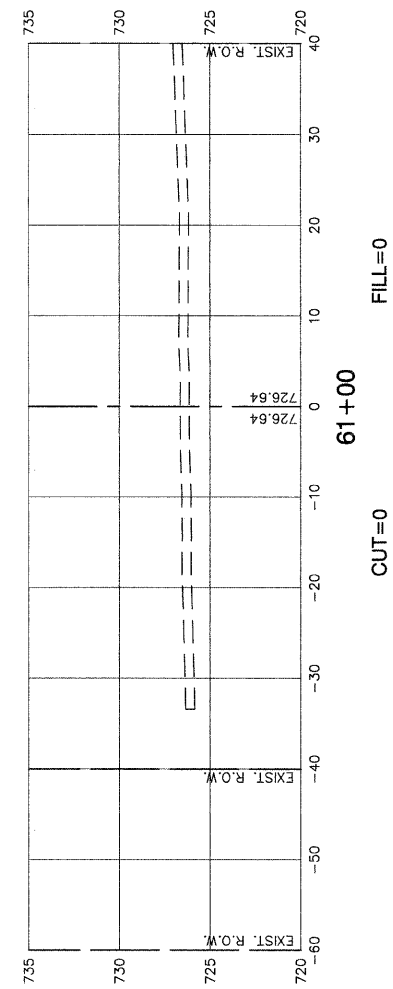
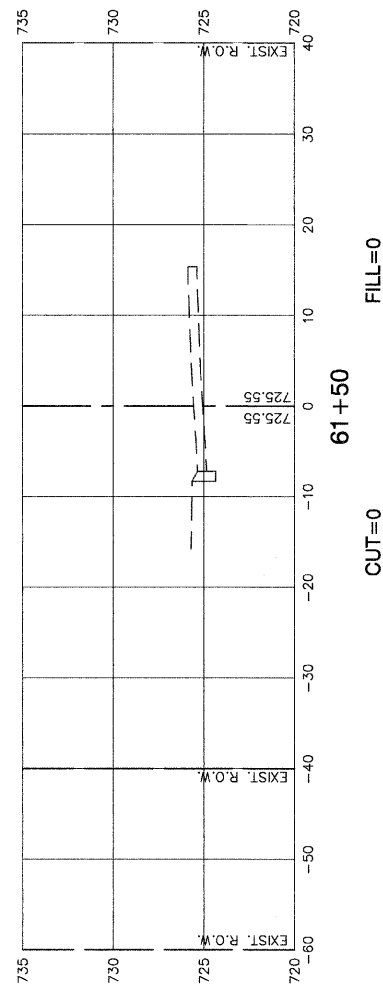

FILE NAME = 05612\_01.XSCT-01  
 USER NAME =  
 PLOT SCALE =  
 PLOT DATE = 12-01-09

DESIGNED	—	JN/MN	REVISED	—
CHECKED	—	JN/MN	REVISED	—
DRAWN	—	KWM	REVISED	—
CHECKED	—	KWM	REVISED	—

**STATE OF ILLINOIS  
 DEPARTMENT OF TRANSPORTATION**

**EXCHANGE ST. AND SANGAMON ST.  
 SOUTHLAND SAFE ROUTE TO SCHOOL PROGRAM  
 CROSS SECTIONS**

SCALE: H 1"=10' V 1"=5'    SHEET NO. 17 OF 17 SHEETS    STA. 59+50 TO STA. 61+50

F.A.U. RTE.	SECTION	COUNTY	TOTAL SHEETS	SHEET NO.
1638	06-00162-01-SW	WILL	17	17
FED. ROAD DIST. NO. 1 ILLINOIS    FED. AID PROJECT CMM-9003 (077)				

CONTRACT NO. 63435