

# STAGE 2

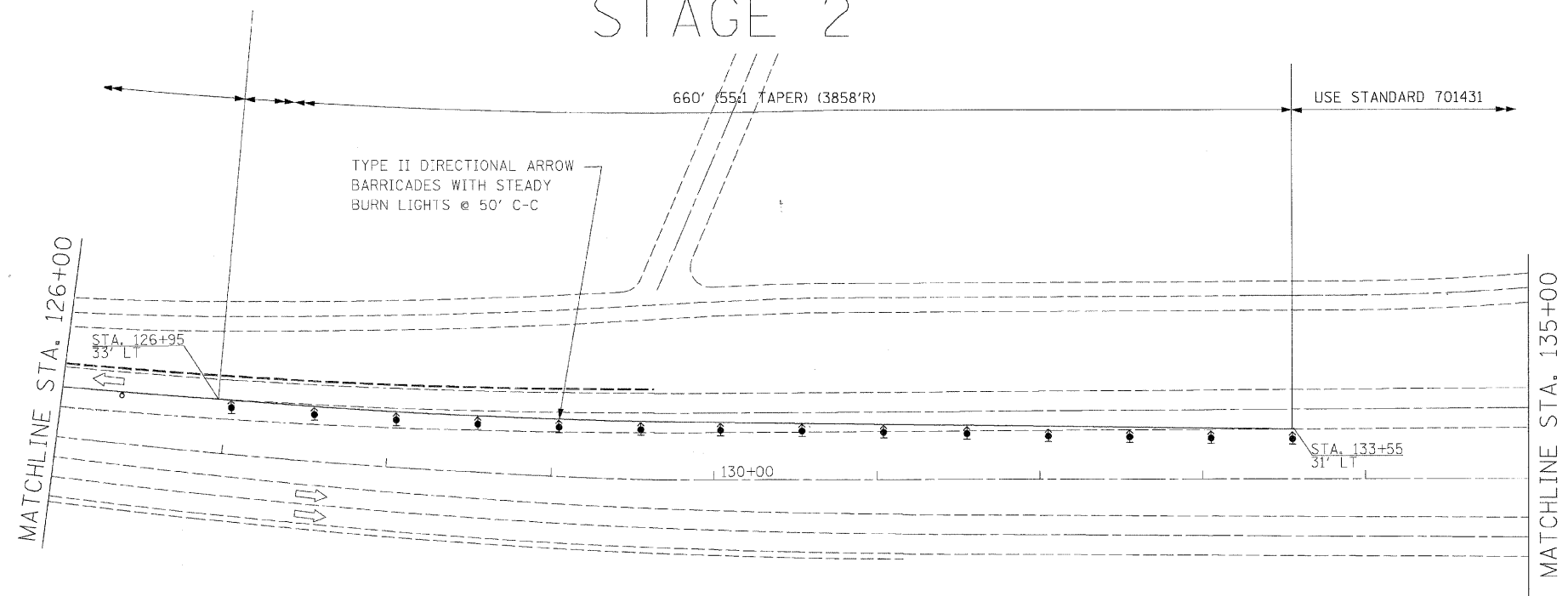

- SYMBOLS:**
- MEDIAN REMOVAL (SPECIAL) & TEMPORARY PAVEMENT
  - HOT-MIX ASPHALT SURFACE COURSE, MIX "C", N50, 6"
  - AGGREGATE BASE COURSE, TYPE B, 12"

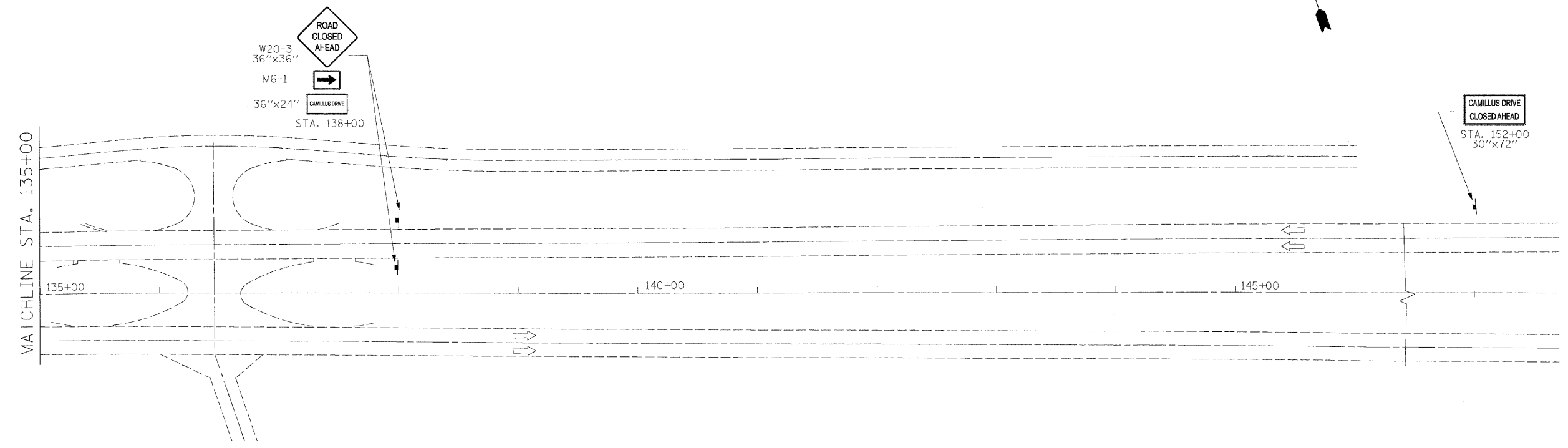

FILE NAME =	USER NAME = \$USER\$	DESIGNED - KAC	REVISED -	<b>STATE OF ILLINOIS DEPARTMENT OF TRANSPORTATION</b>	<b>STAGING PLANS (STAGE 2)</b>			F.A.P. RTE.	SECTION	COUNTY	TOTAL SHEETS	SHEET NO.
G:\ENR\06-6790-13.TASK7\CL\Sh\116468	SHT008C_PROP_stage2.dgn	DRAWN - TMF / JNH	REVISED -		301	43T & M	Jo Daviess	80	24			
	PLOT SCALE = \$SCALE\$	CHECKED - KAC	REVISED -		SCALE: 1" = 50'    SHEET NO. 24 OF 80 SHEETS    STA. 99+27 TO STA. 114+33			CONTRACT NO. 64C68				
	PLOT DATE = 12/1/2009	DATE - 11/13/2009	REVISED -		ILLINOIS FED. AID PROJECT							