

DATE	
BY	
PLAN	SURVEYED
	ALIGNED
	CHECKED
	RT. OF WAY CHECKED
	PLANT FILE NAME
NO.	

DATE	
BY	
PROFILE	SURVEYED
	GRADES CHECKED
	B.M. NOTED
	STRUCTURE NOTATION CHECKED
NO.	

PROJECT NO. 2944
 HARRY G. HERR, ASSOCIATES, INC.
 59 East Jackson Blvd.
 Chicago, IL 60604
 (312) 467-8111
 (312) 467-8112

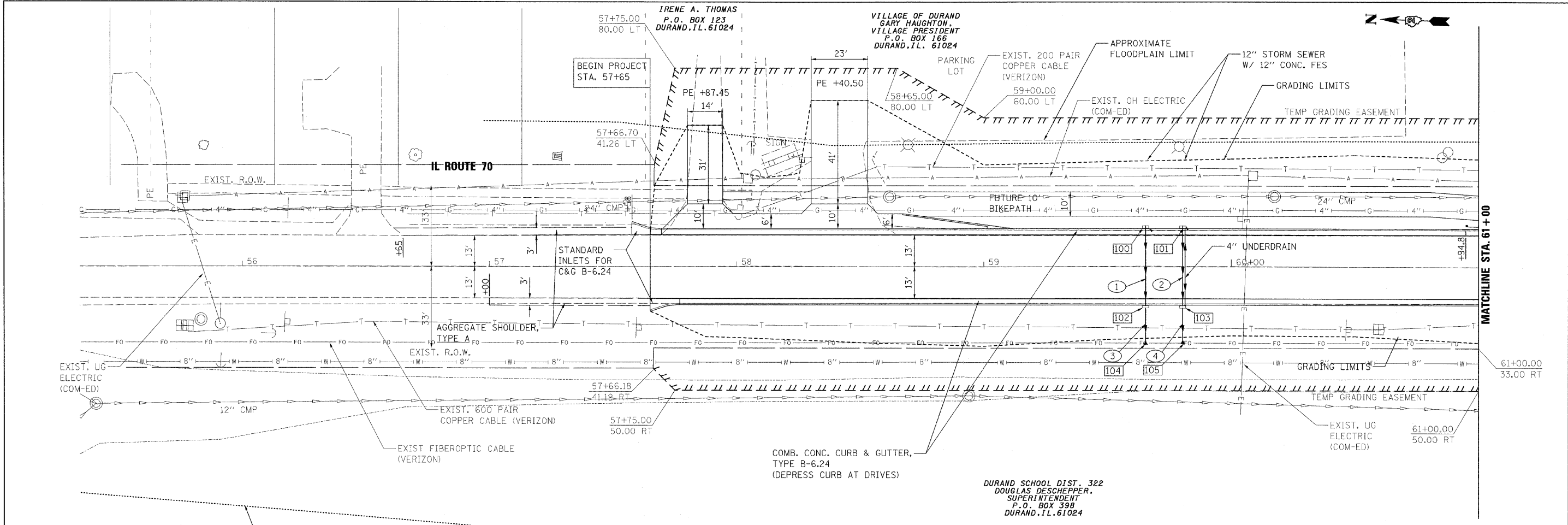

NOTES:
 1. DRIVEWAYS SHALL BE PCC FOR THE FIRST 10' PAST THE BACK OF CURB, THE REMAINDER OF THE DRIVEWAYS SHALL BE HMA TO THE TIEDOWN POINT.

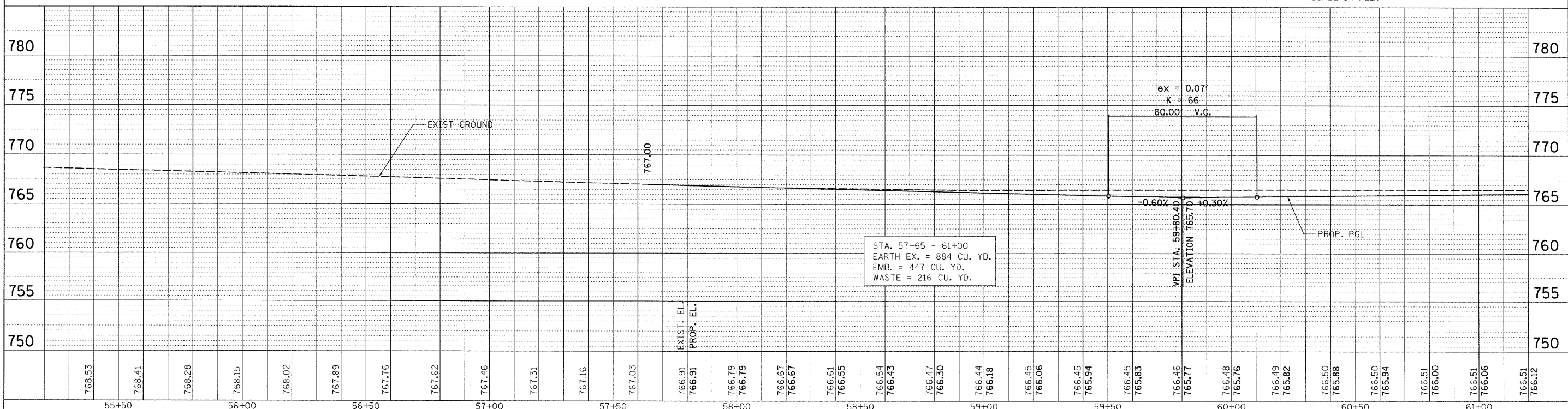
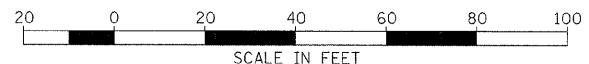

FILE NAME = H:\P-projects\2944\DGNS\Z0620\PLN1.dgn	USER NAME = #USER#	DESIGNED -	REVISED -	STATE OF ILLINOIS DEPARTMENT OF TRANSPORTATION	IL. ROUTE 70 OVER OTTER CREEK PLAN AND PROFILE	F.A.P. RTE. 55	SECTION (W-1-15)BR-1	COUNTY WINNEBAGO	TOTAL SHEETS 59	SHEET NO. 14
PLDT SCALE = 20.0000' / IN.	CHECKED -	REVISED -	SCALE: 1" = 20'			SHEET NO. 1 OF 2 SHEETS	STA. 57+65 TO STA. 61+00	FED. ROAD DIST. NO.	ILLINOIS FED. AID PROJECT	CONTRACT NO. 64D22
PLDT DATE = 11/30/2009	DATE = 06/04/08	REVISED -								