

# INFORMATION ONLY

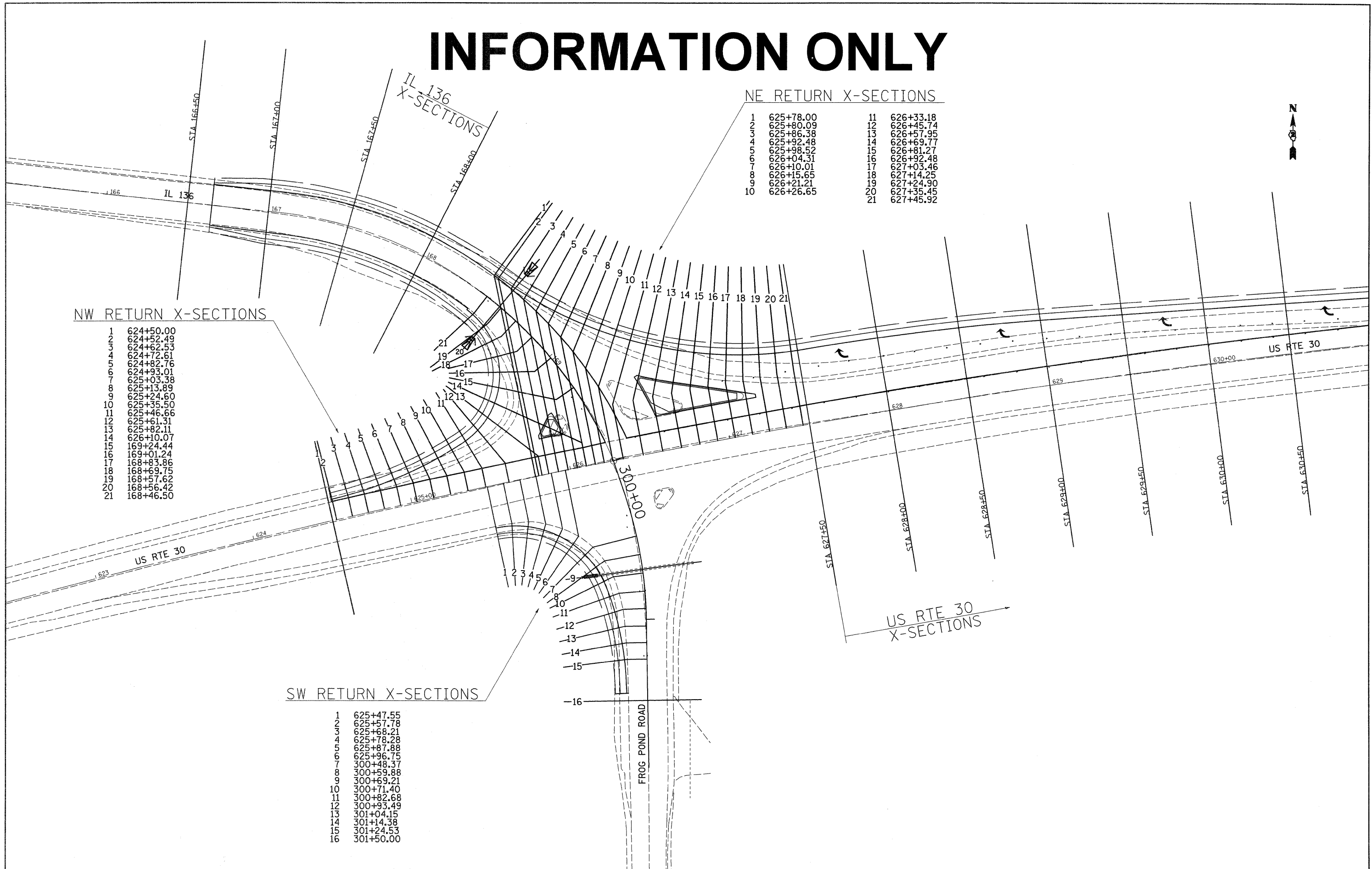

### NE RETURN X-SECTIONS

1	625+78.00	11	626+33.18
2	625+80.09	12	626+45.74
3	625+86.38	13	626+57.95
4	625+92.48	14	626+69.77
5	625+98.52	15	626+81.27
6	626+04.31	16	626+92.48
7	626+10.01	17	627+03.46
8	626+15.65	18	627+14.25
9	626+21.21	19	627+24.90
10	626+26.65	20	627+35.45
		21	627+45.92

### NW RETURN X-SECTIONS

1	624+50.00
2	624+52.49
3	624+62.53
4	624+72.61
5	624+82.76
6	624+93.01
7	625+03.38
8	625+13.89
9	625+24.60
10	625+35.50
11	625+46.66
12	625+61.31
13	625+82.11
14	626+10.07
15	169+24.44
16	169+01.24
17	168+83.86
18	168+69.75
19	168+57.62
20	168+56.42
21	168+46.50

### SW RETURN X-SECTIONS

1	625+47.55
2	625+57.78
3	625+68.21
4	625+78.28
5	625+87.88
6	625+96.75
7	300+48.37
8	300+59.88
9	300+69.21
10	300+71.40
11	300+82.68
12	300+93.49
13	301+04.15
14	301+14.38
15	301+24.53
16	301+50.00