

F.A.P. RTE.	SECTION	COUNTY	TOTAL SHEETS	SHEET NO.
573/557	(116,128)T	DEKALB	21	1
		ILLINOIS	CONTRACT NO. 66939	

INDEX OF SHEETS

1. COVER SHEET
2. GENERAL NOTES
- 3 - 4. SUMMARY OF QUANTITIES
5. TYPICAL SECTIONS
- 6 - 7. SCHEDULES - US ROUTE 30
8. SCHEDULES - IL ROUTE 72
- 9 - 12. PLAN AND PROFILE - US ROUTE 30
- 13 - 14. PLAN AND PROFILE - IL ROUTE 72
15. GRADING AND SHAPING DITCH
16. FIELD ENTRANCE DETAILS
17. STAGING DETAILS
18. TEMPORARY CONCRETE BARRIER
- 19 - 20. BOX CULVERT RECONSTRUCTION
21. WATERPROOFING MEMBRANE

STANDARDS

- | | |
|-----------|--|
| 000001-05 | STANDARD SYMBOLS, ABBREVIATIONS AND PATTERNS |
| 001001-02 | AREAS OF REINFORCEMENT BARS |
| 001006 | DECIMAL OF AN INCH AND OF A FOOT |
| 280001-05 | TEMPORARY EROSION CONTROL SYSTEMS |
| 667101-01 | PERMANENT SURVEY MARKERS |
| 701001-02 | OFF-ROAD OPERATIONS 2L, 2W, MORE THAN 15' (4.5 m) AWAY |
| 701006-03 | OFF-ROAD OPERATIONS 2L, 2W, 15' (4.5 m) TO 24" (600 mm) FROM PAVEMENT EDGE |
| 701011-02 | OFF-ROAD MOVING OPERATIONS 2L, 2W, DAY ONLY |
| 701201-03 | LANE CLOSURE, 2L, 2W, DAY ONLY, FOR SPEEDS ≤ 45 MPH |
| 701301-03 | LANE CLOSURE, 2L, 2W, SHORT TIME OPERATIONS |
| 701311-03 | LANE CLOSURE, 2L, 2W, MOVING OPERATIONS - DAY ONLY |
| 701321-10 | LANE CLOSURE, 2L, 2W, BRIDGE REPAIR WITH BARRIER |
| 701901-01 | TRAFFIC CONTROL DEVICES |
| 704001-06 | TEMPORARY CONCRETE BARRIER |

STATE OF ILLINOIS
DEPARTMENT OF TRANSPORTATION
DIVISION OF HIGHWAYS
PROPOSED
HIGHWAY PLANS

FAP ROUTE 573 & 557 (US 30 & IL 72)
SECTION (116,128)T

DEKALB COUNTY
C-93-075-09
GRADING AND SHAPING DITCHES,
CULVERT REMOVAL/REPLACEMENT
& RECONSTRUCTION

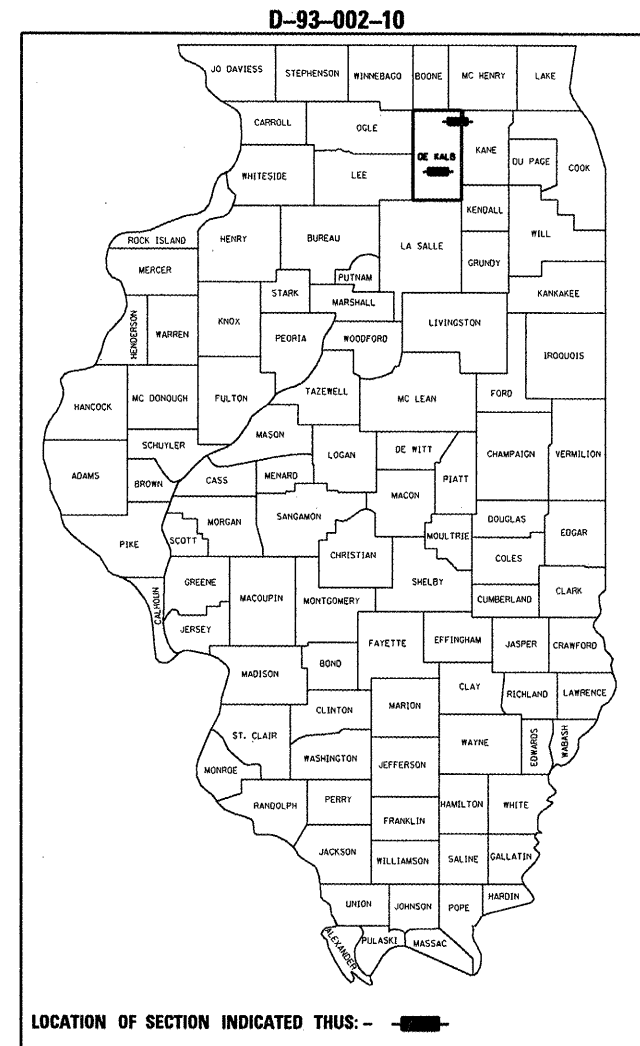

FUNCTIONAL CLASSIFICATION
RURAL - MINOR ARTERIAL
FAP ROUTE 573 (US 30)
2007 ADT = 4200
P.V. = 76.8% M.U. = 14.3% S.U. = 8.9%

FUNCTIONAL CLASSIFICATION
RURAL - OTHER PRINCIPAL ARTERIAL
FAP ROUTE 557 (IL 72)
2007 ADT = 6000
P.V. = 86.7% M.U. = 5.4% S.U. = 7.9%

STATE OF ILLINOIS
DEPARTMENT OF TRANSPORTATION
DIVISION OF HIGHWAYS

SUBMITTED 12-7 2009

George Hanson
DEPUTY DIRECTOR OF HIGHWAYS, REGION ENGINEER

January 09 20 10
Scott G. Stett P.E.
ACTING ENGINEER OF DESIGN AND ENVIRONMENT

January 09 20 10
Christine M. Reed
DIRECTOR OF HIGHWAYS, CHIEF ENGINEER

PROJECT BEGIN
INTERSECTION
IL 23 & US 30
STA. 638 + 70

PROJECT END
INTERSECTION
US 30 & CREGO ROAD
STA. 692 + 22

PROJECT BEGIN
EAST ABUT. S.N. 019-0033
STA. 144 + 70

PROJECT END
KANE COUNTY LINE
STA. 172 + 45

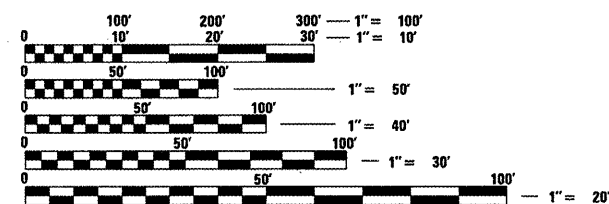

FULL SIZE PLANS HAVE BEEN PREPARED USING STANDARD ENGINEERING SCALES. REDUCED SIZED PLANS WILL NOT CONFORM TO STANDARD SCALES. IN MAKING MEASUREMENTS ON REDUCED PLANS, THE ABOVE SCALES MAY BE USED.

J.U.L.I.E.
JOINT UTILITY LOCATION INFORMATION FOR EXCAVATION
1-800-892-0123
OR 811

PROJECT ENGINEER: JOE KANNEL
UNIT CHIEF: RON WOODSHANK
TOWNSHIP: CLINTON AND GENOA
CONTRACT NO. 66939

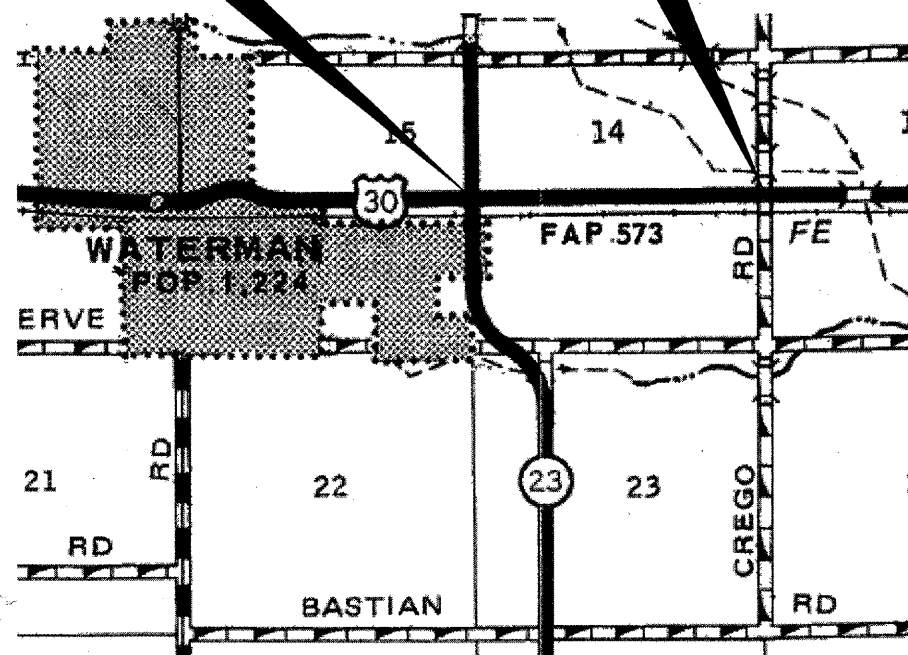

GROSS LENGTH = 5321 FT. = 1.00 MILE
NET LENGTH = 4650 FT. = 0.881 MILE

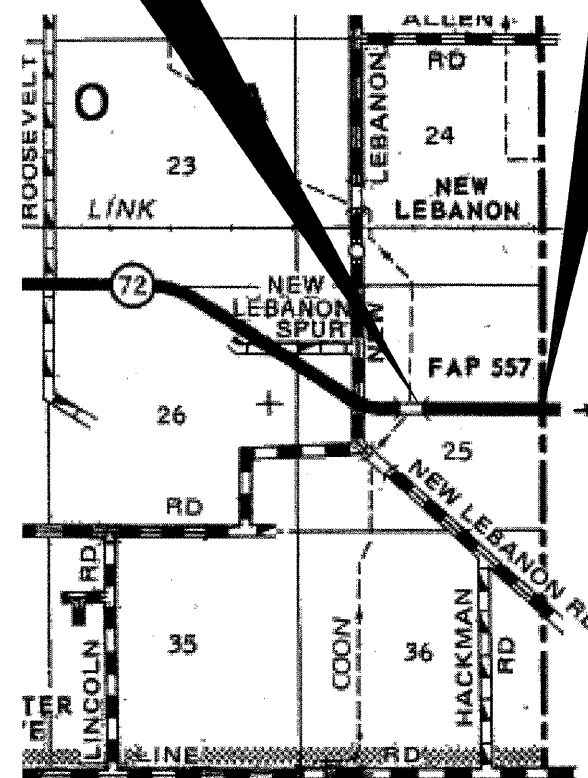

GROSS LENGTH = 2775 FT. = 0.526 MILE
NET LENGTH = 2775 FT. = 0.526 MILE

PRINTED BY THE AUTHORITY
OF THE STATE OF ILLINOIS