

Walkway and truss grating dimensions are nominal and may vary (width ± 1/2", depth ± 1/2") based on available standard widths.

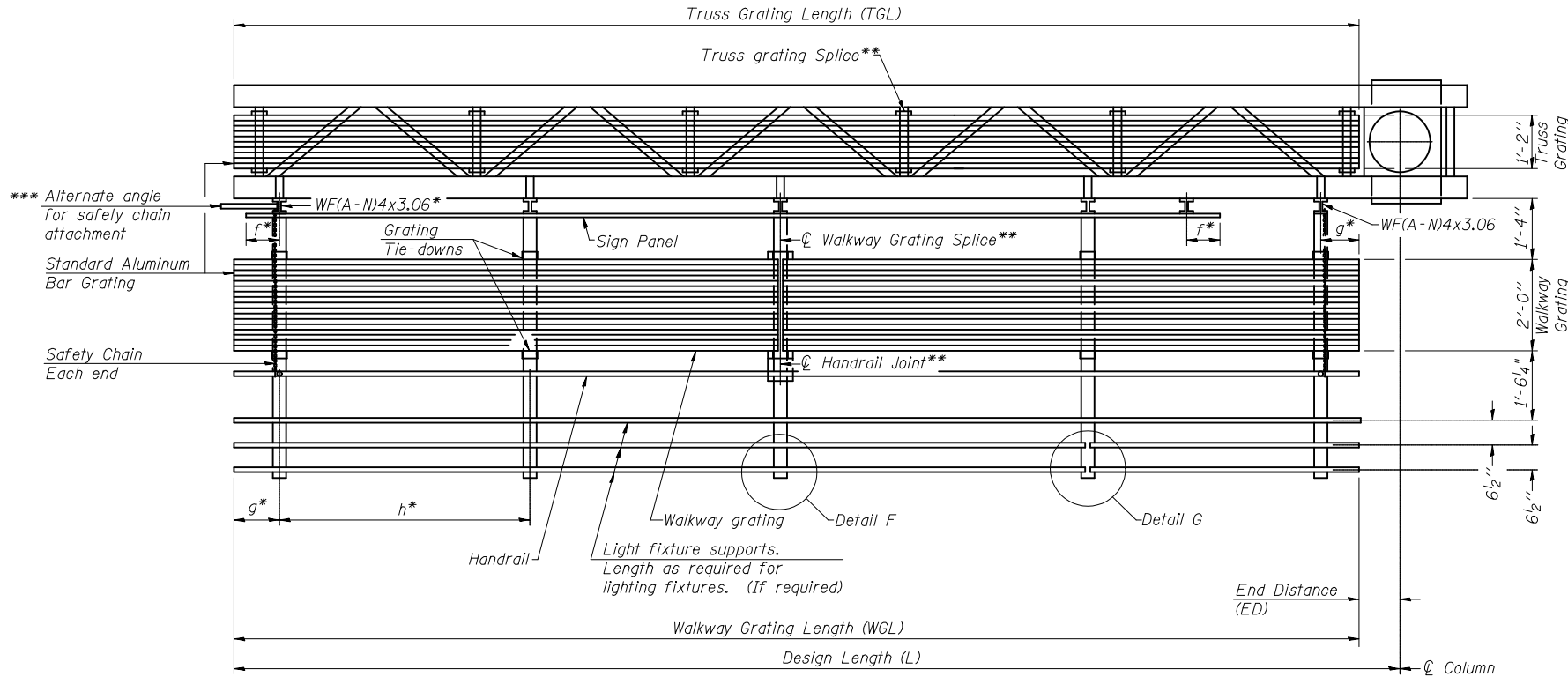
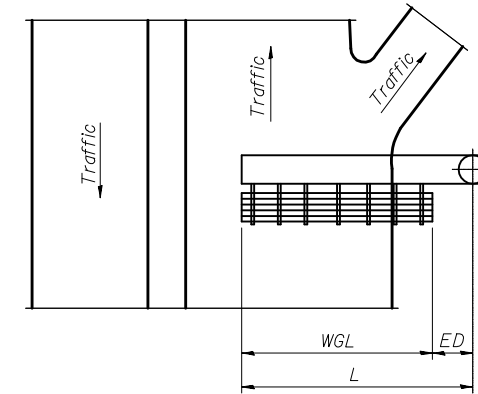

SECTION A-A

Truss grating to facilitate inspection shall run full length of cantilevers. Cost of truss grating is included in Overhead Sign Structure Cantilever.

Handrail and walkway grating shall span a minimum of three brackets between splices. ** Use and location of handrail joints or grating splices are optional, based on lengths needed and material availability.

$$TGL = L - \left(\frac{\text{Post O.D.}}{2} + 6'' \right)$$

NUMBER	REVISION	DATE

Structure Number	Station	WGL	ED	TGL
5 C 092 I074 R210.00	111+39	32'-0"	4'-0"	34'-6"
5 C 092 U150 L000.36	426+90	33'-0"	5'-0"	36'-6"

Notes:
 * Space walkway brackets WF(A-N)4x3.06 and sign brackets WF(A-N)4x1.79 for efficiency and within limits shown:
 f = 12" maximum, 4" minimum (End of sign to center of nearest bracket)
 g = 12" maximum, 4" minimum (End of walkway to center of nearest bracket)
 h = 6'-0" maximum (center to center sign and/or walkway support brackets, WF(A-N)4x1.79 or WF(A-N)4x3.06)
 *** If walkway bracket at safety chain location is behind sign, add angle to bracket. See alternate safety chain attachment on base sheet OSC-A-8.
 For details of sign placement, sign/walkway brackets, truss and walkway gratings, grating splices and Section B-B, see Base Sheet OSC-A-7.
 For details of handrail, handrail joint, safety chain and Details F and G, see Base Sheet OSC-A-8.

BRACKET TABLE

Sign Width		Number Brackets Required
Greater Than	Less Than or Equal To	
	8'-0"	2
8'-0"	14'-0"	3
14'-0"	20'-0"	4
20'-0"	26'-0"	5
26'-0"	32'-0"	6

OSC-A-6

12-1-08

FILE NAME =	USER NAME = bucklesjj	DESIGNED -	REVISED -
et:\pwork\p\WIDOT\BUCKLESJJ\d0132727.D	70315-sht-truss_details.dgn	DRAWN -	REVISED -
	PLOT SCALE = 40.0000' / IN.	CHECKED -	REVISED -
	PLOT DATE = 12/7/2009	DATE -	REVISED -

**STATE OF ILLINOIS
DEPARTMENT OF TRANSPORTATION**

**CANTILEVER SIGN STRUCTURES ALUMINUM WALKWAY DETAILS
ALUMINUM TRUSS & STEEL POST**

SCALE: SHEET NO. 1 OF 2 SHEETS STA. TO STA.

*FAU 7052 /FAP 729

F.A. RTE.	SECTION	COUNTY	TOTAL SHEETS	SHEET NO.
*	(36X,36X-1,34Z-3)RS-1	VERMILION	58	44
CONTRACT NO. 70315			ILLINOIS FED. AID PROJECT	