

STATE OF ILLINOIS
DEPARTMENT OF TRANSPORTATION

NORTH EDGE OF SHOULDER

Location	Station	Offset	Theoretical Grade Elevations	Theoretical Grade Elevations Adjusted For Grinding
W. End West Appr. Pav't.	1892+34.32	-16.00	717.22	717.24
A1	1892+44.32	-16.00	717.28	717.30
A2	1892+54.32	-16.00	717.33	717.35
E. End West Appr. Pav't.	1892+64.32	-16.00	717.38	717.40

NORTH EDGE OF PAVEMENT

Location	Station	Offset	Theoretical Grade Elevations	Theoretical Grade Elevations Adjusted For Grinding
W. End West Appr. Pav't.	1892+31.32	-13.00	717.26	717.28
A1	1892+41.32	-13.00	717.32	717.34
A2	1892+51.32	-13.00	717.38	717.40
E. End West Appr. Pav't.	1892+61.32	-13.00	717.43	717.45

☉ ROADWAY, PROFILE GRADE & STAGE CONST. JOINT

Location	Station	Offset	Theoretical Grade Elevations	Theoretical Grade Elevations Adjusted For Grinding
W. End West Appr. Pav't.	1892+18.32	0.00	717.36	717.38
A1	1892+28.32	0.00	717.44	717.46
A2	1892+38.32	0.00	717.51	717.53
E. End West Appr. Pav't.	1892+48.32	0.00	717.57	717.59

SOUTH EDGE OF PAVEMENT

Location	Station	Offset	Theoretical Grade Elevations	Theoretical Grade Elevations Adjusted For Grinding
W. End West Appr. Pav't.	1892+05.32	13.00	717.05	717.07
A1	1892+15.32	13.00	717.13	717.16
A2	1892+25.32	13.00	717.21	717.24
E. End West Appr. Pav't.	1892+35.32	13.00	717.29	717.31

SOUTH EDGE OF SHOULDER

Location	Station	Offset	Theoretical Grade Elevations	Theoretical Grade Elevations Adjusted For Grinding
W. End West Appr. Pav't.	1892+02.32	16.00	716.96	716.98
A1	1892+12.32	16.00	717.05	717.07
A2	1892+22.32	16.00	717.13	717.15
E. End West Appr. Pav't.	1892+32.32	16.00	717.20	717.22

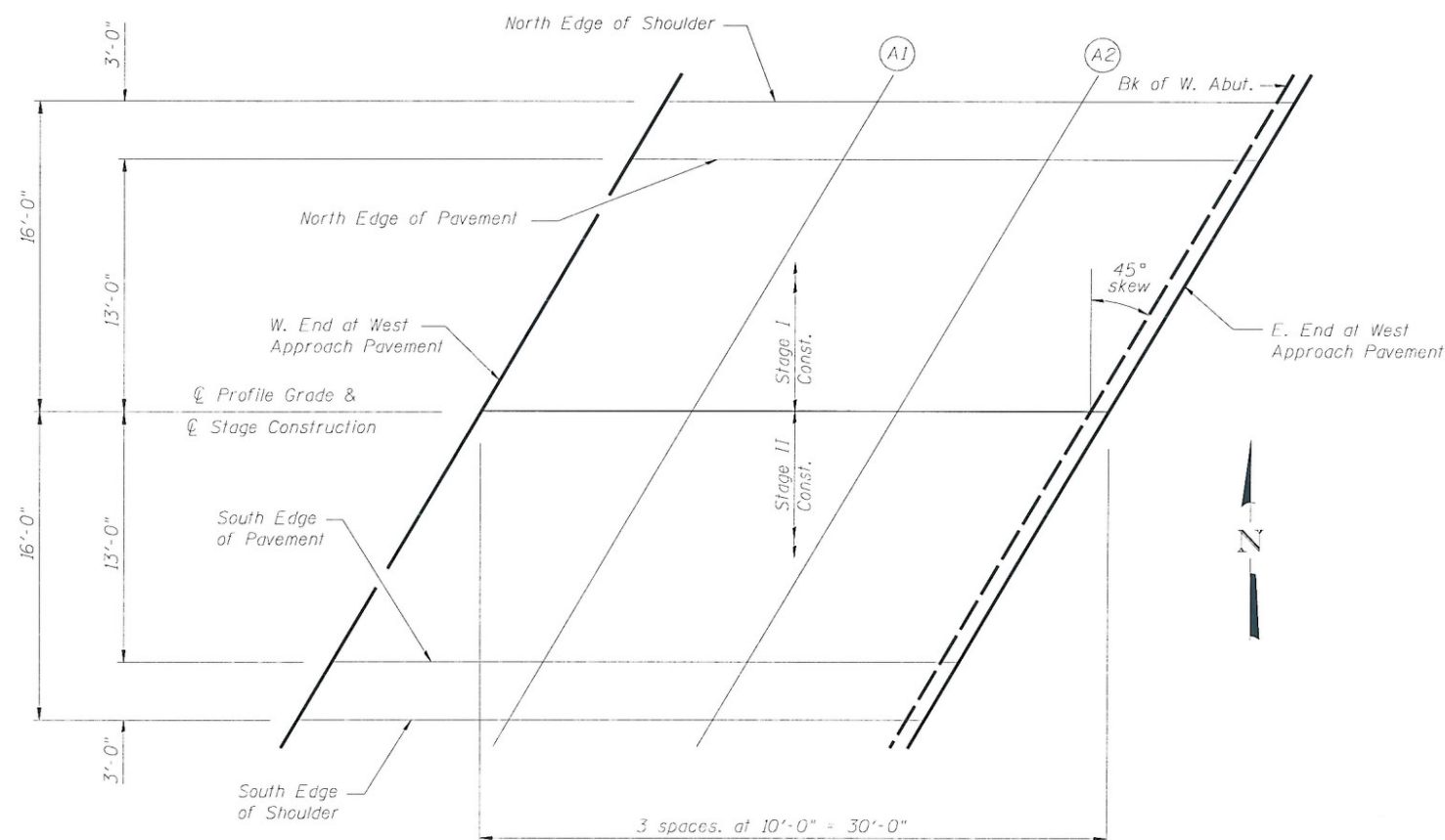

PLAN
West Approach

DESIGNED	JLG
CHECKED	CJC
DRAWN	UJ
CHECKED	JLG



**TOP OF WEST APPROACH SLAB ELEVATIONS
STRUCTURE NO. 010-0283**

SHEET NO. 7 24 SHEETS	F.A.P. RTE.	SECTION	COUNTY	TOTAL SHEETS	SHEET NO.
	709	(105BR)BR	CHAMPAIGN	55	19
SN 010-0283			CONTRACT NO. 70427		
FED. ROAD DIST. NO. 5 ILLINOIS FED. AID PROJECT					