

SEC. 34 - T 22 N - R 3 E - 3RD PM

SEC. 35 - T 22 N - R 3 E - 3RD PM

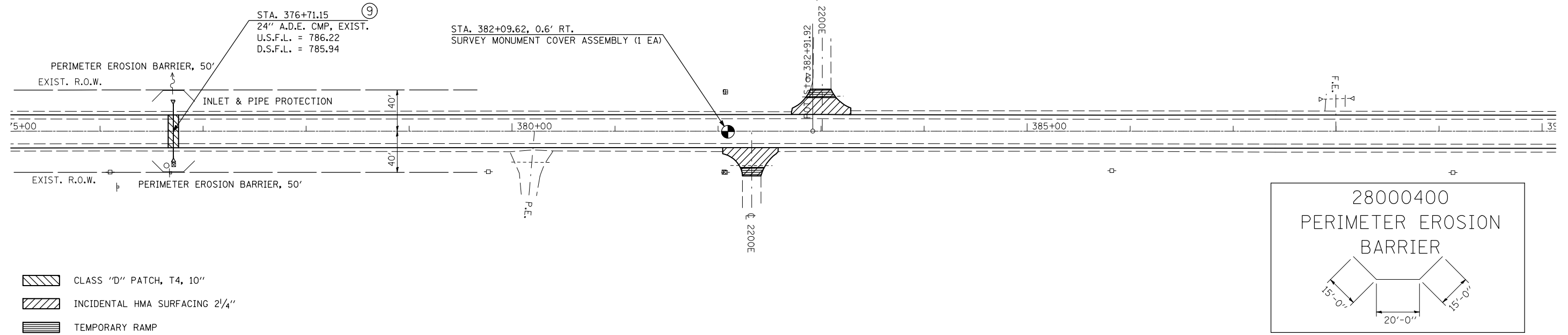

- CLASS "D" PATCH, T4, 10"
- INCIDENTAL HMA SURFACING 2 1/4"
- TEMPORARY RAMP

SEC. 3 - T 21 N - R 3 E - 3RD PM

SEC. 2 - T 21 N - R 3 E - 3RD PM

SEC. 35 - T 22 N - R 3 E - 3RD PM

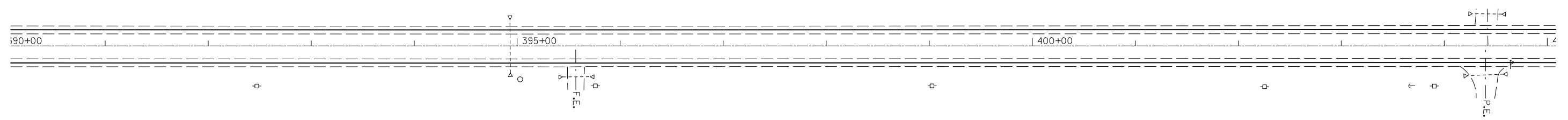

SEC. 2 - T 21 N - R 3 E - 3RD PM

FILE NAME =	USER NAME = bucklesjj	DESIGNED -	REVISED -	STATE OF ILLINOIS DEPARTMENT OF TRANSPORTATION	PLAN SHEET			F.A.P. RTE.	SECTION	COUNTY	TOTAL SHEETS	SHEET NO.
ct:\pw\work\p\dot\bucklesjj\d0170848\0570507-sh1-plen.dgn		DRAWN -	REVISED -		315		McLean	115	37			
PLOT SCALE = 100.0000' / IN.		CHECKED -	REVISED -		• (101,102X)R,RS-2 & 55RS-PRK LN			CONTRACT NO. 70507				
PLOT DATE = 12/9/2009		DATE -	REVISED -		ILLINOIS FED. AID PROJECT							
				SCALE:	SHEET NO.	OF SHEETS	STA.	TO STA.				