

AS-BUILT PATCHING PLAN S.N. 010-0082

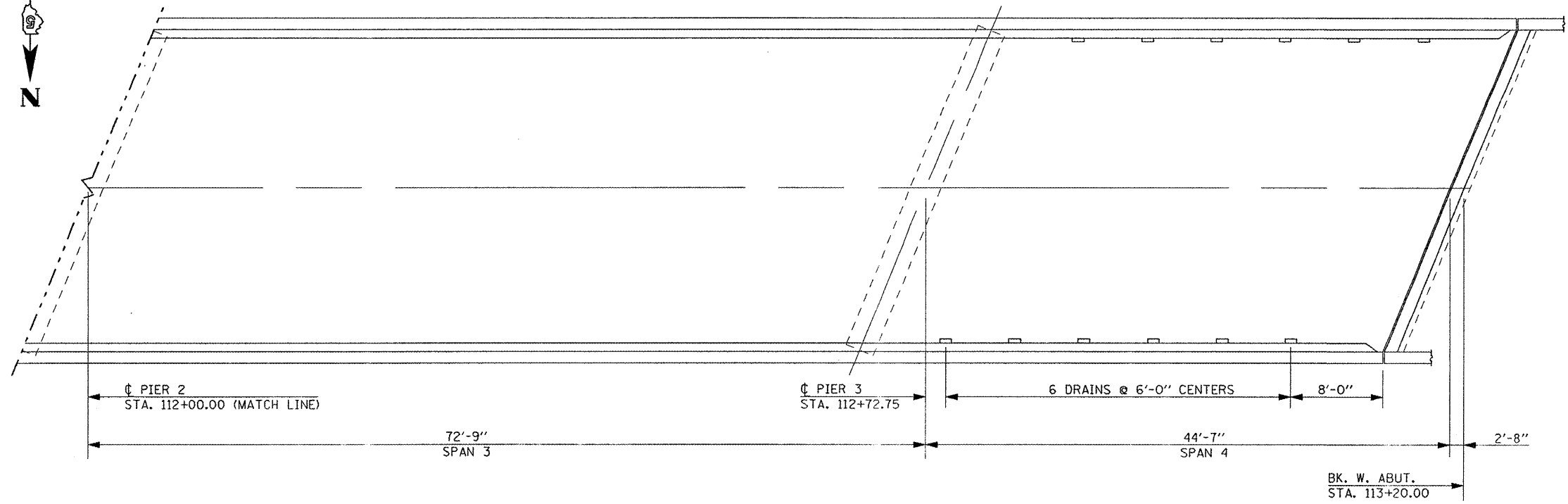
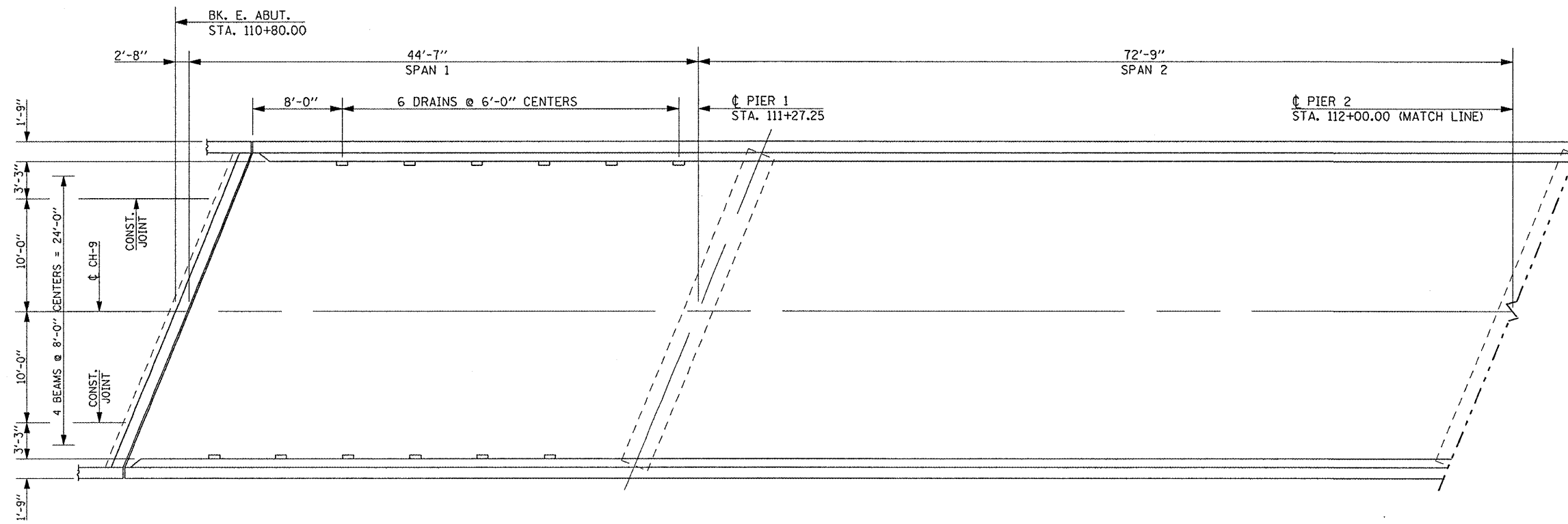

NOTE:
A PATCHING SURVEY WAS CONDUCTED AND THE PATCH SIZES AND LOCATIONS WERE PROVIDED ON THE PREVIOUS SHEET. ACTUAL SIZES AND LOCATIONS FOR THE FULL AND PARTIAL DEPTH PATCHING SHALL BE DETERMINED BY THE ENGINEER AND SHOWN ON THIS SHEET.

FILE NAME =	USER NAME = bawerml
c:\pwwork\pwwork\bowerm\ad0110023\70766	Bridge Repair Plan.dgn
PLOT SCALE = 40,0000' / IN.	PLOT DATE = 12/2/2009

DESIGNED	GMS	REVISED	-
DRAWN	GMS	REVISED	-
CHECKED	-	REVISED	-
DATE	-	REVISED	-

**STATE OF ILLINOIS
DEPARTMENT OF TRANSPORTATION**

AS-BUILT PATCHING PLAN S.N. 010-0082	
SCALE:	SHEET NO. 2 OF 8 SHEETS
STA.	TO STA.

F.A.I. RTE.	SECTION	COUNTY	TOTAL SHEETS	SHEET NO.
57	10-37RS-2&(10,27-38)RS-1	CHAMPAIGN	41	32
CONTRACT NO. 70766			ILLINOIS FED. AID PROJECT	