





LEGEND

-  BARRICADE OR DRUM W/STEADY BURNING LIGHT
-  BARRICADE OR DRUM W/FLASHING LIGHT
-  BARRICADE OR DRUM
-  FLAGGER
-  WORK AREA

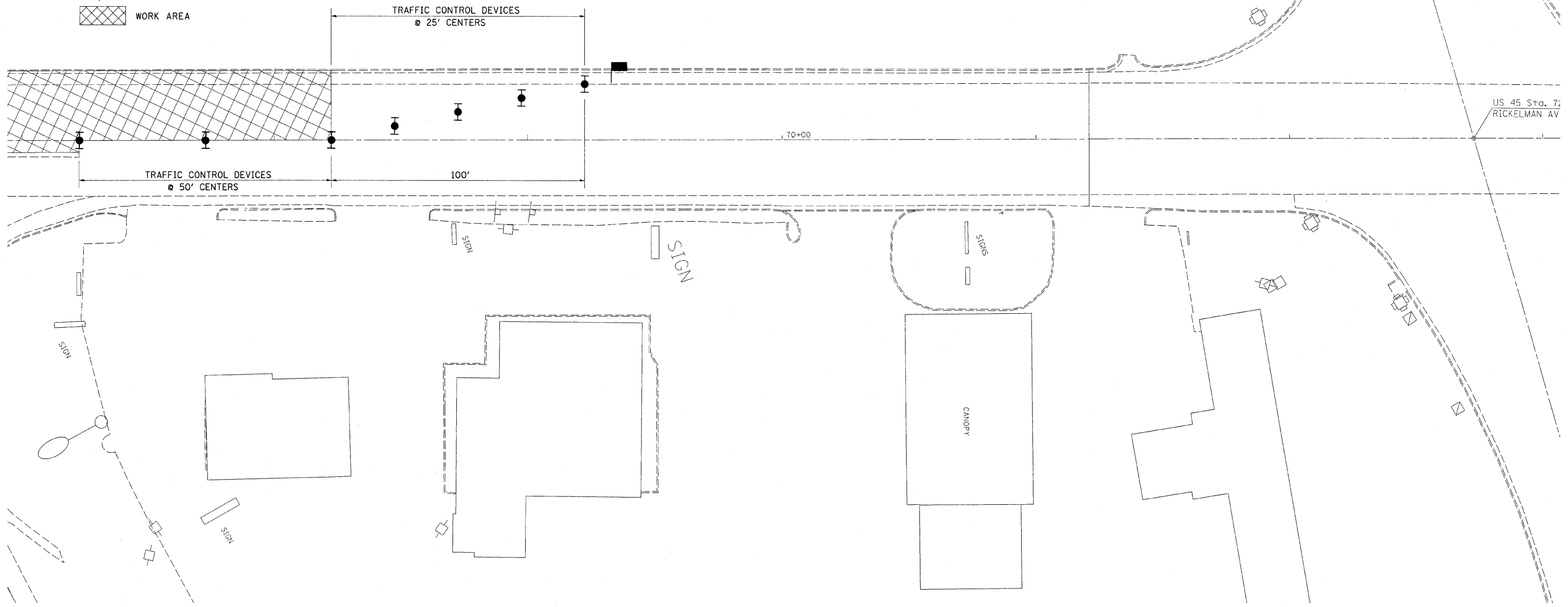

FILE NAME = c:\p\work\p\WIDOT\SWARTZRW\d0168672\d7	USER NAME = swartzrw 4430-sh-t-stg2.dgn	DESIGNED -	REVISED -	STATE OF ILLINOIS DEPARTMENT OF TRANSPORTATION	STAGE 2A TRAFFIC CONTROL TC&P STD 701206	F.A.P. RTE. 328	SECTION (12)RS-1	COUNTY EFFINGHAM	TOTAL SHEETS 54	SHEET NO. 34
PLOT SCALE = 20,0000 "/> IN.		CHECKED -	REVISED -	SCALE: 20		SHEET NO. 4 OF 4 SHEETS		STA. 67+00 TO STA. 73+00		CONTRACT NO. 74430
PLOT DATE = 12/11/2009		DATE -	REVISED -	ILLINOIS FED. AID PROJECT						