

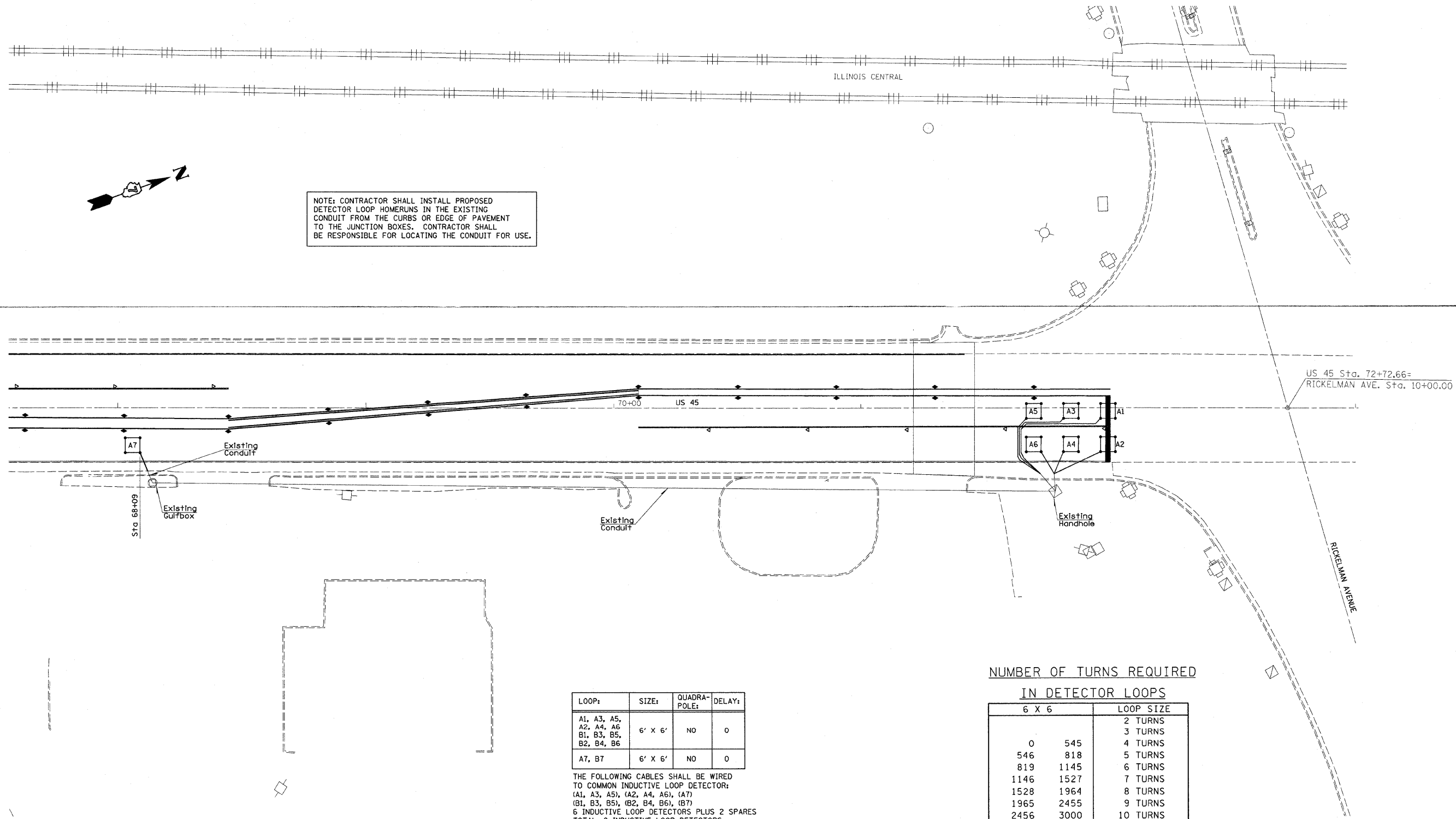

NOTE: CONTRACTOR SHALL INSTALL PROPOSED DETECTOR LOOP HOMERUNS IN THE EXISTING CONDUIT FROM THE CURBS OR EDGE OF PAVEMENT TO THE JUNCTION BOXES. CONTRACTOR SHALL BE RESPONSIBLE FOR LOCATING THE CONDUIT FOR USE.



| LOOP:   | SIZE:   | QUADRA-POLE: | DELAY: |
|---|---------|--------------|--------|
| A1, A3, A5, A2, A4, A6<br>B1, B3, B5,<br>B2, B4, B6 | 6' X 6' | NO           | 0      |
| A7, B7  | 6' X 6' | NO           | 0      |

THE FOLLOWING CABLES SHALL BE WIRED TO COMMON INDUCTIVE LOOP DETECTOR:  
(A1, A3, A5), (A2, A4, A6), (A7)  
(B1, B3, B5), (B2, B4, B6), (B7)  
6 INDUCTIVE LOOP DETECTORS PLUS 2 SPARES  
TOTAL: 8 INDUCTIVE LOOP DETECTORS

NUMBER OF TURNS REQUIRED  
IN DETECTOR LOOPS

| 6 X 6 |      | LOOP SIZE |
|-------|------|-----------|
|       |      | 2 TURNS   |
|       |      | 3 TURNS   |
| 0     | 545  | 4 TURNS   |
| 546   | 818  | 5 TURNS   |
| 819   | 1145 | 6 TURNS   |
| 1146  | 1527 | 7 TURNS   |
| 1528  | 1964 | 8 TURNS   |
| 1965  | 2455 | 9 TURNS   |
| 2456  | 3000 | 10 TURNS  |

THE NUMBERS IN THE TABLE REPRESENT THE LENGTH OF ELECTRIC CABLE FROM THE LOOP TO THE CABINET