

PLAN
STA. 17+35.7 RT

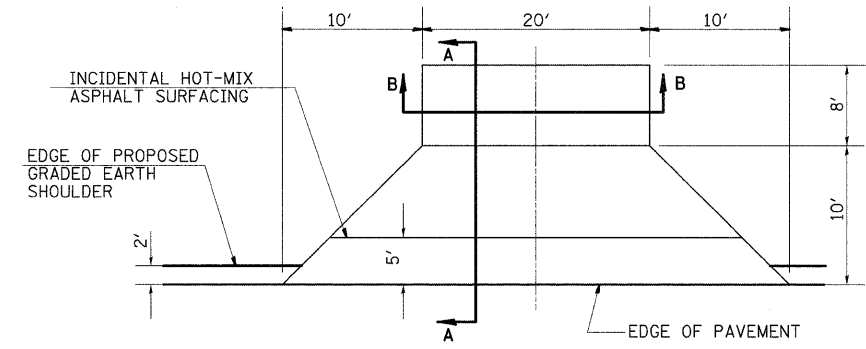

PLAN
STA. 21+89.6 RT

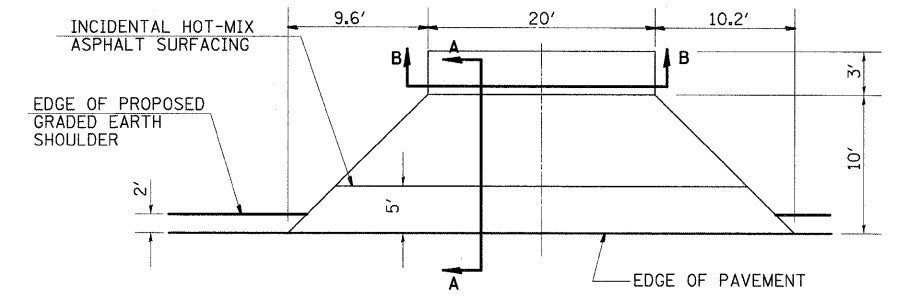

PLAN
STA. 21+95.7 LT

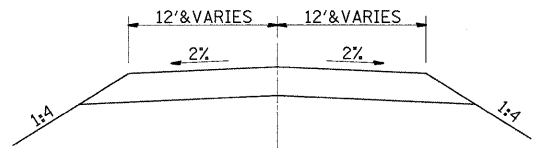

SECTION B-B

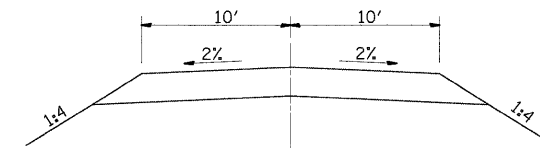

SECTION B-B

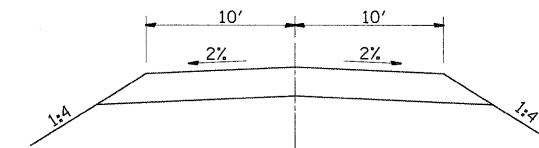

SECTION B-B

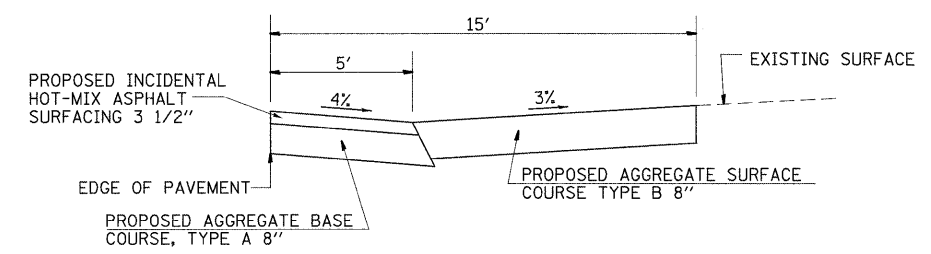

SECTION A-A

ENTRANCE DETAILS
UNMARKED ROUTE / SERVICE RD

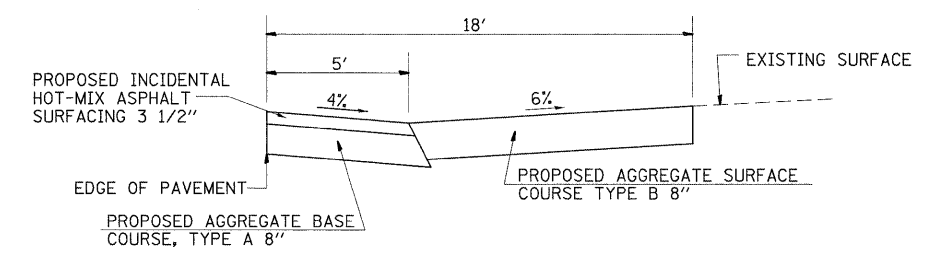

SECTION A-A

ENTRANCE DETAILS
UNMARKED ROUTE / SERVICE RD

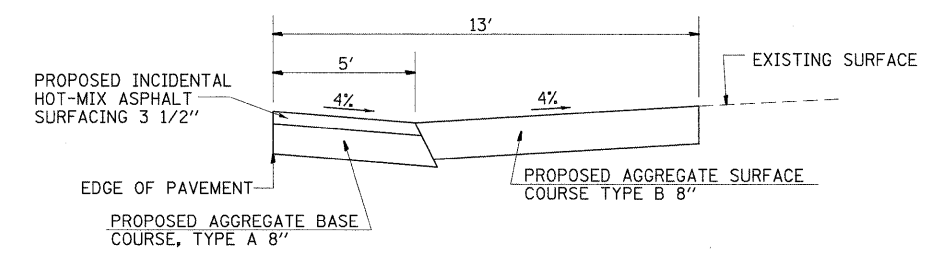

SECTION A-A

ENTRANCE DETAILS
UNMARKED ROUTE / SERVICE RD

NOTE: NOT TO SCALE

FILE NAME =	USER NAME = tharp1	DESIGNED - R. THARP	REVISED -	STATE OF ILLINOIS DEPARTMENT OF TRANSPORTATION	DETAIL SHEETS			OR&SBI	SECTION	COUNTY	TOTAL	SHEET
ct:\pwork\p\WIDOT\THARP\l\dms52424\087	132-details.dgn	DRAWN - R. THARP	REVISED -		322&2	95-AC & 32B-I	WASHINGTON	63	48			
PLOT SCALE = 50.0000' / IN.		CHECKED - A. MUEHLFELD	REVISED -		CONTRACT NO. 76132							
PLOT DATE = 12/18/2009		DATE - 12/8/2009	REVISED -		FED. ROAD DIST. NO.	ILLINOIS	FED. AID PROJECT					
				SCALE:	SHEET NO. 1 OF 3 SHEETS	STA.	TO STA.					