

F.A.P. RTE.	SECTION	COUNTY	TOTAL SHEETS	SHEET NO.
310	60-15HB-3	MADISON	93	93
STA.		TO STA.		
FED. ROAD DIST. NO.	ILLINOIS	FED. AID PROJECT		
CONTRACT NO. 76706				

DATE	BY
REVISIONS	
NO.	DESCRIPTION
NO.	DESCRIPTION

DATE	BY
REVISIONS	
NO.	DESCRIPTION
NO.	DESCRIPTION

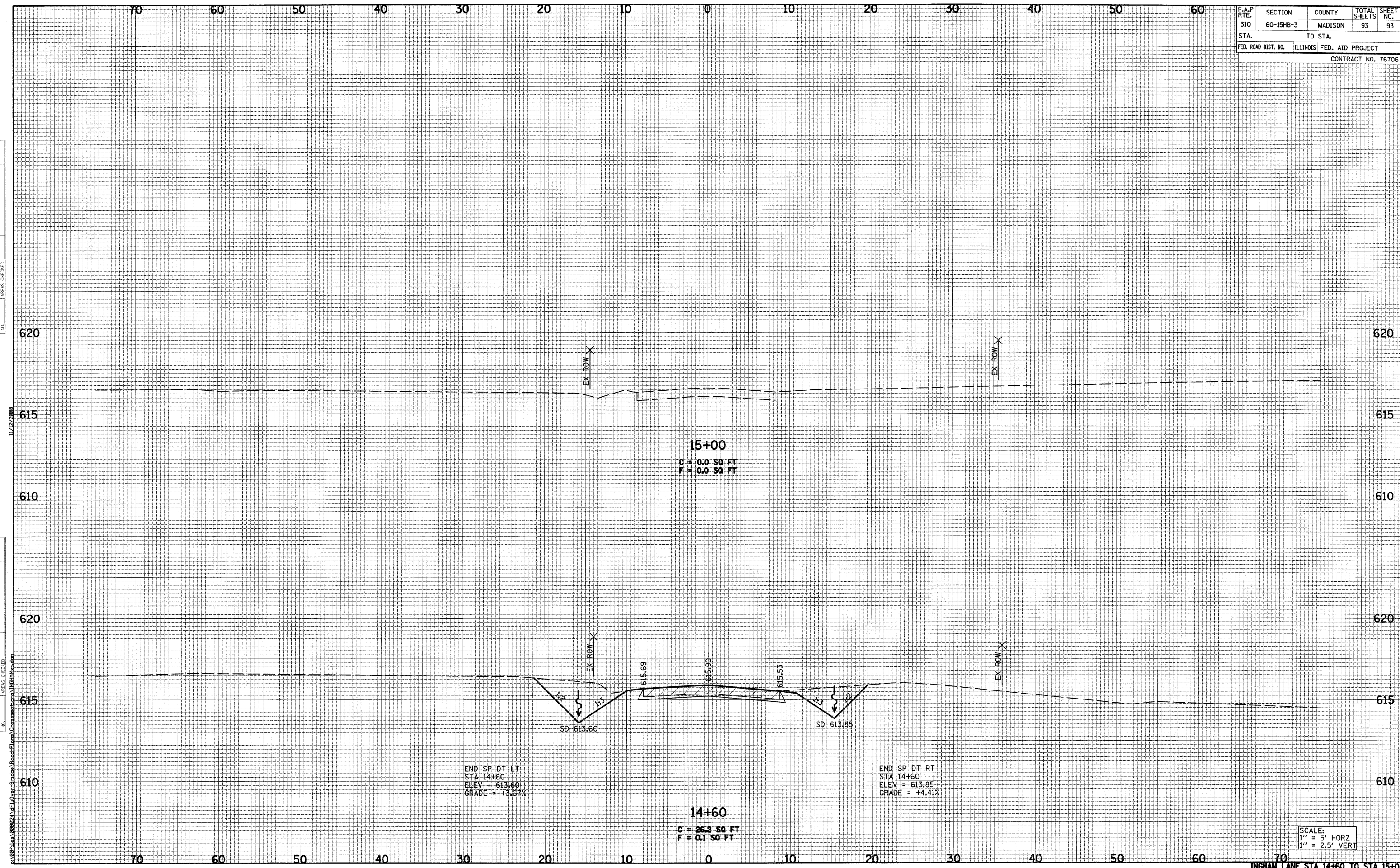

END SP-DT LT
 STA 14+60
 ELEV = 613.60
 GRADE = +3.61%

END SP-DT RT
 STA 14+60
 ELEV = 613.85
 GRADE = +4.41%

14+60
 C = 26.2 SQ FT
 F = 0.1 SQ FT

SCALE:
 1" = 5' HORZ
 1" = 2.5' VERT