

PLAN	SURVEYED	BY	DATE
	NOTED		
	PLOTTED		
	CHECKED		
	BY		
	NO.		
	DATE		

NOTES:
 1. EXISTING UTILITIES ARE SHOWN FOR INFORMATION PURPOSES ONLY. ALL LOCATIONS AND ELEVATIONS ARE APPROXIMATE. UTILITIES IN ADDITION TO THOSE SHOWN MAY BE PRESENT. THE CONTRACTOR SHALL FIELD VERIFY THE LOCATION OF ALL UTILITIES BEFORE STARTING CONSTRUCTION.
 2. THE EXISTING WATER SERVICE LINES SHOWN ARE FOR INFORMATION PURPOSES ONLY. ALL SIZES, LOCATIONS, AND LENGTHS ARE APPROXIMATE. WATER SERVICE LINES IN ADDITION TO THOSE SHOWN MAY BE PRESENT. THE CONTRACTOR SHALL FIELD VERIFY THE SIZE, LOCATION, AND LENGTH OF ALL WATER SERVICES LINES PRIOR TO THE START OF CONSTRUCTION.

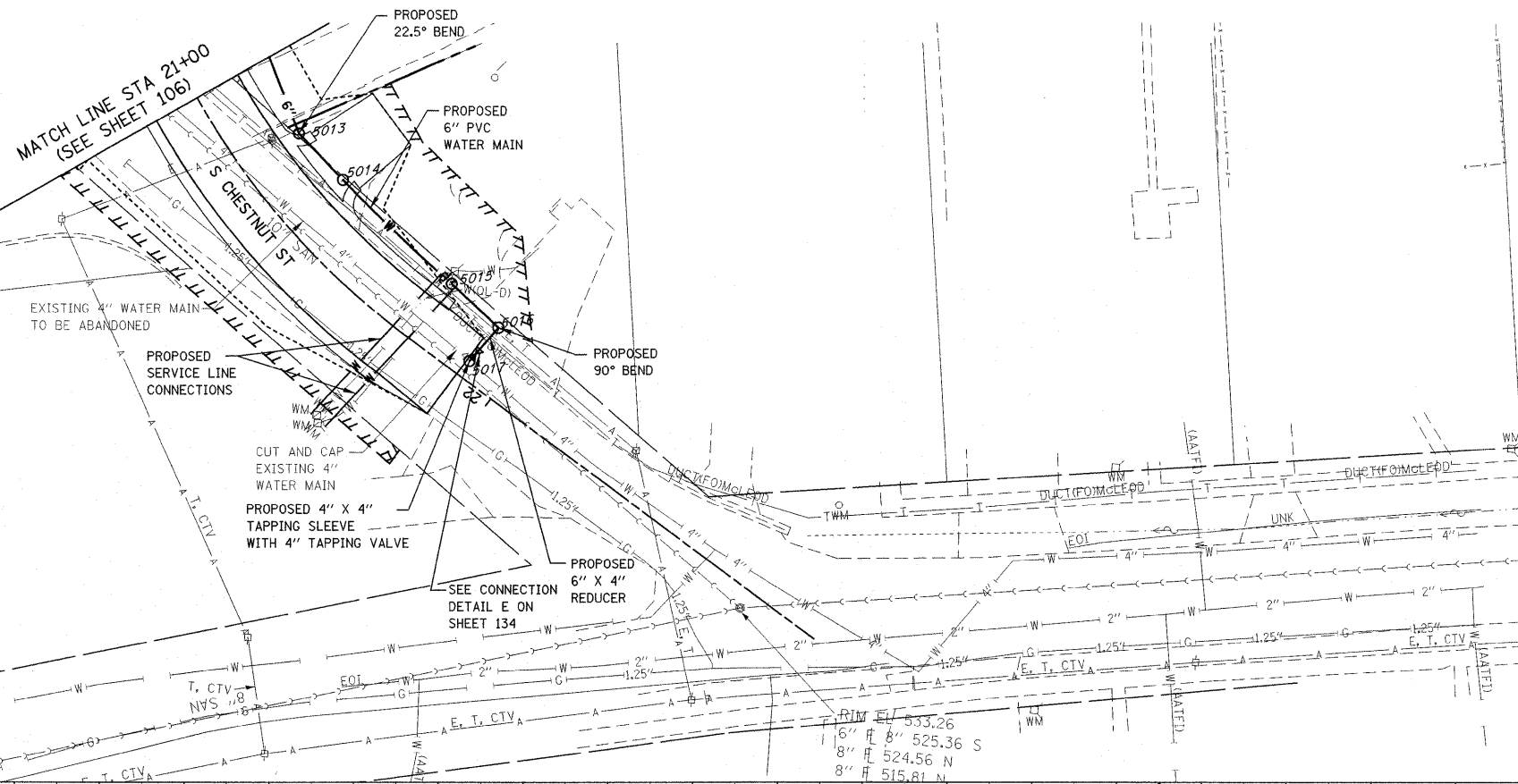

PROFILE	SURVEYED	BY	DATE
	NOTED		
	PLOTTED		
	CHECKED		
	BY		
	NO.		
	DATE		

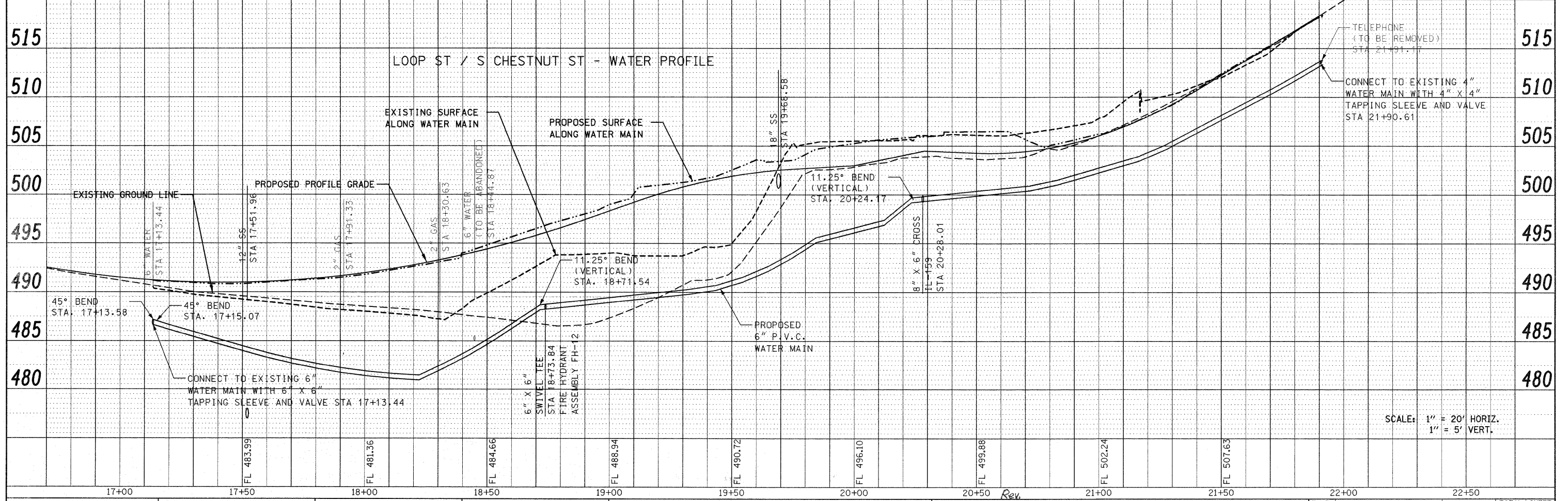

SCALE: 1" = 20' HORIZ.
 1" = 5' VERT.

FILE NAME =	USER NAME = default	DESIGNED -	REVISED -	STATE OF ILLINOIS DEPARTMENT OF TRANSPORTATION	DRAINAGE AND UTILITY SIDE ROAD PLAN/PROFILE LOOP ST./S. CHESTNUT ST.	F.A.P. RTE.	SECTION	COUNTY	TOTAL SHEETS	SHEET NO.
pi:\projects\513501\cadd\dgn\0875830-sh1-d	am:side_road.dgn	DRAWN -	REVISED -			600	60-(30,31,128)-1	MADISON/ST. CLAIR	399	127
PLOT SCALE = 20,0000 / / IN.		CHECKED -	REVISED -			CONTRACT NO.				
PLOT DATE = 12/17/2009		DATE -	REVISED -			FED. ROAD DIST. NO. ILLINOIS FED. AID PROJECT				