

KEY

- ✕ TREES TO BE REMOVED
- AS 2-1/2" TREE, ACER SACCHARUM (SUGAR MAPLE),
2-1/2" CALIPER, BALLED AND BURLAPPED
- OP 2-1/2" TREE, QUERCUS PALUSTRIS (PIN OAK),
2-1/2" CALIPER, BALLED AND BURLAPPED
- OR 2-1/2" TREE, QUERCUS RUBRA (RED OAK),
2-1/2" CALIPER, BALLED AND BURLAPPED
- CC 2" TREE, CERCIS CANADENSIS (EASTERN REDBUD),
2" CALIPER, TREE FORM, BALLED AND BURLAPPED
- MS 2" TREE, MALUS SNOWDRIFT (SNOWDRIFT CRAB APPLE),
2" CALIPER, TREE FORM, BALLED AND BURLAPPED
- PS 3" EVERGREEN, PINUS STROBUS (EASTERN WHITE PINE),
3" CALIPER, BALLED AND BURLAPPED

MATCH LINE 145+50.00

MATCH LINE 151+00.00

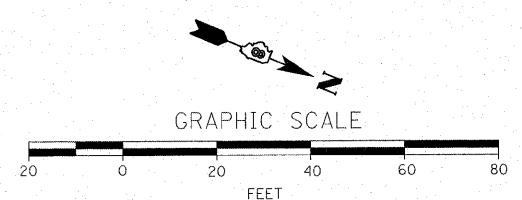
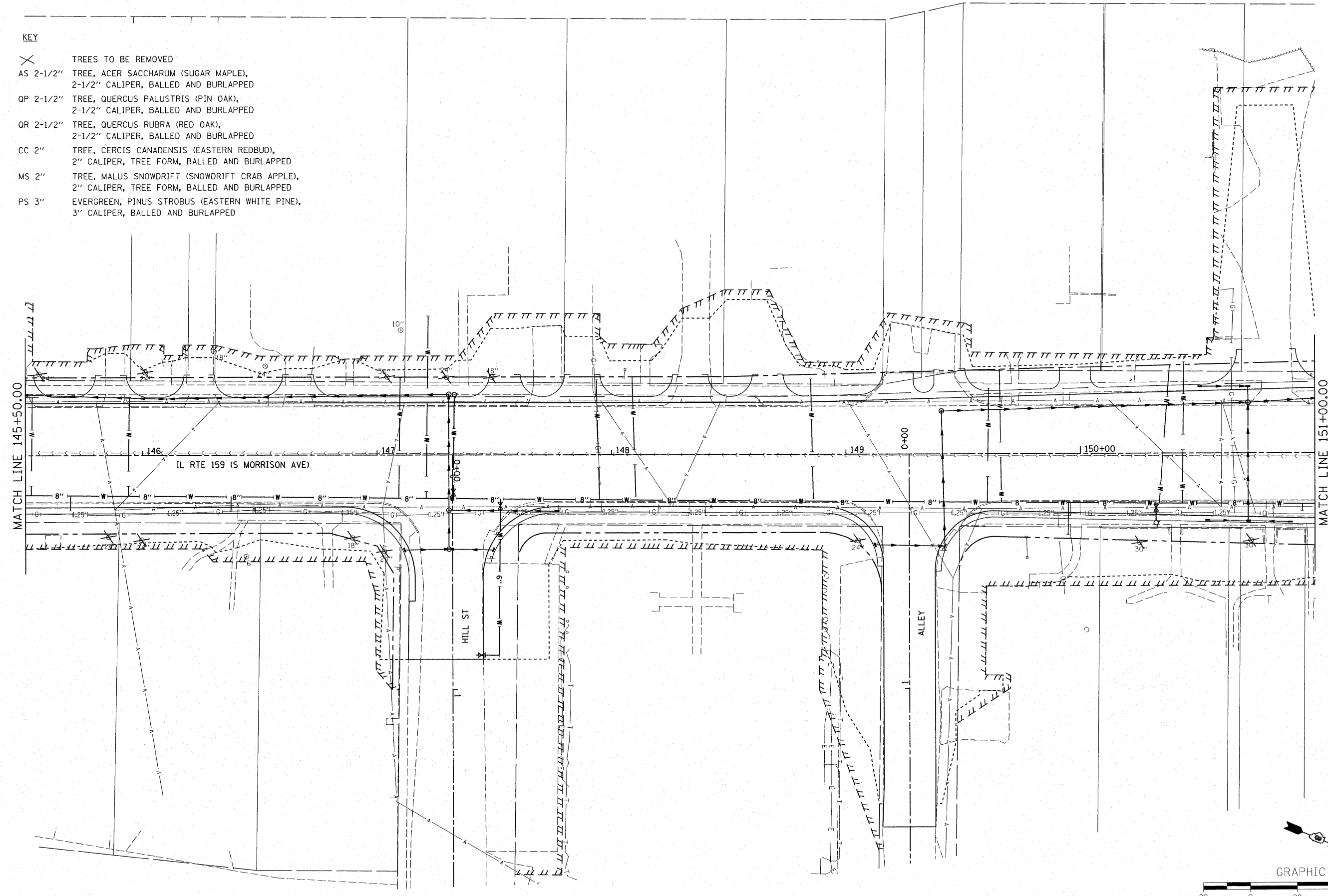

FILE NAME =
D876830-sht-1ndscp.dgn

USER NAME = cha
PLOT SCALE = 1:20
PLOT DATE = 6/24/2009

DESIGNED -	REVISED -
DRAWN -	REVISED -
CHECKED -	REVISED -
DATE -	REVISED -

**STATE OF ILLINOIS
DEPARTMENT OF TRANSPORTATION**

LANDSCAPE PLAN

SCALE: 1:20 SHEET NO. OF SHEETS STA. 145+50.00 TO STA. 151+00.00

F.A. RTE.	SECTION	COUNTY	TOTAL SHEETS	SHEET NO.
600	60-(30,31,128)-1		399	237
FED. ROAD DIST. NO.		ILLINOIS FED. AID PROJECT		

CONTRACT NO. 76830