

DATE	
BY	
FINAL SURVEY	SURVEYED
NOTE BOOK NO.	TEMPLATE AREAS CHECKED

DATE	
BY	
ORIGINAL SURVEY	SURVEYED
NOTE BOOK NO.	TEMPLATE AREAS CHECKED

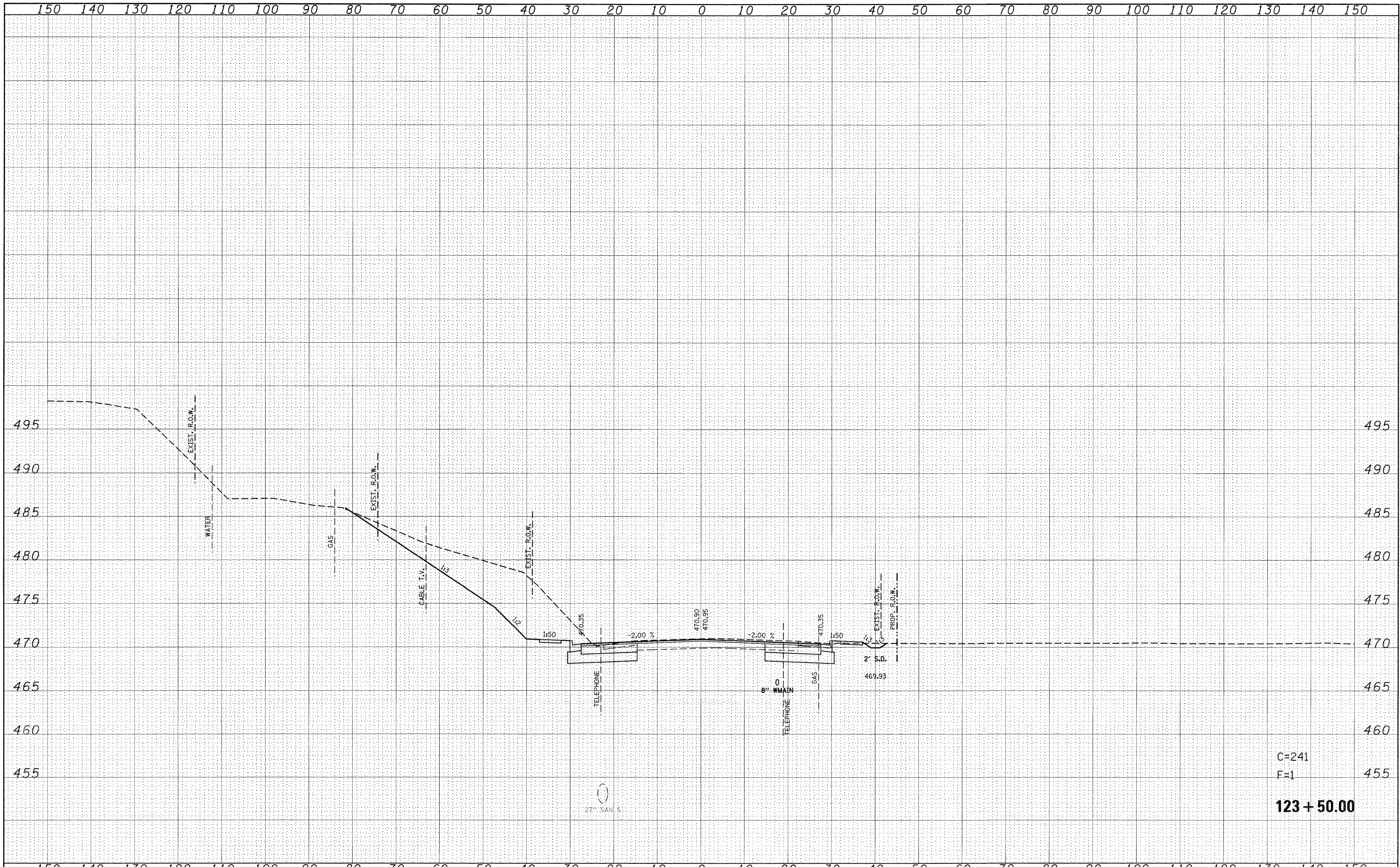

C=241
F=1
123 + 50.00

FILE NAME =	USER NAME = default	DESIGNED -	REVISED -	STATE OF ILLINOIS DEPARTMENT OF TRANSPORTATION	IL ROUTE 159 MAINLINE CROSS SECTIONS			F.A.P. RTE.	SECTION	COUNTY	TOTAL SHEETS	SHEET NO.	
p:\projects\1513501\cadd\dgn\123+50.00-1.dgn	159.dgn	DRAWN -	REVISED -		SCALE:	SHEET NO. 28 OF 120 SHEETS	STA. 123+50.00 TO STA. 123+50.00	600	60-(30,31,128)-1	ST. CLAIR/MADISON	399	307	
	PLOT SCALE = 10,0000 ' / IN.	CHECKED -	REVISED -										CONTRACT NO. 76830
	PLOT DATE = 8/24/2009	DATE -	REVISED -										ILLINOIS FED. AID PROJECT