

FINAL SURVEY	DATE
SURVEYED	BY
NOTE BOOK	NO.
TEMPLATE	AREAS CHECKED

ORIGINAL SURVEY	DATE
SURVEYED	BY
NOTE BOOK	NO.
TEMPLATE	AREAS CHECKED

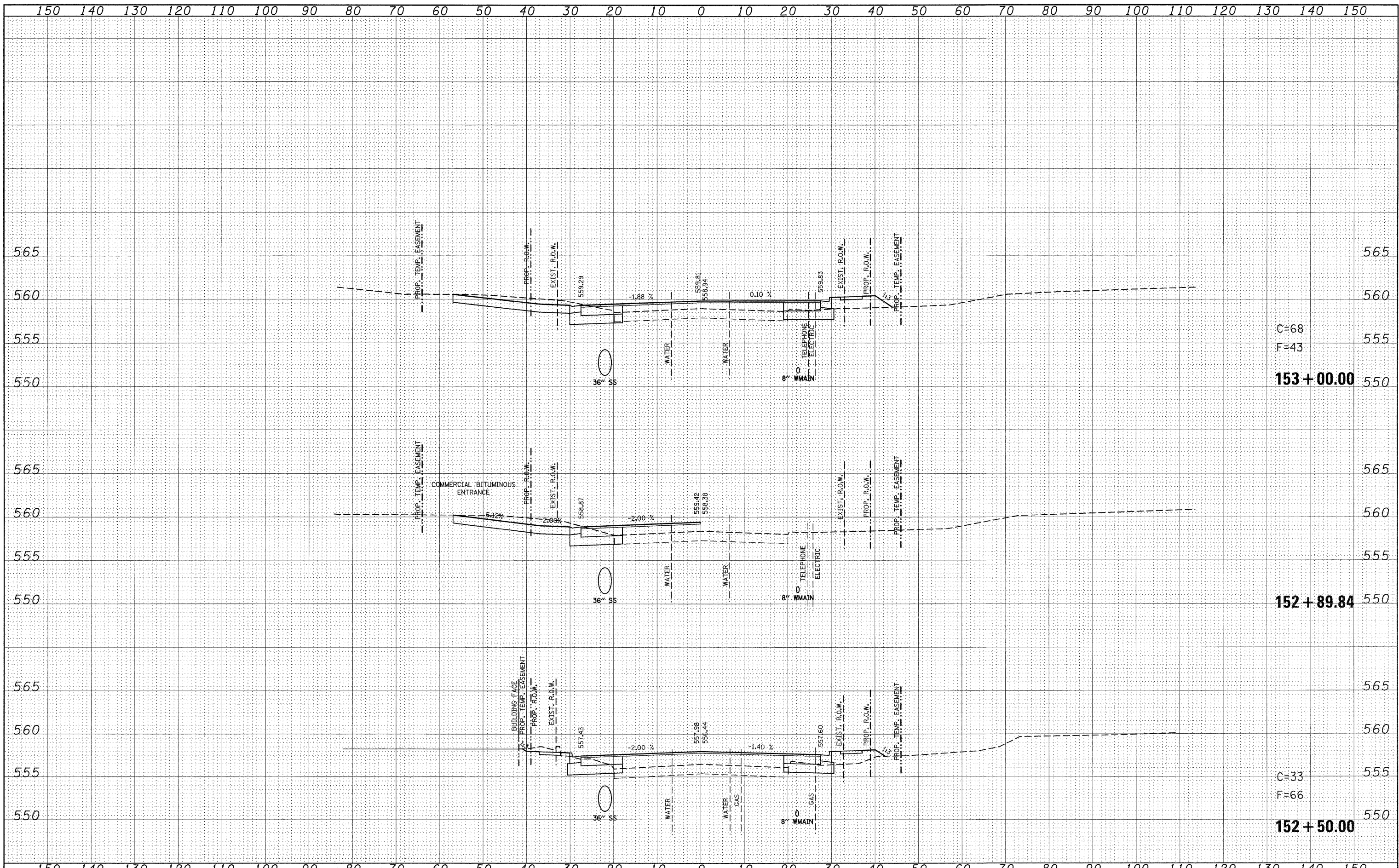

C=68
F=43

153+00.00

152+89.84

C=33
F=66

152+50.00

FILE NAME =	USER NAME = default	DESIGNED -	REVISED -	STATE OF ILLINOIS DEPARTMENT OF TRANSPORTATION	IL ROUTE 159 MAINLINE CROSS SECTIONS			F.A.P. RTE.	SECTION	COUNTY	TOTAL SHEETS	SHEET NO.
p:\projects\1513501\cadd\dgn\0876630-sht-wsht-1159.dgn		DRAWN -	REVISED -		600	60-(30,31,128)-1	ST. CLAIR/MADISON	399	346			
PLOT SCALE = 10,0000 ' / IN.		CHECKED -	REVISED -		SCALE: SHEET NO. 67 OF 120 SHEETS STA. 152+50.00 TO STA. 153+00.00				CONTRACT NO. 76830			
PLOT DATE = 8/24/2009		DATE -	REVISED -		ILLINOIS FED. AID PROJECT							