

EXIST. CURVE C108  
 PI STA. = 27+47.92  
 $\Delta = 13^\circ 18' 44''$  (RT)  
 $D = 7^\circ 40' 32''$   
 $R = 746.46'$   
 $T = 87.11'$   
 $L = 173.43'$   
 $E = 5.07'$   
 $e = \text{-----}$   
 $T.R. = \text{-----}$   
 $S.E. RUN = \text{-----}$   
 $P.C. STA. = 26+60.81$   
 $P.T. STA. = 28+34.25$

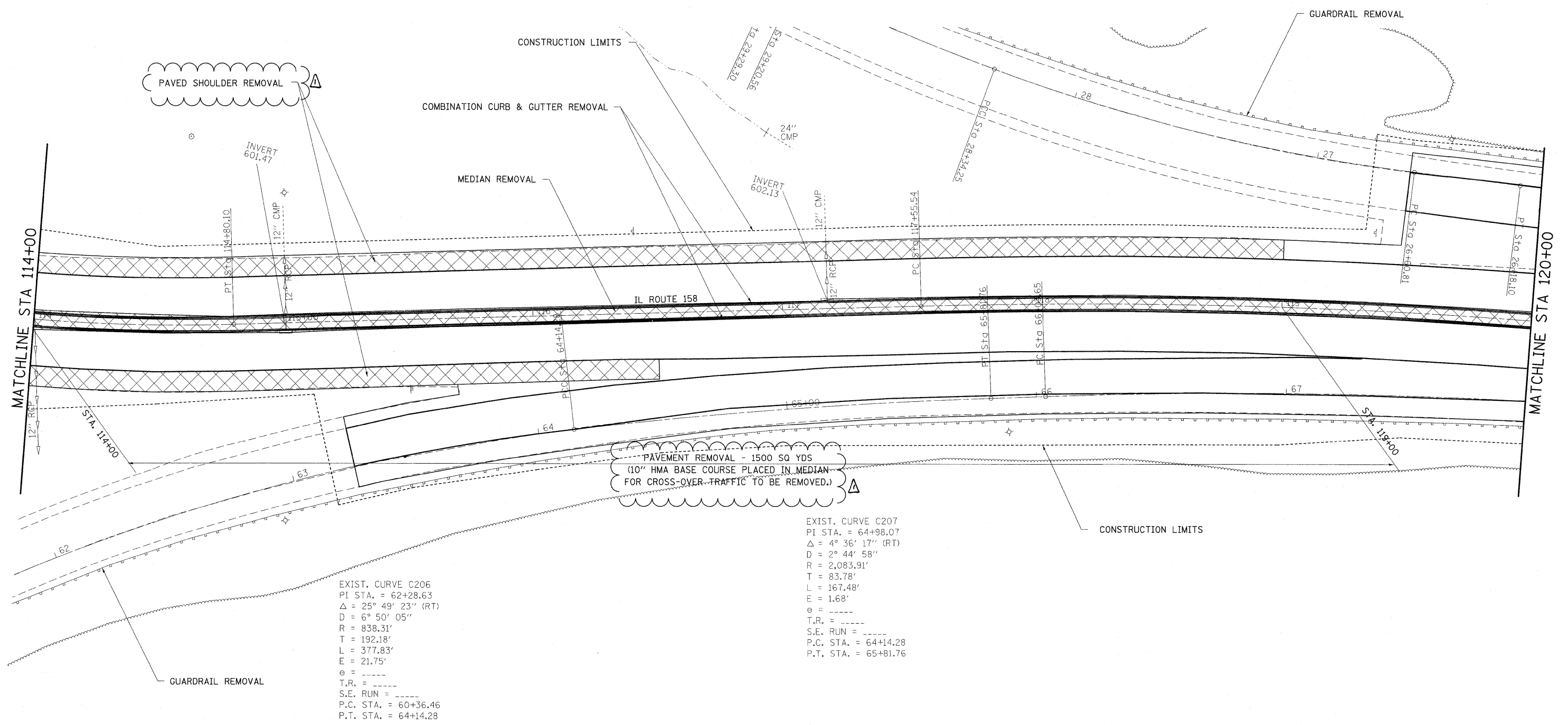
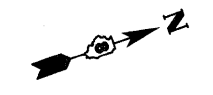

EXIST. CURVE C206  
 PI STA. = 62+28.63  
 $\Delta = 25^\circ 49' 23''$  (RT)  
 $D = 6^\circ 50' 05''$   
 $R = 838.31'$   
 $T = 192.18'$   
 $L = 377.83'$   
 $E = 21.75'$   
 $e = \text{-----}$   
 $T.R. = \text{-----}$   
 $S.E. RUN = \text{-----}$   
 $P.C. STA. = 60+36.46$   
 $P.T. STA. = 64+14.28$

EXIST. CURVE C207  
 PI STA. = 64+98.07  
 $\Delta = 4^\circ 36' 17''$  (RT)  
 $D = 2^\circ 44' 58''$   
 $R = 2,083.91'$   
 $T = 83.78'$   
 $L = 167.48'$   
 $E = 1.68'$   
 $e = \text{-----}$   
 $T.R. = \text{-----}$   
 $S.E. RUN = \text{-----}$   
 $P.C. STA. = 64+14.28$   
 $P.T. STA. = 65+81.76$

NOTE: "PAVED SHOULDER REMOVAL" REMOVES EXISTING SHOULDER FOR PLACEMENT OF 11" HMA BASE COURSE FOR STAGE CONSTRUCTION TRAFFIC.  
 STAGE I REMOVE TO EXISTING STRUCTURE; STA 112+00 TO STA 116+50 RIGHT  
 STAGE II ONLY REMOVE AREA IN CONFLICT; STA 114+00 TO STA 119+00 LEFT

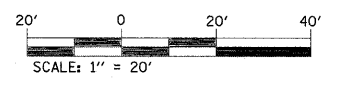

FILE NAME =	USER NAME = owerbj	DESIGNED -	REVISED -	<b>STATE OF ILLINOIS DEPARTMENT OF TRANSPORTATION</b>	<b>REMOVAL PLAN</b>			F.A.P. RTE.	SECTION	COUNTY	TOTAL SHEETS	SHEET NO.
c:\pwwork\pwwork\owner\j\dms52558\p1n000006a.dgn	PLOT SCALE = 20.0000' / IN.	DRAWN -	REVISED -					809	67-1HBR	MONROE	144	45
PLOT DATE = 2/8/2010	DATE -	CHECKED -	REVISED -					CONTRACT NO. 76977				
		DATE -	REVISED -					FED. ROAD DIST. NO. ILLINOIS FED. AID PROJECT				

Rev. 2-11-10