

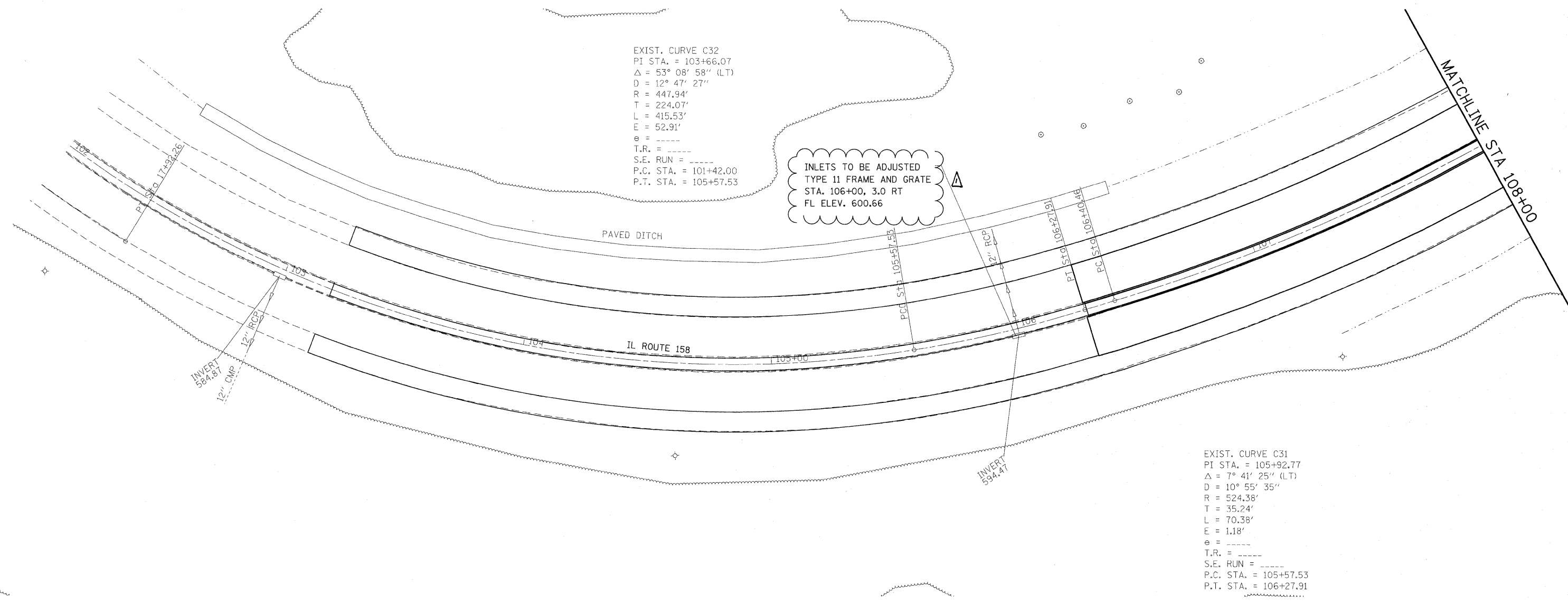

EXIST. CURVE C32  
 PI STA. = 103+66.07  
 $\Delta = 53^\circ 08' 58''$  (LT)  
 D = 12° 47' 27"  
 R = 447.94'  
 T = 224.07'  
 L = 415.53'  
 E = 52.91'  
 e = -----  
 T.R. = -----  
 S.E. RUN = -----  
 P.C. STA. = 101+42.00  
 P.T. STA. = 105+57.53

INLETS TO BE ADJUSTED  
 TYPE 11 FRAME AND GRATE  
 STA. 106+00, 3.0 RT  
 FL ELEV. 600.66

EXIST. CURVE C31  
 PI STA. = 105+92.77  
 $\Delta = 7^\circ 41' 25''$  (LT)  
 D = 10° 55' 35"  
 R = 524.38'  
 T = 35.24'  
 L = 70.38'  
 E = 1.18'  
 e = -----  
 T.R. = -----  
 S.E. RUN = -----  
 P.C. STA. = 105+57.53  
 P.T. STA. = 106+27.91



FILE NAME =	USER NAME = owenbj	DESIGNED -	REVISED -
ct:\pwork\p1dot\owenbj\dms52558\p1n2006.dgn		DRAWN -	REVISED -
	PLOT SCALE = 20.0000' / 1"	CHECKED -	REVISED -
	PLOT DATE = 2/5/2010	DATE -	REVISED -

**STATE OF ILLINOIS  
 DEPARTMENT OF TRANSPORTATION**

**DRAINAGE PLAN**

SCALE: SHEET NO. OF SHEETS STA. TO STA.

Rev. 7-11-10

F.A.P. RTE.	SECTION	COUNTY	TOTAL SHEETS	SHEET NO.
809	67-1HBR	MONROE	144	48
FED. ROAD DIST. NO. ILLINOIS FED. AID PROJECT			CONTRACT NO. 76977	