

EXIST. CURVE C108
 PI STA. = 27+47.92
 $\Delta = 13^\circ 18' 44''$ (RT)
 D = 7° 40' 32"
 R = 746.46'
 T = 87.11'
 L = 173.43'
 E = 5.07'
 e = -----
 T.R. = -----
 S.E. RUN = -----
 P.C. STA. = 26+60.81
 P.T. STA. = 28+34.25

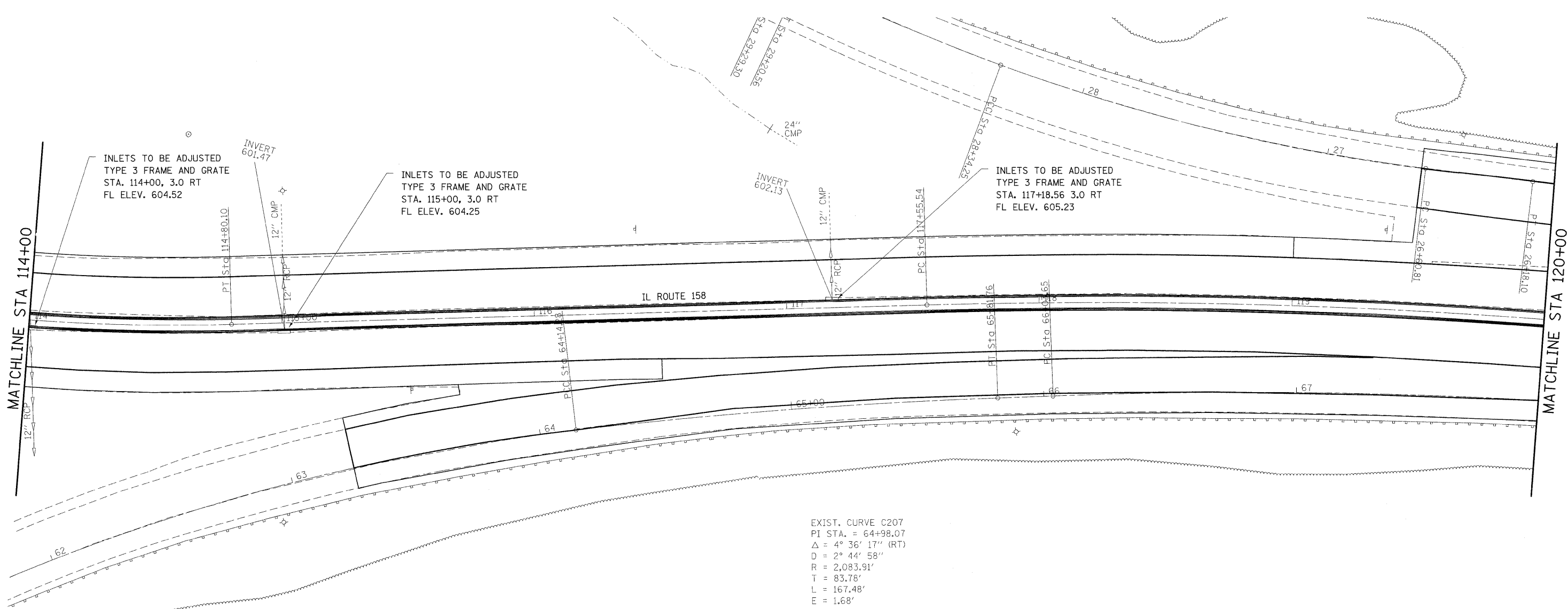

EXIST. CURVE C206
 PI STA. = 62+28.63
 $\Delta = 25^\circ 49' 23''$ (RT)
 D = 6° 50' 05"
 R = 838.31'
 T = 192.18'
 L = 377.83'
 E = 21.75'
 e = -----
 T.R. = -----
 S.E. RUN = -----
 P.C. STA. = 60+36.46
 P.T. STA. = 64+14.28

EXIST. CURVE C207
 PI STA. = 64+98.07
 $\Delta = 4^\circ 36' 17''$ (RT)
 D = 2° 44' 58"
 R = 2,083.91'
 T = 83.78'
 L = 167.48'
 E = 1.68'
 e = -----
 T.R. = -----
 S.E. RUN = -----
 P.C. STA. = 64+14.28
 P.T. STA. = 65+81.76

FILE NAME =	USER NAME = mshifeldao	DESIGNED -	REVISED -
c:\pwork\pwidot\mshifeldao\dms52558\1n02606a.dgn		DRAWN -	REVISED -
		CHECKED -	REVISED -
		DATE -	REVISED -

**STATE OF ILLINOIS
 DEPARTMENT OF TRANSPORTATION**

DRAINAGE PLAN

SCALE: SHEET NO. OF SHEETS STA. TO STA.

F.A.P. RTE.	SECTION	COUNTY	TOTAL SHEETS	SHEET NO.
809	67-1HBR	MONROE	144	50
CONTRACT NO. 76977				
FED. ROAD DIST. NO. ILLINOIS FED. AID PROJECT				