

RIDGE STREET

MOUNTABLE CURB @ DRIVEWAYS WITH 8 INCH THICK PCC. (MATCH EXISTING DRIVEWAYS)

STA. 24+84-25+02 (12 S.Y. PCC)
 STA. 25+33-25+51 (12 S.Y. PCC)
 STA. 25+80-25+99 (11 S.Y. PCC)
 STA. 26+21-26+43 (13 S.Y. PCC)

NOTES:
 ALL UTILITIES THAT ARE LOCATED IN NEW WALK, REQUIRE EXPANSION BOARD.
 REMOVE AND SALVAGE EXISTING SIGNS, VERIFY NEW LOCATION AND INSTALLATION REQUIREMENTS WITH CITY ENGINEER.
 CONTRACTOR RESPONSIBLE FOR ALL PROPERTY MONUMENTS DISTURBED DURING CONSTRUCTION.
 UTILITIES INDICATE ARE APPROXIMATE AND SHALL BE FIELD VERIFIED BY CONTRACTOR PRIOR TO CONSTRUCTION.
 SIDEWALK CONTROL JOINTS: CONTROL JOINTS=WIDTH OF SIDEWALK EXPANSION JOINTS @ 60' INTERVALS

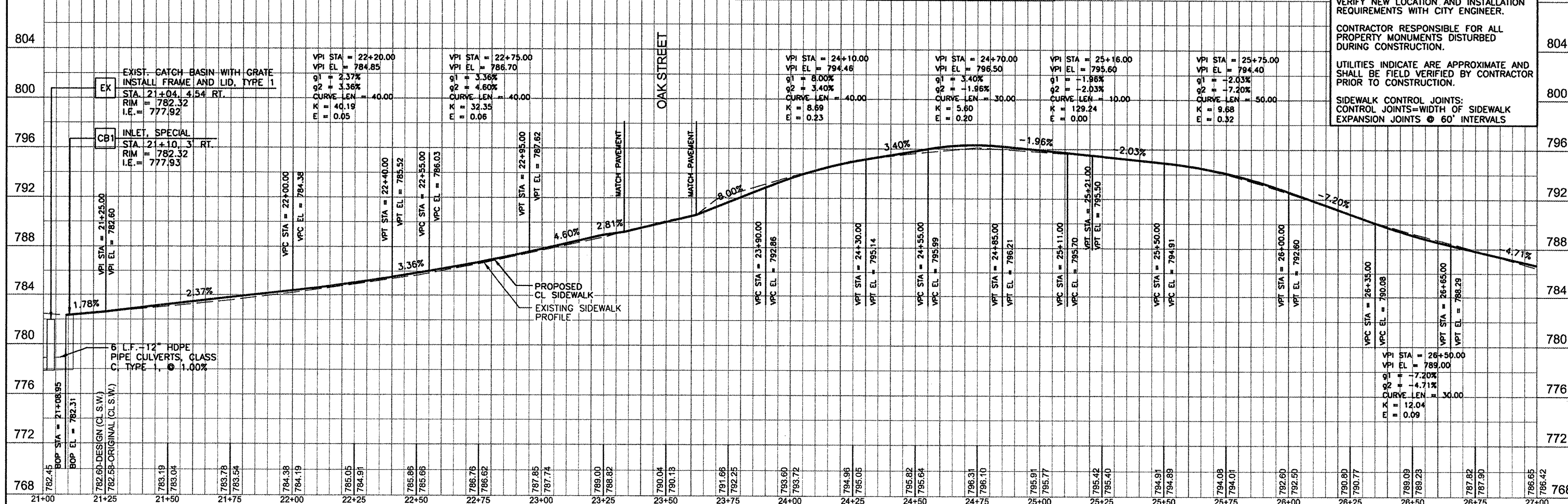

FILE NAME = k:\planshta\18_PPI.dgn	USER NAME = .Markw.	DESIGNED - MW, NW	REVISED - MAY 1, 2009	STATE OF ILLINOIS DEPARTMENT OF TRANSPORTATION	PLAN AND PROFILE	F.A. RTE.	SECTION	COUNTY	TOTAL SHEET NO.
	PLOT SCALE = 48.00 ft / IN.	DRAWN - MW	REVISED - MAY 12, 2009			08-00043-00-SW	JO DAVIESS	17	10
	PLOT DATE = 11/9/2009 10:08:39 AM	CHECKED - PR	REVISED - AUGUST 28, 2009			CONTRACT NO.			
		DATE -	REVISED -			ILLINOIS FED. AID PROJECT			