

SIGN SCHEDULE

LOCATION	TELESCOPING STEEL SIGN SUPPORT FOOT	D11-1	M7-1	M7-5	M7-6	M4-11	M4-12	R1-1	R7-8	OM4-1	R7-L101
		24"x18" 3.0 SQ FT	12"x9" 0.75 SQ FT	12"x9" 0.75 SQ FT	12"x4" 0.33 SQ FT	12"x4" 0.33 SQ FT	18"x18" 2.25 SQ FT	12"x18" 1.5 SQ FT	18"x18" 2.25 SQ FT	12"x6" 0.50 SQ FT	
REYNOLDS FIELD/VALE PARK	2 @ 12	2									
CUSTER & FIRST STREET	2 @ 12	2	1								
FIRST & GRANT	2 @ 10	2									
FIRST & HARRISON	2 @ 10	2									
FIRST & PERRY	2 @ 10	2									
FIRST & MADISON	2 @ 10	2									
FIRST & PEORIA	2 @ 10, 2 @ 12	4	2								
SUBTOTAL	16EA./172LF	16	3								
IL RT 2 & PAGE DRIVE	2 @ 12	2				1	1				
PAGE DRIVE	4 @ 10	4									
SUBTOTAL	6EA./64LF	6				1	1				
RT. STA. 119+15	1 @ 10							1			
LT. STA. 119+50	1 @ 10							1			
RT. STA. 119+59	1 @ 10								1		1
RT. STA. 119+59	1 @ 10									1	1
OTTAWA & BOYD	1 @ 10, 1 @ 12	2	1								
BOYD & BRINTON	2 @ 10, 1 @ 12	3	2								
BRINTON & E. CHAMBERLIN	2 @ 10	2									
BRINTON & MCKENNEY	3 @ 12, 1 @ 10	4		1	2						
BRINTON & E. BRADSHAW	2 @ 10	2									
BRINTON & NORTH COURT	2 @ 10	2									
BRINTON & MARCLARE	2 @ 10	2									
BRINTON & APPLE	2 @ 10	2									
BRINTON & MEADOWS TRAIL	2 @ 12	2				1	1			1	1
SUBTOTAL	25EA./264LF	21	3	1	2	1	1	2	1	1	1
MCKENNEY & JEFFERSON	2 @ 10	1									
MCKENNEY & WASHINGTON	2 @ 12, 2 @ 10	4	2								
WASHINGTON & BRADSHAW	2 @ 12	2	2								
SUBTOTAL	8EA./88LF	7	4								
TOTAL (EACH)	55	50	10	1	2	2	2	2	1	1	1
TOTAL (LF/SQ. FT.)	578	150	7.5	0.75	1.5	0.66	0.66	4.5	1.5	2.25	0.5

ROUTE NO.	SECTION	COUNTY	TOTAL SHEETS	SHEET NO.
9	1	LEE	21	6
FED. ROAD DIST. NO. 7 ILLINOIS FED. AID PROJECT-				
* Section 09-P4000-01-BT Contract #85504				

SIGN SYMBOL M.U.T.C.D. CODE DESCRIPTION

BR D11-1 BIKE ROUTE

ROUTE MARKER SUPPLEMENTAL PLAQUES

M7-1

M7-5

M7-6

M4-11

M4-12

"THE MEADOWS" RECREATION FACILITIES 567 ACRES

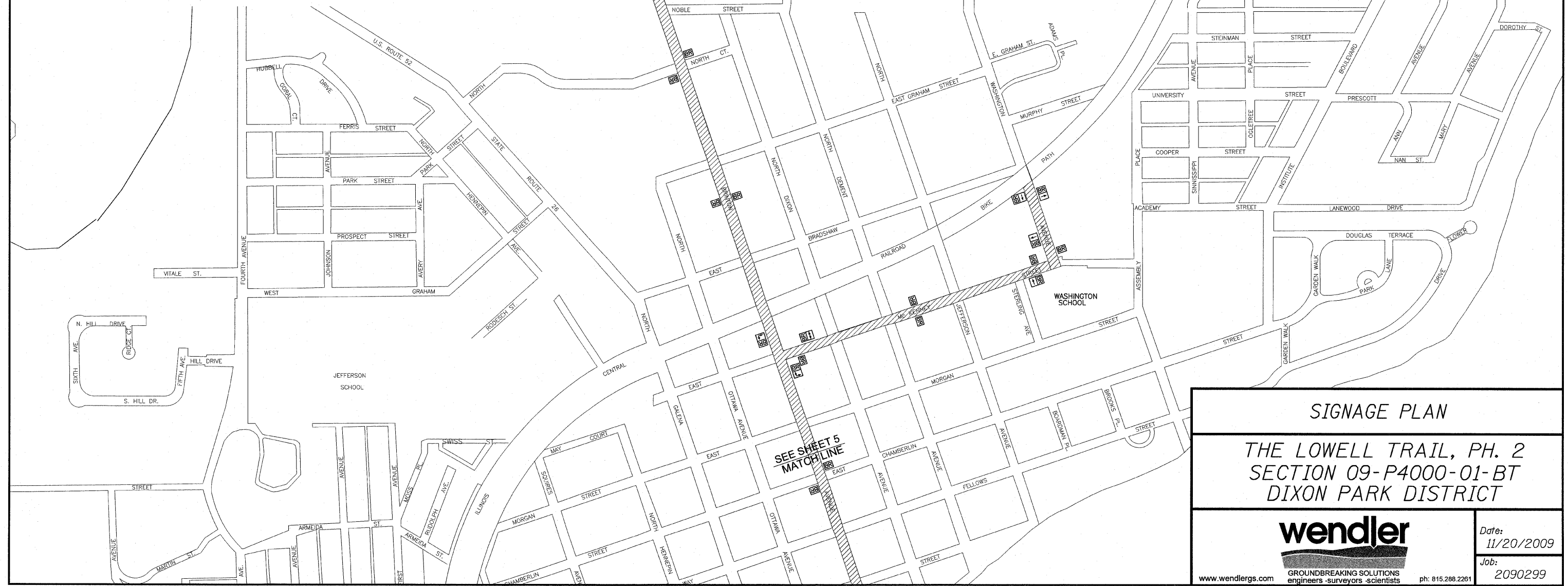
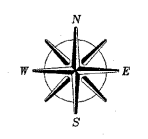

SIGNAGE PLAN

THE LOWELL TRAIL, PH. 2
SECTION 09-P4000-01-BT
DIXON PARK DISTRICT

wendler
GROUND BREAKING SOLUTIONS
engineers - surveyors - scientists

Date: 11/20/2009
Job: 2090299

www.wendlers.com ph: 815.288.2261