

DATE	
BY	
FINAL SURVEY	
REVISIONS	
NOTE BOOK	
NO.	

DATE	
BY	
ORIGINAL SURVEY	
REVISIONS	
NOTE BOOK	
NO.	

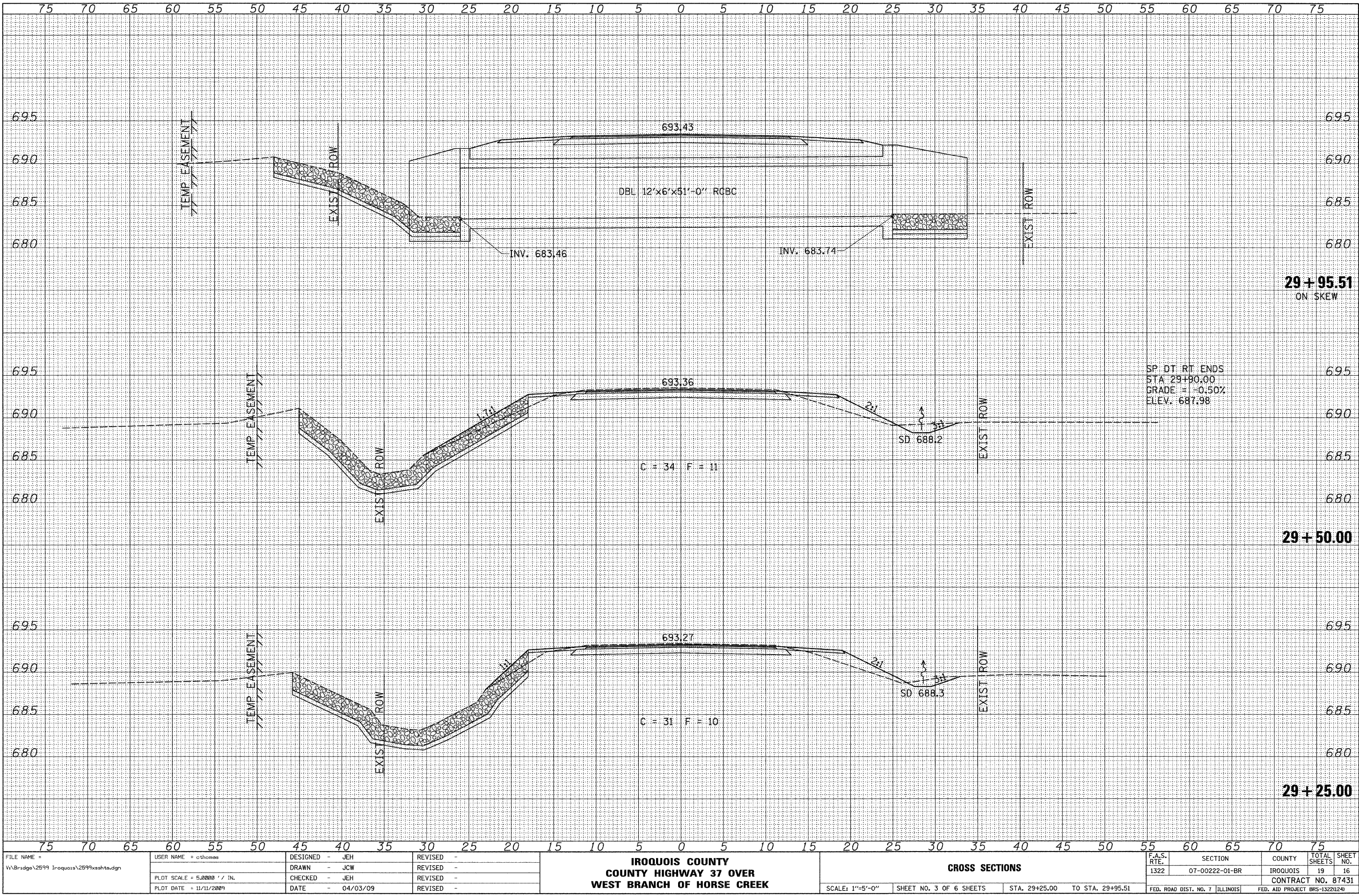

SP. DT. RT. ENDS  
 STA 29+00.00  
 GRADE = -0.50%  
 ELEV. 687.98

FILE NAME =  
 V:\Bridge\2599 Iroquois\2599xshta.dgn

USER NAME =	o.thomas	DESIGNED -	JEH	REVISED -	
		DRAWN -	JCW	REVISED -	
		CHECKED -	JEH	REVISED -	
		DATE -	04/03/09	REVISED -	

**IROQUOIS COUNTY  
 COUNTY HIGHWAY 37 OVER  
 WEST BRANCH OF HORSE CREEK**

**CROSS SECTIONS**

SCALE: 1"=5'-0"    SHEET NO. 3 OF 6 SHEETS    STA. 29+25.00 TO STA. 29+95.51

F.A.S. RTE.	SECTION	COUNTY	TOTAL SHEETS	SHEET NO.
1322	07-00222-01-BR	IROQUOIS	19	16
FED. ROAD DIST. NO. 7		ILLINOIS	CONTRACT NO. 87431	
			FED. AID PROJECT BR5-1322(124)	