

F.A.I. RTE.	SECTION	COUNTY	TOTAL SHEETS	SHEET NO.
57	*	DOUGLAS	65	21
STA. 47+00		TO STA. 53+00		
FED. ROAD DIST. NO.	ILLINOIS	FED. AID PROJECT		
* (15, 21-25HB-2)BR				
<b>CONTRACT NO. 90952</b>				

# TRAFFIC CONTROL & PROTECTION SPECIAL

## STAGE I

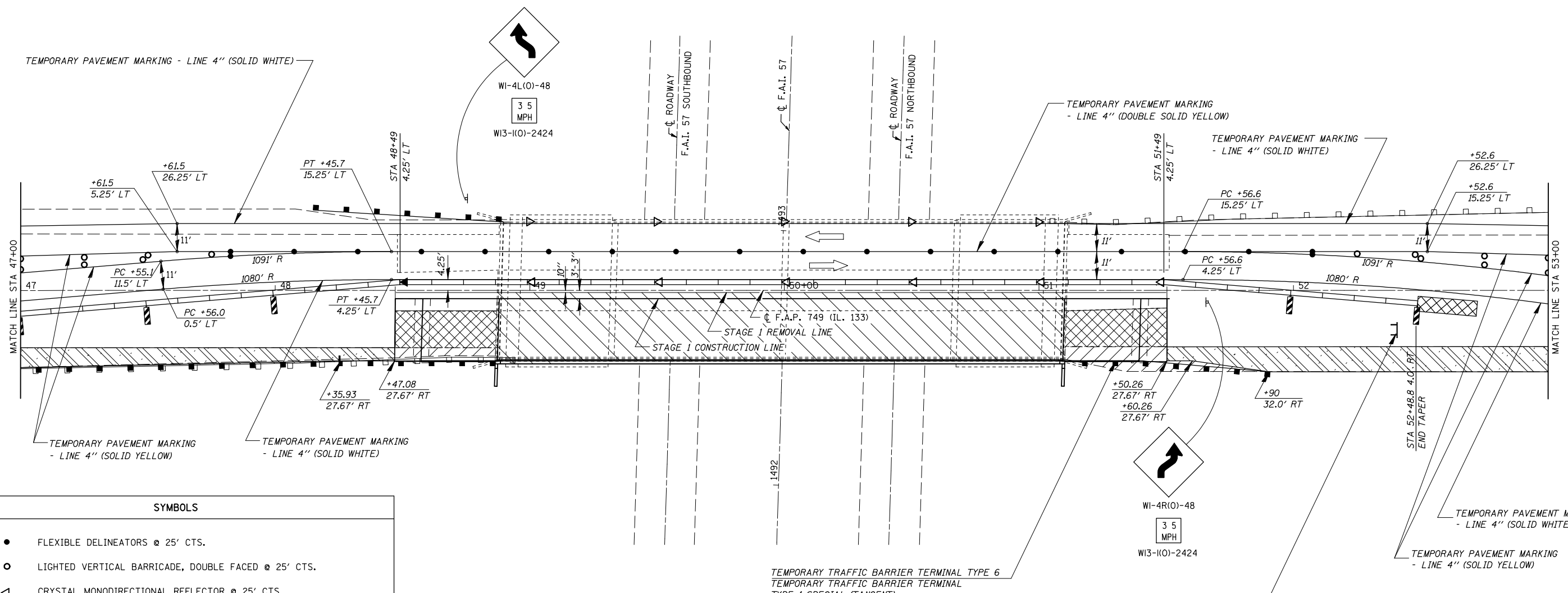

SYMBOLS	
●	FLEXIBLE DELINEATORS @ 25' CTS.
○	LIGHTED VERTICAL BARRICADE, DOUBLE FACED @ 25' CTS.
△	CRYSTAL MONODIRECTIONAL REFLECTOR @ 25' CTS.
▨	VERTICAL PANELS W/STEADY BURNING LIGHT ALONG TAPER @ 25' CTS.
▭	TEMPORARY CONCRETE BARRIER
—	TEMPORARY PAVEMENT MARKINGS
▨	IMPACT ATTENUATOR TEMPORARY (NON-REDIRECTIVE) TEST LEVEL 3
▨	HOT-MIX ASPHALT SURFACE REMOVAL 8" / P.C.C. BASE COURSE 8"
▨	PAVED SHOULDER REMOVAL
▨	APPROACH SLAB REMOVAL
▨	REMOVAL OF EXISTING CONCRETE DECK

TEMPORARY TRAFFIC BARRIER TERMINAL TYPE 6  
 TEMPORARY TRAFFIC BARRIER TERMINAL TYPE 1 SPECIAL (TANGENT)

TYPE III BARRICADE WITH TWO TYPE 3 FLASHERS

SHEET 2 OF 3

**TRAFFIC CONTROL & PROTECTION**  
**STAGE I**

FAI ROUTE 57  
SECTION (15, 21-25HB-2)BR  
DOUGLAS COUNTY

CUMMINS ENGINEERING CORPORATION	JOB #: 2114.1
	FILE: STAGE1
	DATE: 10/13/06

HOT-MIX ASPHALT SURFACE REMOVAL AND CONSTRUCTION OF PORTLAND CEMENT CONCRETE BASE COURSE FROM STA 52+50 TO STA 54+12 SHALL BE GOVERNED BY THE SPECIAL PROVISION "HOT-MIX ASPHALT SURFACE REMOVAL 8"."