

STAGE 1 REMOVAL
(Looking East)

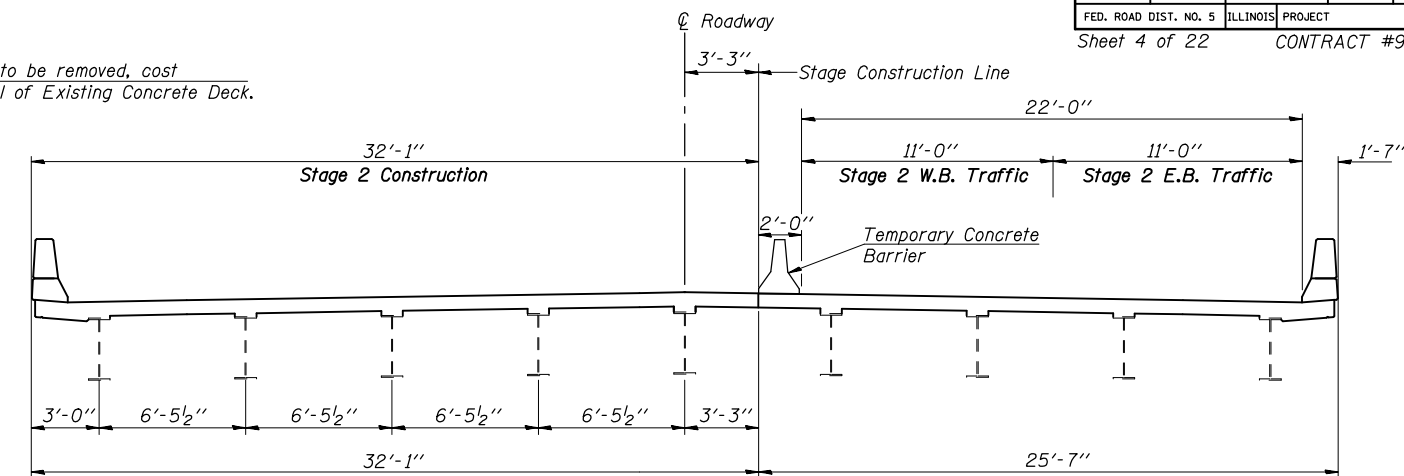

STAGE 2 CONSTRUCTION
(Looking East)

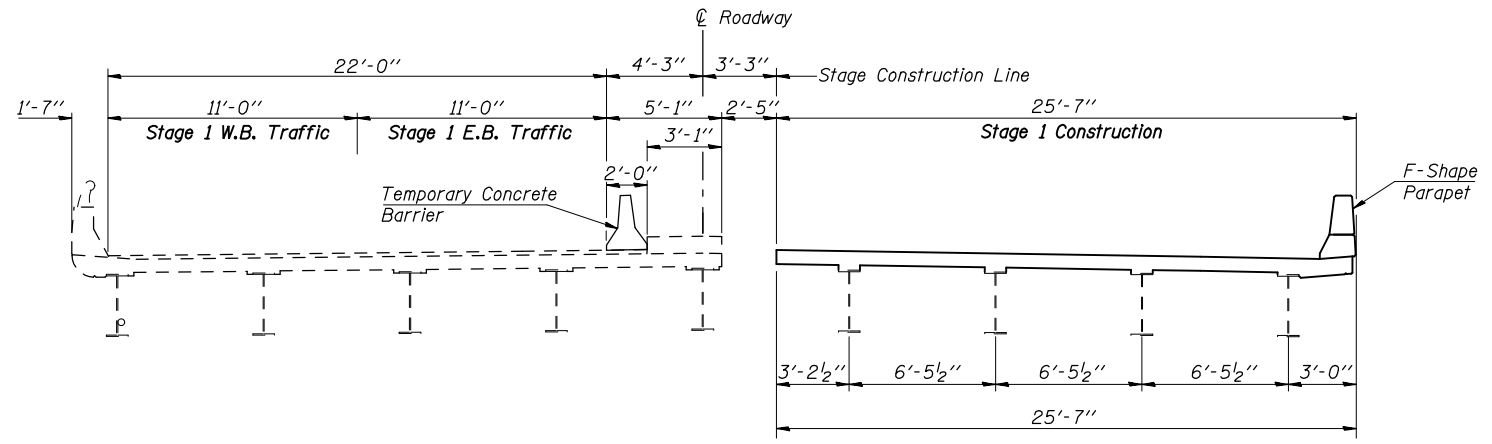

STAGE 1 CONSTRUCTION
(Looking East)

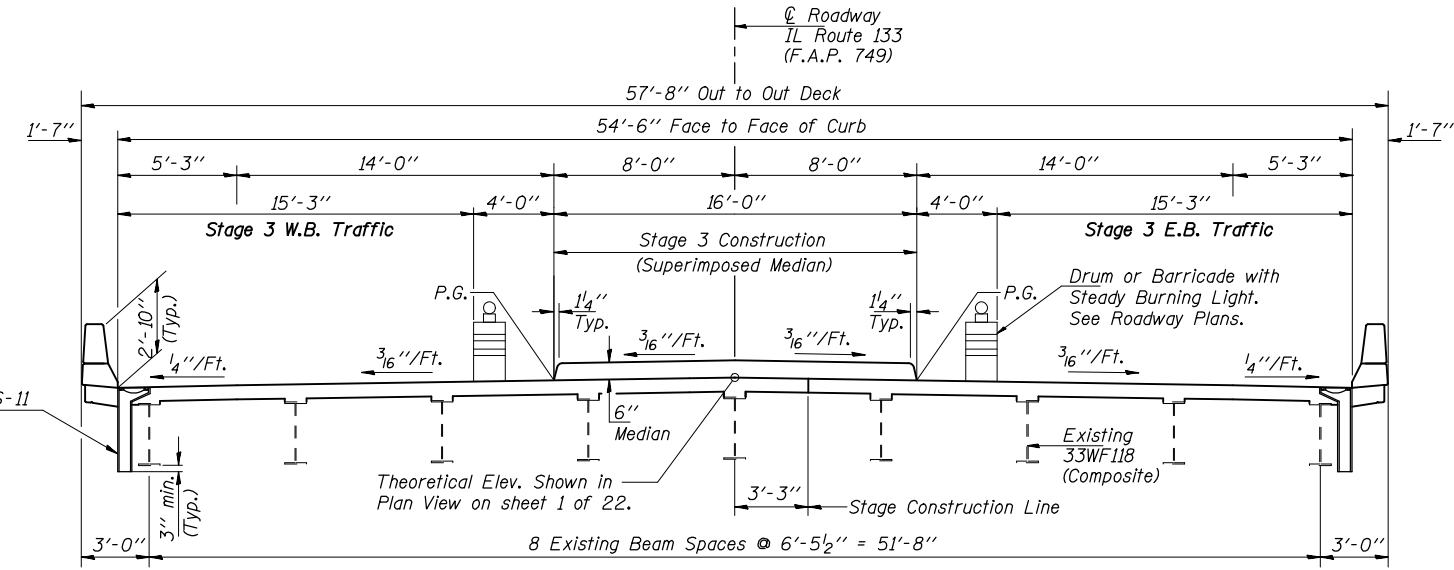

STAGE 3 CONSTRUCTION
(Looking East)

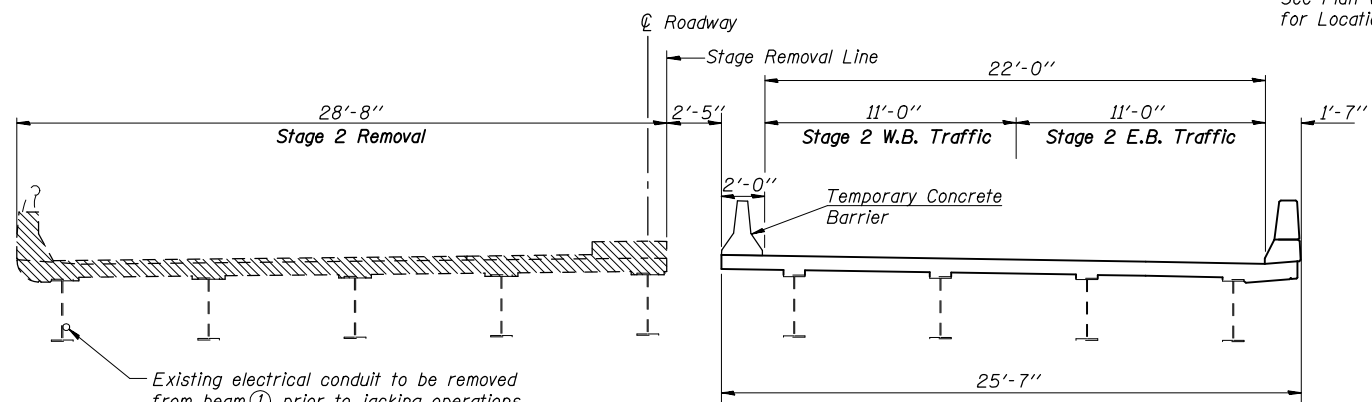

STAGE 2 REMOVAL
(Looking East)

Drainage Scupper DS-11 or 6" ϕ Floor Drain See Plan View for Locations

Existing electrical conduit to be removed from beam (1) prior to jacking operations. See Roadway Plans.

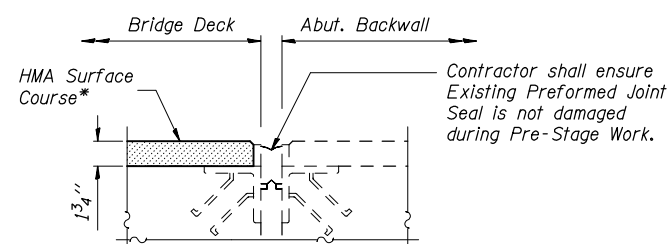

SECTION A-A
(East Abutment Shown, West Abutment Similar)

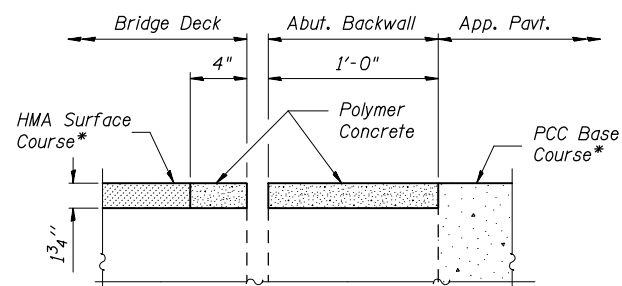

SECTION B-B
(After Concrete Median Has Been Removed)
(East Abutment Shown, West Abutment Similar)

BILL OF MATERIAL

ITEM	UNIT	QUANTITY
HMA Surface Removal (Deck)	Sq. Yd.	452
Polymer Concrete	Cu. Ft.	2.2

Notes: Hatched areas indicate Removal of Existing Concrete Deck. For details of Temporary Concrete Barrier, see sheet 22 of 22. See Roadway Plans for quantity of Temporary Concrete Barrier, HMA Surface Course and PCC Base Course.

STAGE CONSTRUCTION DETAILS

IL ROUTE 133 OVER I-57
F.A.I. ROUTE 57 SECTION (15,21-25HB-2)BR
DOUGLAS COUNTY
STA. 1492+76.53
S.N. 021-0024

DESIGNED	Ruben V. Boehler
CHECKED	Tim S. Howard
DRAWN	Nicole L. Darling
CHECKED	Michael D. Cummins

*Prior to Stage 1 Removal. Cost of Concrete Median Removal is included with Removal of Existing Concrete Deck.
**Limits of Conc. Median Removal and Polymer Concrete.