

EXISTING TYPICAL SECTION BUS. LOOP 55  
275+70 TO 277+47  
285+81 TO 286+35

\* EXISTING HOT-MIX ASPHALT SHOULDER  
275+70 TO 277+47 - ±4' WIDTH  
\* EXISTING AGGREGATE SHOULDER  
285+81 TO 286+35 - ±4' WIDTH

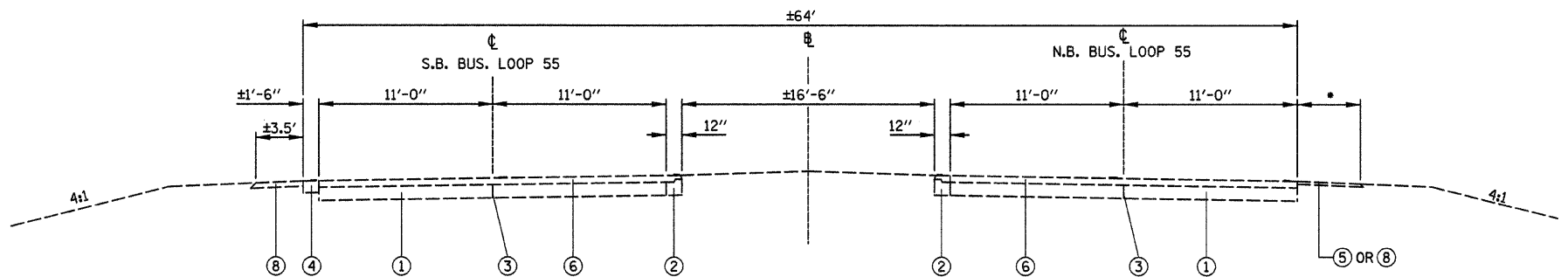

EXISTING TYPICAL SECTION BUS. LOOP 55  
277+47 - 285+81

\* EXISTING HOT-MIX ASPHALT SHOULDER  
277+47 TO 280+04.5 - ±4' WIDTH  
283+45 TO 284+71.5 - VARIES  
\* EXISTING AGGREGATE SHOULDER  
280+04.5 TO 283+45 - ±4' WIDTH  
284+71.5 TO 285+81 - ±4' WIDTH

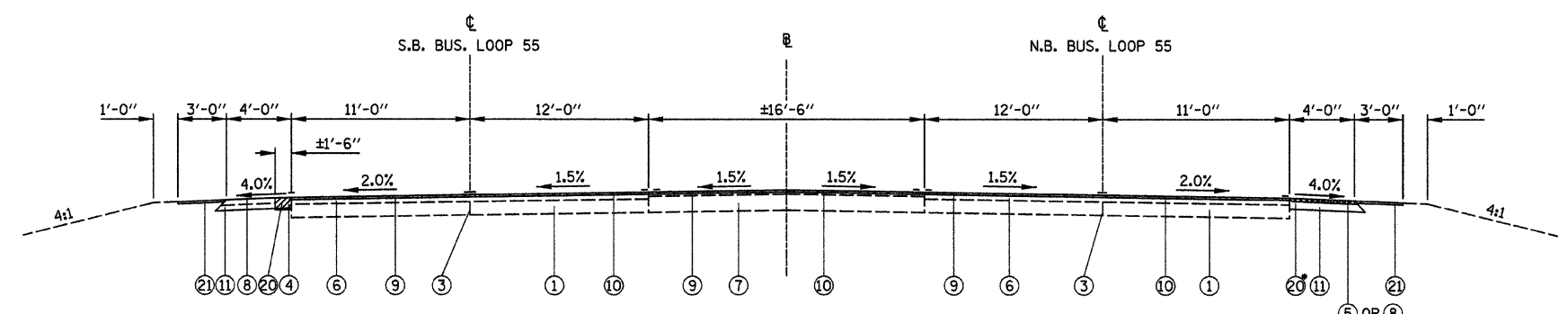

PROPOSED TYPICAL SECTION BUS. LOOP 55  
275+70 TO 277+47  
285+82 TO 286+35

\* PROPOSED PAVED SHOULDER REMOVAL  
275+70 TO 277+47 - (±4' WIDTH)

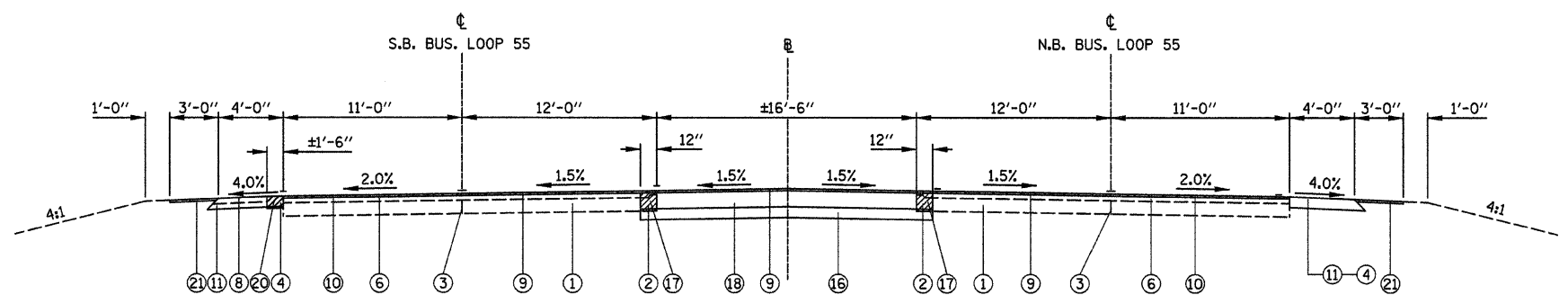

PROPOSED TYPICAL SECTION BUS. LOOP 55  
277+47 - 279+44.24

**LEGEND**

- ① EXISTING CONCRETE PAVEMENT 10"
- ② EXISTING CONCRETE CURB AND GUTTER
- ③ EXISTING LONGITUDINAL METAL JOINT
- ④ EXISTING HOT-MIX ASPHALT SHOULDER, 8"
- ⑤ EXISTING HOT-MIX ASPHALT SHOULDER, 2 1/4"
- ⑥ EXISTING HOT-MIX ASPHALT SURFACE 5"
- ⑦ EXISTING HOT-MIX ASPHALT BINDER AND SURFACE, 12"
- ⑧ EXISTING AGGREGATE SHOULDER
- ⑨ PROPOSED HOT-MIX ASPHALT SURFACE COURSE MIX "D", N70, 1 1/2"
- ⑩ PROPOSED HOT-MIX ASPHALT SURFACE REMOVAL 1 1/2"
- ⑪ PROPOSED HOT-MIX ASPHALT SHOULDERS, 8"
- ⑫ PROPOSED COMBINATION CONCRETE CURB AND GUTTER TYPE B-6.12 (SPECIAL)
- ⑬ PROPOSED COMBINATION CONCRETE CURB AND GUTTER TYPE B-6.18
- ⑭ PROPOSED COMBINATION CONCRETE CURB AND GUTTER TYPE M-6.12 (SPECIAL)
- ⑮ PROPOSED CONCRETE MEDIAN SURFACE 4"
- ⑯ PROPOSED SUB-BASE GRANULAR MATERIAL, TYPE A, 8"
- ⑰ PROPOSED COMBINATION CURB AND GUTTER REMOVAL (SPECIAL)
- ⑱ PROPOSED HOT-MIX ASPHALT BASE COURSE WIDENING, 12"
- ⑲ PROPOSED HOT-MIX ASPHALT BASE COURSE, 9"
- ⑳ PROPOSED PAVED SHOULDER REMOVAL
- ㉑ PROPOSED AGGREGATE SHOULDER TYPE B, 1"
- ㉒ PROPOSED SUB-BASE GRANULAR MATERIAL, TYPE A, 12"
- ㉓ PROPOSED SUB BASE GRANULAR MATERIAL, TYPE C

**HOT-MIX ASPHALT MIXTURE REQUIREMENTS**

| ITEM                    | AGGREGATE COMPOSITION  | ASPHALT GRADE | DESIGN AIR VOIDS |
|-------------------------|------------------------|---------------|------------------|
| HMA BASE CSE & WIDENING | IL-19.0                | PG 64-22      | 4.0%@N70         |
| HMA LEVEL BINDER (MM)   | IL-9.5 OR 12.5         | PG 64-22      | 4.0%@N70         |
| HMA SURFACE CSE         | IL-9.5 OR 12.5 MIX "D" | PG 64-22      | 4.0%@N70         |
| HMA SHOULDERS           | OTHER (BAM)            | PG 58-22      | 2.0%@N30         |

HOT-MIX ASPHALT QUANTITIES BASED ON 112 LB/SQ.YD/INCH

|             |                    |                   |           |   |  |                 |                          |                 |                           |             |  |
|-------------|--------------------|-------------------|-----------|---|--|-----------------|--------------------------|-----------------|---------------------------|-------------|--|
| FILE NAME = | USER NAME = #USER# | DESIGNED - M.T.V. | REVISED - | <b>STATE OF ILLINOIS<br/>DEPARTMENT OF TRANSPORTATION</b> | <b>TYPICAL SECTIONS</b>  | F.A.P. RTE. 666 | SECTION 09-00015-00 PV   | COUNTY SANGAMON | TOTAL SHEETS 25           | SHEET NO. 3 |  |
| *FILEL*     |                    | DRAWN - K.M.S.    | REVISED - |   | <b>INTERSECTION CONSTRUCTION (BL-55 &amp; VILLAGE CTR DR), SHERMAN, IL</b> | SCALE:          | SHEET NO. 3 OF 25 SHEETS | STA. TO STA.    | CONTRACT NO. 9 8 5 1 3    |             |  |
|             |                    | CHECKED - T.T.P.  | REVISED - |   |  |                 |                          |                 | ILLINOIS FED. AID PROJECT |             |  |
|             |                    | DATE - 11/20/09   | REVISED - |   |  |                 |                          |                 |                           |             |  |