



F.A.U. RTE.	SECTION	COUNTY	TOTAL SHEETS	SHEET NO.
7982	*	SANGAMON	68	26
STA.		TO STA.		
FED. ROAD DIST. NO.	ILLINOIS	FED. AID PROJECT		
* 09-00447-03-PV		CITY OF SPRINGFIELD		

LEGEND

-  WORK AREA
-  TEMPORARY CONCRETE BARRIER
-  IMPACT ATTENUATOR

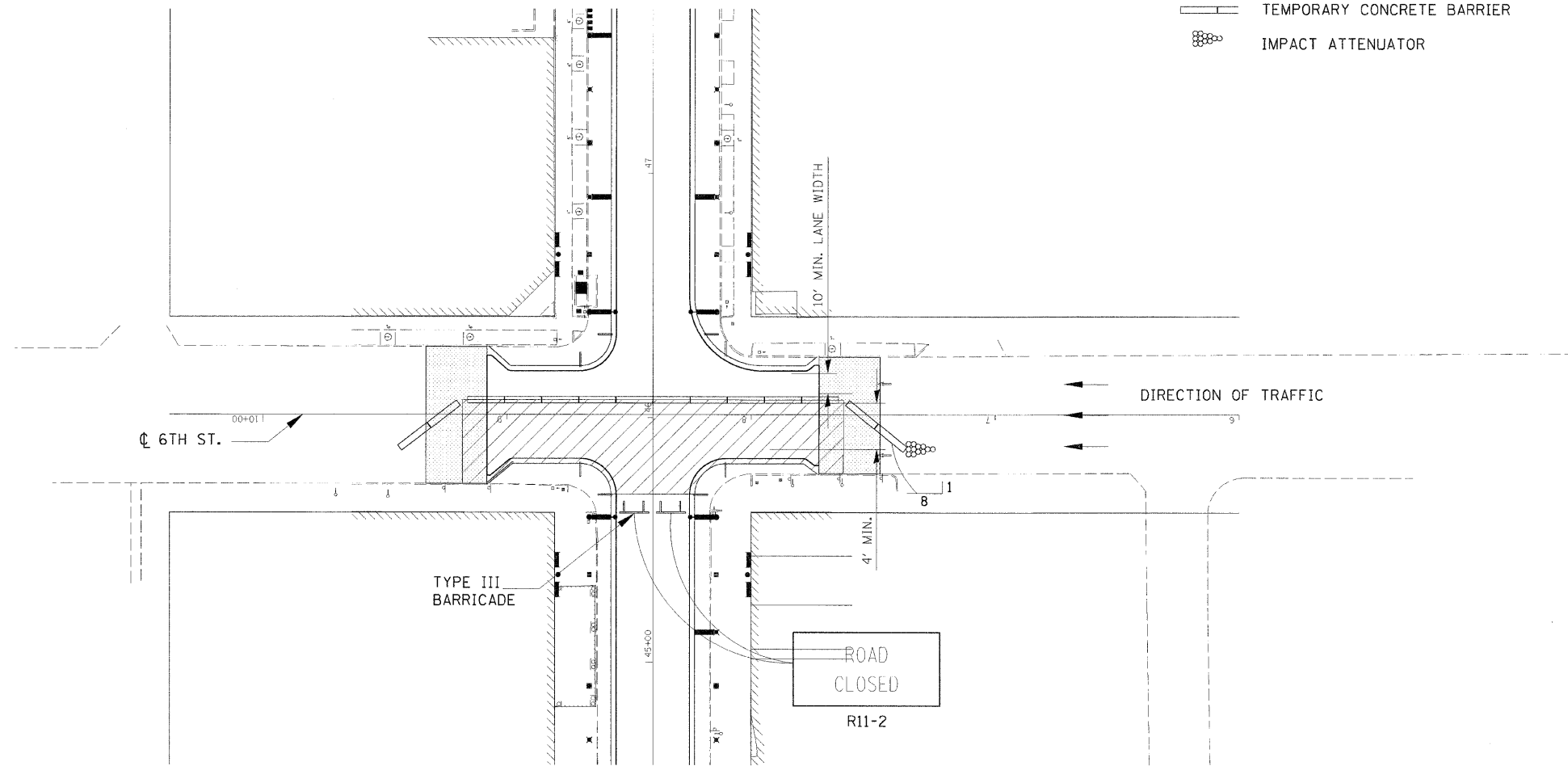

GENERAL NOTES

REFER TO STANDARDS:
 704001 - TEMPORARY CONCRETE BARRIER
 701601 - TO BE USED FOR LANE CLOSURE

REVISIONS	
NAME	DATE

ILLINOIS DEPARTMENT OF TRANSPORTATION
 TRAFFIC CONTROL DETAIL
 MULTILANE ONE-WAY TRAFFIC
 FAU RTE 7982 CAPITOL AVE
 SEC NO. 09-00447-03-PV
 SANGAMON COUNTY, ILLINOIS

SCALE: VERT.
 HORIZ.
 DATE 10/9/09

DRAWN BY DAP
 CHECKED BY MH



LAYOUT DAP 02/23/07
 DRAWN DAP 02/23/07
 REVIEWED MH 09/19/07
 PLOT DATE = 11/23/2009
 FILE NAME = I:\02\Jobs\02522611\A\ADD\Road\Microstation\Sheet\Section_2_5hr-7h\NC-217_TCP_DET_1-WAY.dgn
 PLOT SCALE = 3/8"=1'-0"
 USER NAME = hgm68751

© Copyright Hanson Professional Services Inc. 2009