

CURVE C1

C1	PI STA. = 437+67.06
	$\Delta = 01^\circ 07' 04''$ (LT)
	D = $0^\circ 28' 39''$
	R = 12,000.00'
	T = 117.06'
	L = 234.11'
	E = 0.57'
C2	P.C. STA = 436+50.00
C3	P.T. STA = 438+84.11

CURVE C4

C4	PI STA. = 441+16.06
	$\Delta = 1^\circ 04' 09''$ (RT)
	D = $0^\circ 28' 39''$
	R = 12,000.00'
	T = 111.95'
	L = 223.90'
	E = 0.52'
C5	P.C. STA = 440+04.11
C6	P.T. STA = 442+28.01

CURVE C7

C7	PI STA. = 447+71.54
	$\Delta = 2^\circ 06' 42''$ (RT)
	D = $1^\circ 01' 37''$
	R = 5,580.00'
	T = 102.84'
	L = 205.65'
	E = 0.95'
C8	P.C. STA = 446+68.70
C9	P.T. STA = 448+74.35

CURVE C10

C10	PI STA. = 450+97.19
	$\Delta = 2^\circ 06' 42''$ (LT)
	D = $1^\circ 01' 37''$
	R = 5,580.00'
	T = 102.84'
	L = 205.65'
	E = 0.95'
C11	P.C. STA = 449+94.35
C12	P.T. STA = 452+00.00

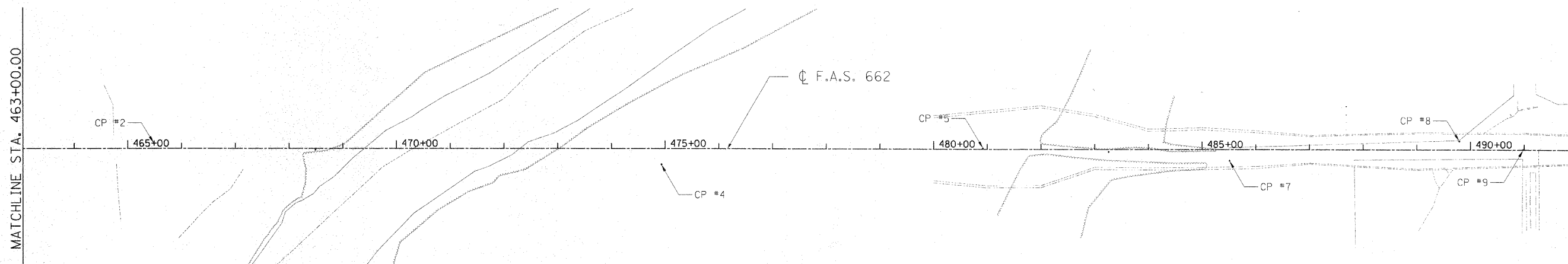

CURVE C13

C13	PI STA. = 497+43.15
	$\Delta = 23^\circ 58' 50''$ (RT)
	D = $9^\circ 32' 57''$
	R = 600.00'
	T = 127.43'
	L = 251.12'
	E = 13.38'
	e = 2.00%
	S.E. ATTN: 495+32.72 (-2.00%) TO 496+57.72 (2.00%)
	498+24.85 (2.00%) TO 499+49.85 (-2.00%)
C14	P.C. STA = 496+15.72
C15	P.T. STA = 498+66.85

CONTROL POINTS

POINT	DESCRIPTION	STATION, OFFSET	ELEVATION	NORTHING	EASTING
CP #1	IRON PIN @ END OF LEVEE	STA. 460+26.17, 27.64' RT.	ELEV: 546.57	24,946.24	34,633.58
CP #2	IRON PIN	STA. 465+48.71, 9.72' LT.	ELEV: 544.68	24,987.32	35,155.85
CP #3	IRON PIN		ELEV: 567.47	24,961.03	32,834.71
CP #4	IRON PIN	STA. 474+93.38, 29.24' RT.	ELEV: 544.23	24,955.12	36,100.77
CP #5	IRON PIN	STA. 480+92.08, 1.36' LT.	ELEV: 545.90	24,990.00	36,699.24
CP #6	IRON PIN		ELEV: 571.96	24,957.90	31,297.53
CP #7	IRON PIN	STA. 485+51.24, 20.78' RT.	ELEV: 594.37	24,971.14	37,158.54
CP #8	IRON PIN	STA. 489+79.28, 15.76' LT.	ELEV: 587.97	25,010.75	37,586.31
CP #9	IRON PIN	STA. 490+98.16, 0.62' LT.	ELEV: 588.98	24,996.45	37,705.30

F.A.S. 662

POINT	NORTHING	EASTING
C1	24,963.21	32,374.52
C2	24,962.47	32,257.46
C3	24,966.23	32,491.54
C4	24,972.22	32,723.41
C5	24,969.33	32,611.50
C6	24,973.02	32,835.36
C7	24,976.90	33,378.87
C8	24,976.17	33,276.04
C9	24,973.85	33,481.66
C10	24,967.23	33,704.40
C11	24,970.28	33,601.61
C12	24,967.96	33,807.24
C13	25,000.44	38,350.27
C14	24,999.53	38,222.85
C15	24,949.49	38,467.07
C16	24,896.24	38,589.11

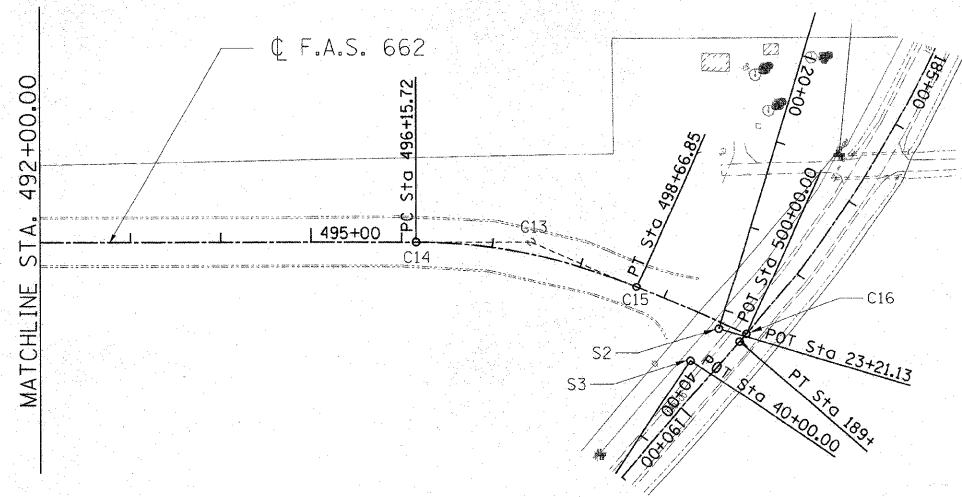

LAYOUT	MNM/DJP	10/10/07
DRAWN	DJP	10/10/07
REVIEWED	MNM	10/04/08

FILE NAME =	USER NAME = Pop08836	DESIGNED - MNM/DJP	REVISED -
I:\21\jobs\212221B\CADD\Road\Sheet\VC-183	team.dgn	DRAWN - DJP	REVISED -
PLOT SCALE = 1/8"=1'-0"	CHECKED - MNM	REVIEWED -	REVISED -
PLOT DATE = 12/23/2009	DATE - 10/10/07	REVISED -	REVISED -

**STATE OF ILLINOIS
DEPARTMENT OF TRANSPORTATION**

GEOMETRIC CONTROL SHEET

SCALE: SHEET NO. 1 OF 1 SHEETS STA. 436+50.00 TO STA. 500+00.00

F.A.S. RTE.	SECTION	COUNTY	TOTAL SHEETS	SHEET NO.
662	09-00061-01-R5	CUMBERLAND	14	5
CONTRACT NO. 95614				
FED. ROAD DIST. NO. ILLINOIS FED. AID PROJECT				