

CP #1
N - 24,946.24
E - 34,633.58

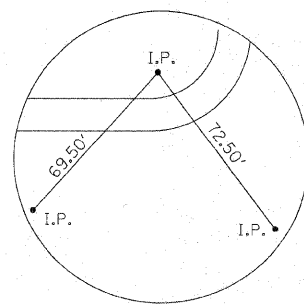

CP #2
N - 24,987.32
E - 35,155.85

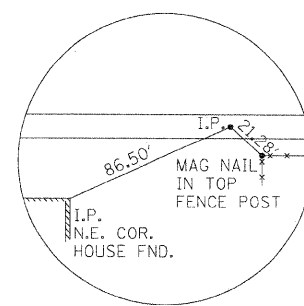

CP #3
N - 24,961.03
E - 32,834.71

BENCHMARKS

0.1 MILES SOUTH OF THE CENTER OF THE S.E. 1/4 SECTION 26,
110.00' SOUTH OF JUNCTION OF T-ROAD EAST, ON TOP OF
NORTH END HEADWALL OF CONCRETE CULVERT UNDER ROAD
SOUTH. CHISEL SQUARE ELEVATION = 618.00

CP #6 N - 24,957.90 E - 31,297.53 ELEVATION = 571.96

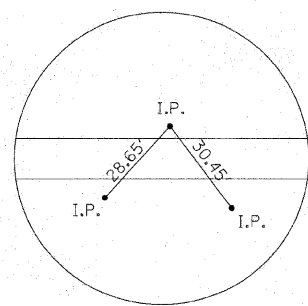

CP #4
N - 24,955.12
E - 36,100.77

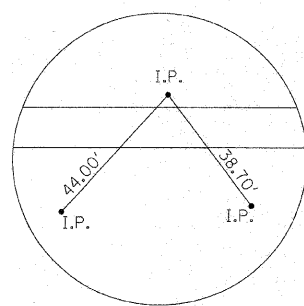

CP #5
N - 24,990.00
E - 36,699.24

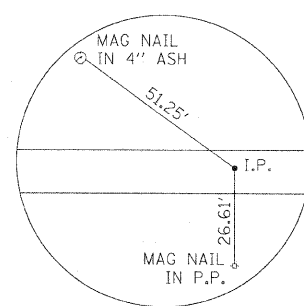

CP #6
N - 24,957.90
E - 31,297.53
BENCHMARK

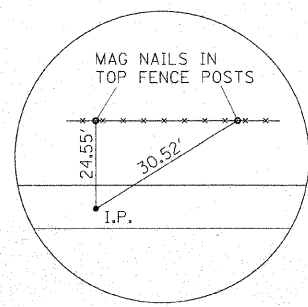

CP #7
N - 24,971.14
E - 37,158.54

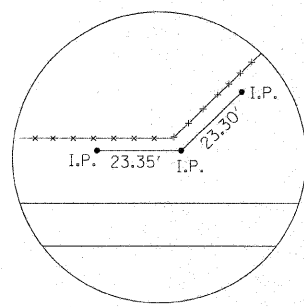

CP #8
N - 25,010.75
E - 37,586.31

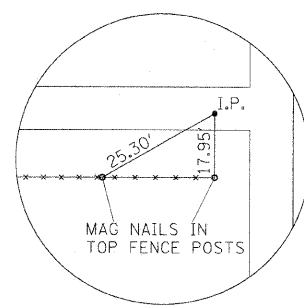

CP #9
N - 24,996.45
E - 37,705.30



LAYOUT	MNM/DJP	10/10/07
DRAWN	DJP	10/20/07
REVIEWED	MNM	02/07/08

FILE NAME =	USER NAME = Pop00036	DESIGNED - MNM/DJP	REVISED -
I:\01\jobs\01s20218\CADD\Road\Sheet\C-103 geom.dgn		DRAWN - DJP	REVISED -
PLOT SCALE = 100.0000' / in.		CHECKED - MNM	REVISED -
PLOT DATE = 12\23\2009		DATE - 10/10/07	REVISED -

**STATE OF ILLINOIS
DEPARTMENT OF TRANSPORTATION**

SURVEY TIES / BENCHMARKS

SCALE: SHEET NO. 1 OF 1 SHEETS

F.A.S. RTE.	SECTION	COUNTY	TOTAL SHEETS	SHEET NO.
662	09-00061-01-RS	CUMBERLAND	14	6
CONTRACT NO. 95614				
FED. ROAD DIST. NO. [ILLINOIS] FED. AID PROJECT				