

DRAWING FILE: 00092-02-PV XSEC 0-3450.dwg

PLOT DATE:

SECTION NO.	COUNTY HIGHWAY	COUNTY	SHEET OF SHEETS
06-00092-02-PV	22	ST. CLAIR	53 OF 63
FHWA REG. NO. 7	ILLINOIS	ARA-5011(297)	
FEDERAL AID PROJECT	CONTRACT # 97415		

CROSS SECTIONS

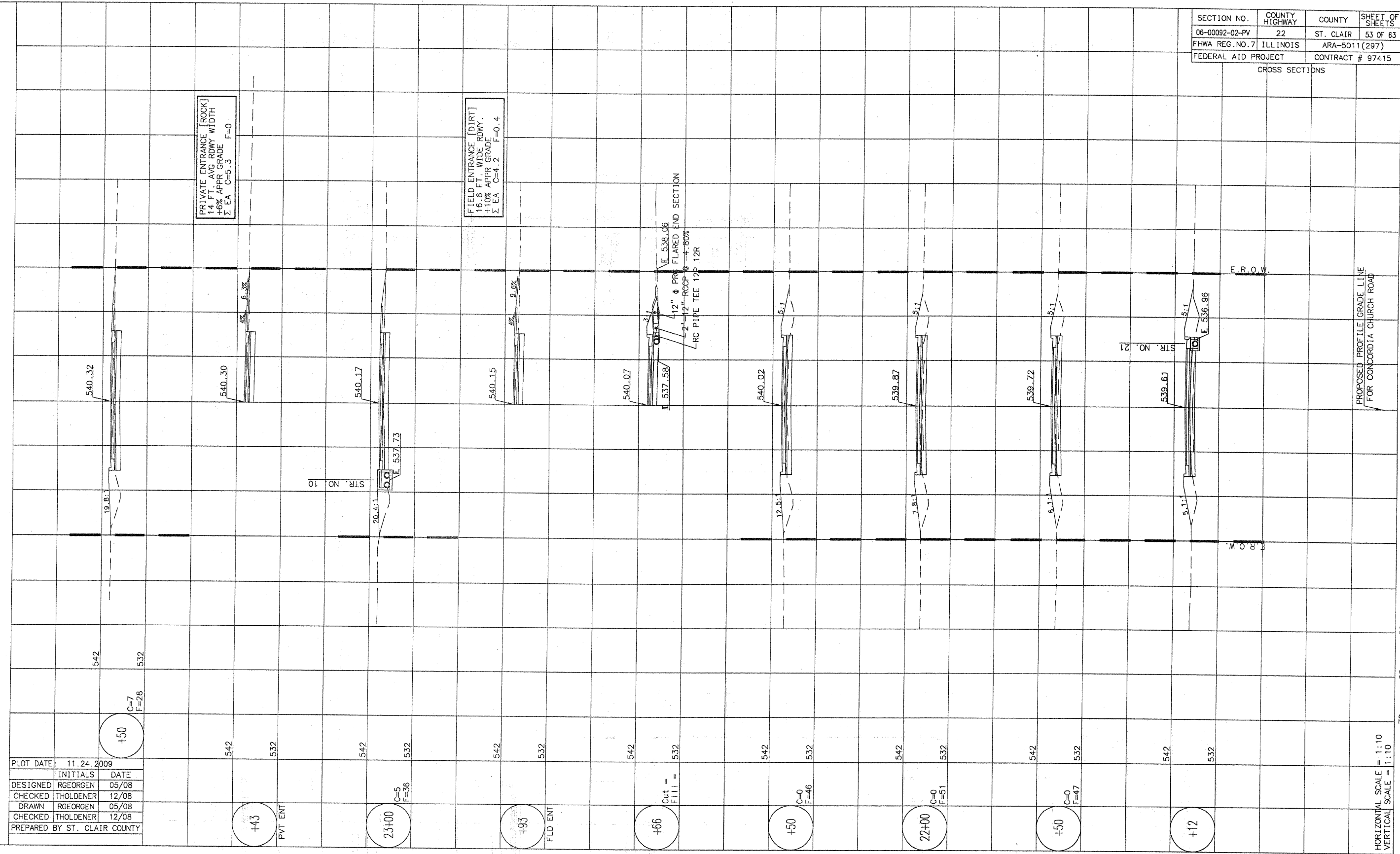

PLOT DATE: 11.24.2009	
DESIGNED	RGEORGEN 05/08
CHECKED	THOLDENER 12/08
DRAWN	RGEORGEN 05/08
CHECKED	THOLDENER 12/08
PREPARED BY ST. CLAIR COUNTY	

PRIVATE ENTRANCE [ROCK]
14 FT. AVG ROWY WIDTH
+6% APPR GRADE F=0
Σ EA C=5.3

FIELD ENTRANCE [DIRT]
16.6 FT. WIDE ROWY.
+10% APPR GRADE F=0.4
Σ EA C=4.2

PROPOSED PROFILE GRADE LINE
FOR CONCORDIA CHURCH ROAD

HORIZONTAL SCALE = 1:10
VERTICAL SCALE = 1:10