

SECTION NO.	COUNTY HIGHWAY	COUNTY	SHEET OF SHEETS
06-00092-02-PV	22	ST. CLAIR	59 OF 63
FHWA REG. NO. 7		ILLINOIS	ARA-5011 (297)
FEDERAL AID PROJECT		CONTRACT # 97415	

CROSS SECTIONS

PRIVATE ENTRANCE [ROCK]
15 FT. AVG ROWY WIDTH
-7% APPR GRADE
Σ EA C=8.2 F=0

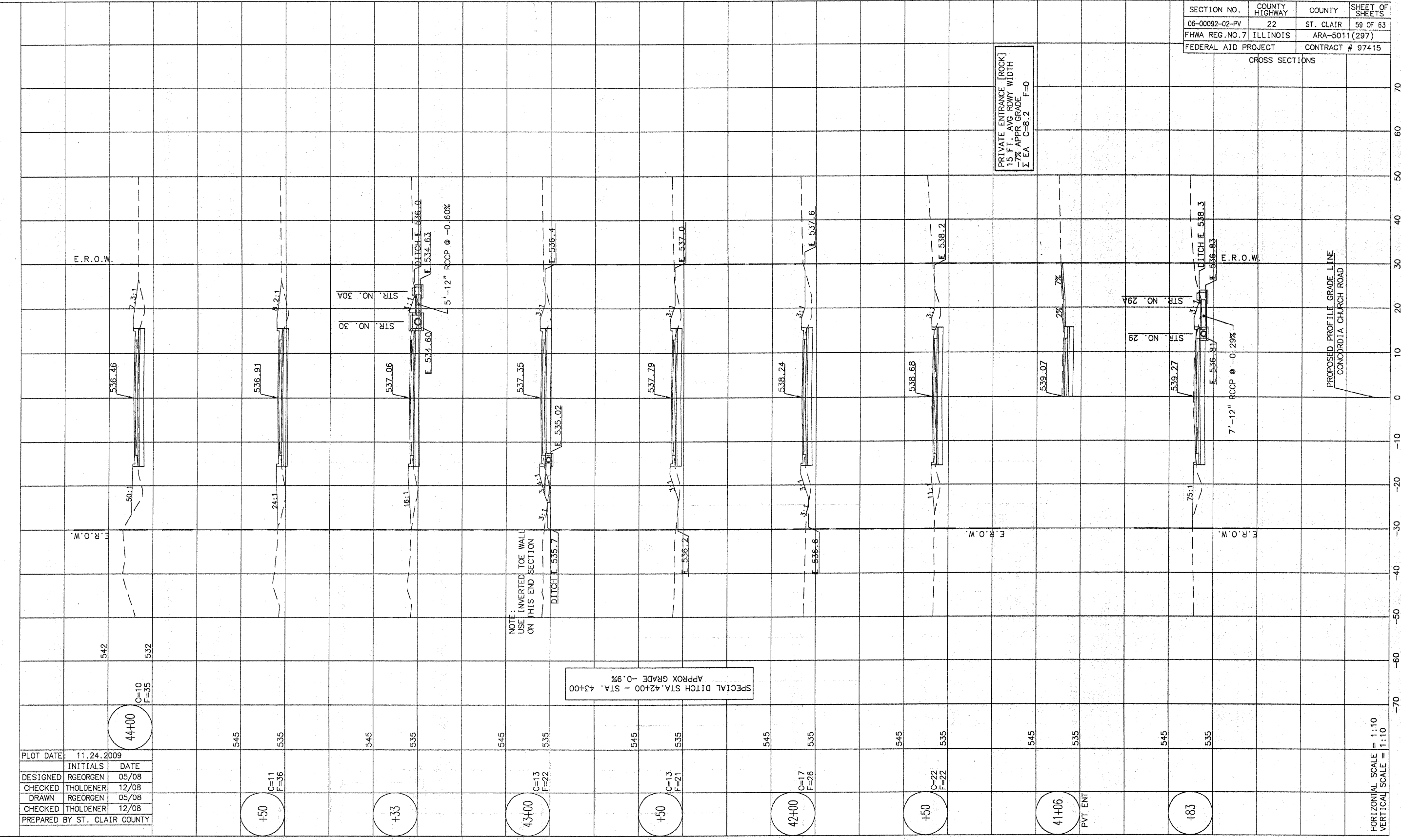

HORIZONTAL SCALE = 1:10
VERTICAL SCALE = 1:10

PLOT DATE: 11.24.2009		
DESIGNED	RGEORGEN	05/08
CHECKED	THOLDENER	12/08
DRAWN	RGEORGEN	05/08
CHECKED	THOLDENER	12/08
PREPARED BY ST. CLAIR COUNTY		

SPECIAL DITCH STA. 42+00 - STA. 43+00
APPROX GRADE -0.9%

NOTE:
USE INVERTED TOE WALL
ON THIS END SECTION