

PLAN	SURVEYED	BY	DATE
	PLOTTED		
	CHECKED		
	REVISIONS		
	NO. OF WAYS CHECKED		
	CADD FILE NAME		
	NO.		

PROFILE	SURVEYED	BY	DATE
	PLOTTED		
	CHECKED		
	REVISIONS		
	NO. OF WAYS CHECKED		
	STRUCTURE NOTATIONS CHKD		
	NO.		

MATCHLINE STA. 24+00.00

MATCHLINE STA. 30+00.00

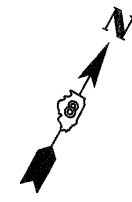
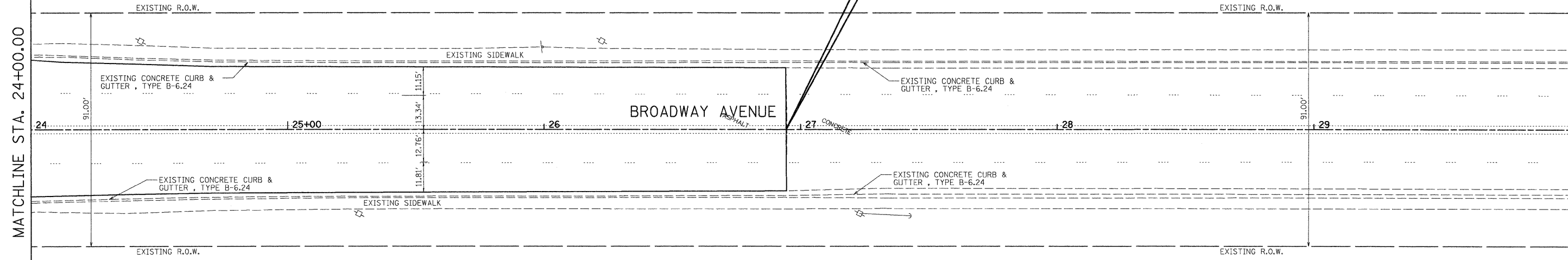

LEGEND

- MEDIAN REMOVAL AND REPLACEMENT
- PATCHES, CLASS B, TYPE II, 10"
- PATCHES, CLASS B, TYPE III, 10"
- PATCHES, CLASS B, TYPE IV, 10"

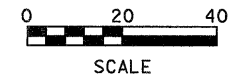

TBM - SOUTHEAST CORNER ON PORCH OF HOUSE
AT #619 BROADWAY AVENUE
ELEV. = 416.37

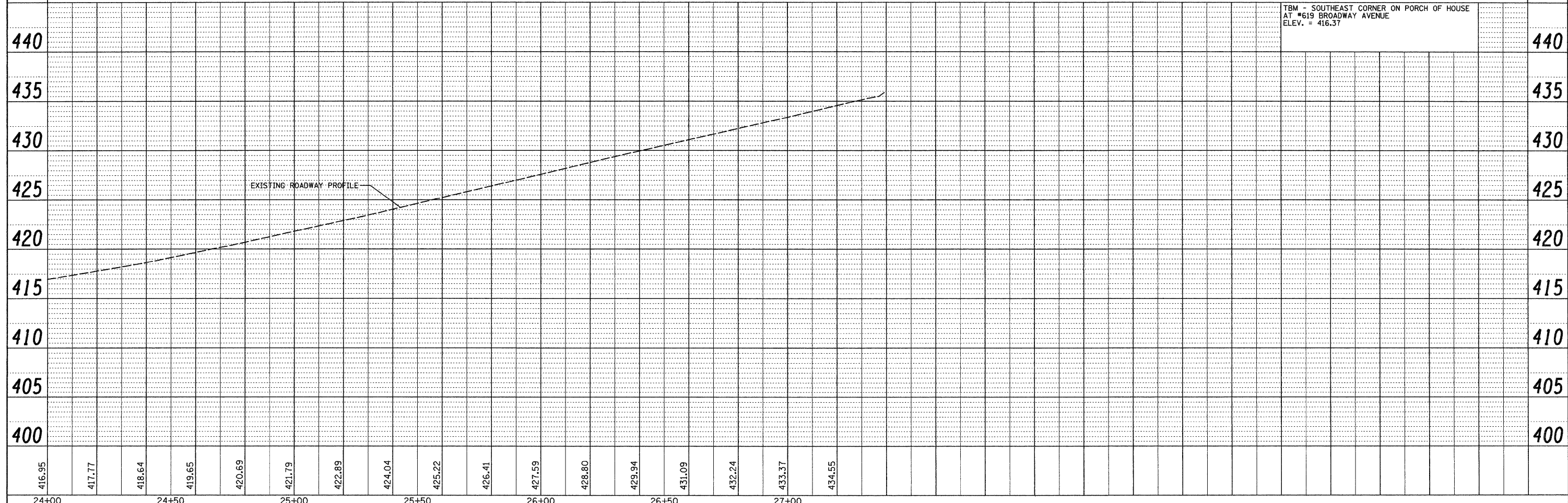

FILE NAME =	USER NAME = ike	DESIGNED -	REVISED -	CITY OF VENICE BROADWAY AVENUE	PLAN AND PROFILE SHEET	F.A.U. RTE.	SECTION	COUNTY	TOTAL SHEETS	SHEET NO.	
#FILE#		DRAWN -	REVISED -			9097	09-00048-00-RS	MADISON	24	16	
	PLOT SCALE = #SCALE#	CHECKED -	REVISED -			CONTRACT NO. 97417		ILLINOIS FED. AID PROJECT			
	PLOT DATE = 12/3/2009	DATE -	REVISED -			SCALE:	SHEET NO. OF SHEETS STA. TO STA.				