

SEE SHEET 14 FOR CROSSWALK AND STOP BAR DETAIL.

NOTE: PATCHES WILL BE CLASS D PATCHES, OF THE TYPE SPECIFIED, 10 INCH.

- LEGEND**
- LIMITS OF (HMA OR PCC) SURFACE REMOVAL (2") & PROPOSED 2" HMA SURFACE COURSE
  - LIMITS CLASS D PATCHES, 10"
  - LIMITS OF STRIP REFLECTIVE CRACK CONTROL
  - 4" YELLOW THERMOPLASTIC SKIP DASH STRIPING (10' - 30' SKIP DASH)

**NOTES:**

EX. SEWERS AND STRUCTURES WHERE SHOWN ARE APPROXIMATE ONLY. THE CONTRACTOR SHALL FIELD VERIFY LOCATIONS PRIOR TO CONSTRUCTION.

ALL EXISTING STORM STRUCTURES AND SEWER LINES TO BE USED IN PLACE UNLESS OTHERWISE NOTED. ALL EXISTING STRUCTURES AND SEWERS ARE TO BE PROTECTED. ANY DAMAGE TO EXISTING STRUCTURES OR SEWERS WILL BE REPAIRED OR REPLACED AT THE CONTRACTORS EXPENSE.

**PLAN**  
SCALE: 1" = 20'

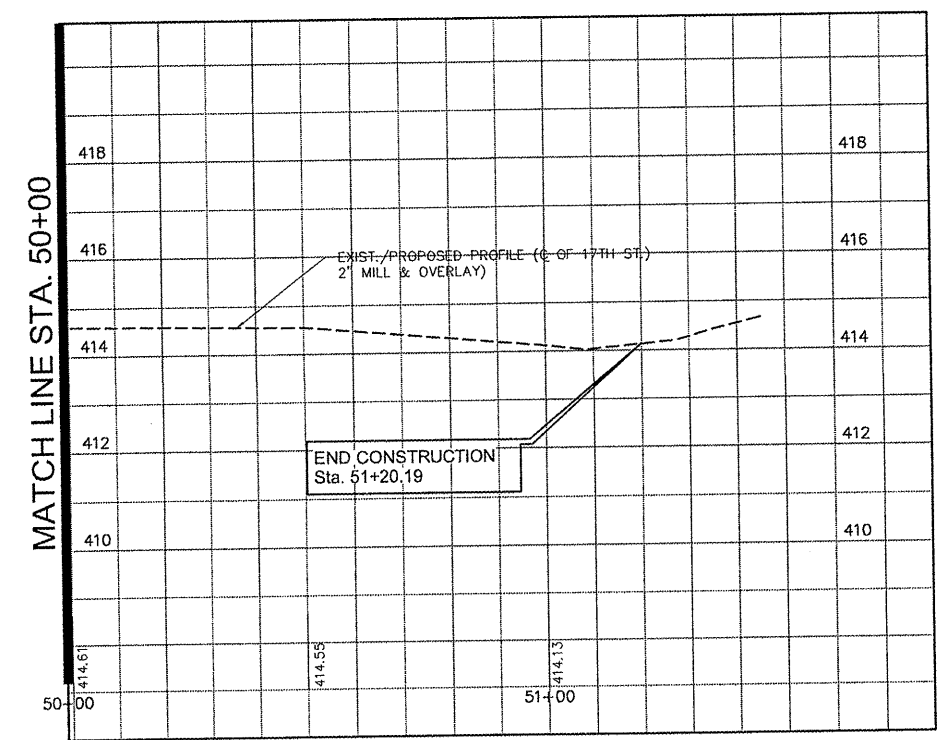

**PROFILE**  
HORIZ. SCALE: 1" = 20'  
VERT. SCALE: 1" = 2'

PLAN	SURVEYED	BY	DATE
	PLOTTED		
	NOTED		
	RT. OF WAY CHECKED		
	NO. _____		
	CADD FILE NAME		

PROFILE	SURVEYED	BY	DATE
	B.M. NOTED		
	GRADES CHECKED		
	STRUCTURE NOTATIONS OK'ED		
	NO. _____		

FILE NAME =	USER NAME = \$USER\$	DESIGNED = GAC	REVISED --
\$FILEL\$		DRAWN = SDD	REVISED --
		CHECKED = MRA	REVISED --
		DATE = 12/2009	REVISED --

**CITY OF EAST SAINT LOUIS  
17TH STREET RESURFACING**

**PLAN AND PROFILE**

SCALE: 1"=20' SHEET NO. 12 OF 14 SHEETS STA. 50+00 TO STA. 51+20.04

F.A.P. RTE.	SECTION	COUNTY	TOTAL SHEETS	SHEET NO.
9223	09-00219-00-RS	ST. CLAIR	14	13
FED. ROAD DIST. NO. _____		ILLINOIS FED. AID PROJECT		