

ROUTE	SECTION	COUNTY	TOTAL SHEETS	SHEET NO.
	05-00002-00-BT	SALINE	47	7
SVCD - EQUALITY TO GLEN O. JONES BIKE PATH				
PROJ. NO. TE-D009(84) CONTRACT NO. 99292				

GENERAL NOTES

- All materials and construction shall conform to the latest edition of the Illinois Department of Transportation Standard Specifications for Roads and Bridge Construction, Jan. 1, 2007
- Design Specifications: AASHTO Standard Specifications for Highway Bridges 1996
 - 2. - Abutment
 - A - Bridge Dead Load = 60 psf
 - B - Bridge Live Load = 85 psf
- Top elevation of abutment shown on drawing are the estimated elevation. Exact elevation shall be coordinated with bridge manufacturer.
- Locations of anchor bolts shown on drawing are the estimated locations. Exact locations of anchor bolts shall be coordinated with bridge manufacturer.
- All channel excavation is considered incidental to the contract price.

WATERWAY INFORMATION

Drainage Area = 3.87 Sq. Mi. Low Grade Elev. = 357.50

Flood	Freq. (year)	Q (cfs)	Opening (sq ft)		Natural HWE	Head (ft)		Headwater Elev	
			Exist	Prop		Exist	Prop	Exist	Prop
Design	15	1800	N.A.	235	356.67	N.A.	0	N.A.	382.4
Base	100	2887	N.A.	299	358.41	N.A.	0	N.A.	358.52

BILL OF MATERIAL - 2 ABUTMENTS

Item	Unit	Super	Sub.		Total
			Piers	Abuts.	
Concrete Structures	Cu Yd			9.4	9.4
Reinforcement Bars	Pound			1200	1200
Furnishing Piles HP 10 X 42	Foot			200	200
Driving Steel Piles	Foot			200	200
Pedestrian Truss Superstructure	Each	1			1
Name Plates	Each			1	1
Riprap	Ton			90	90

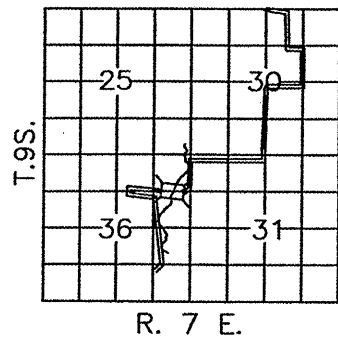
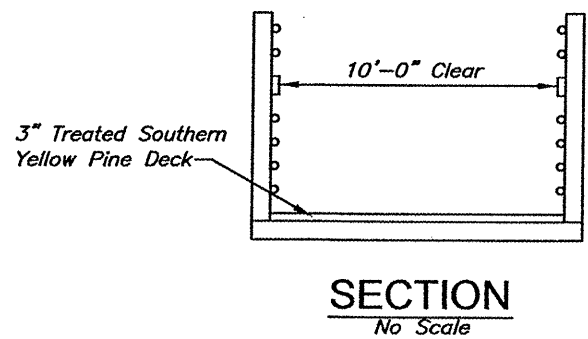
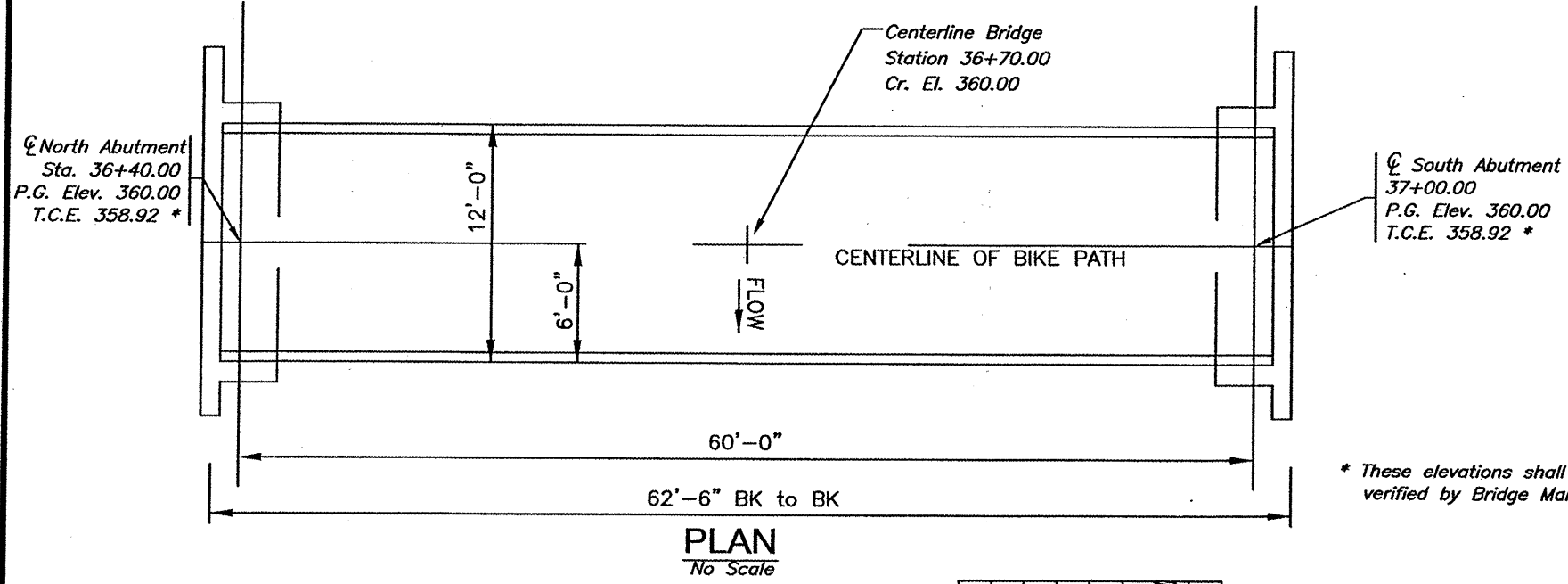
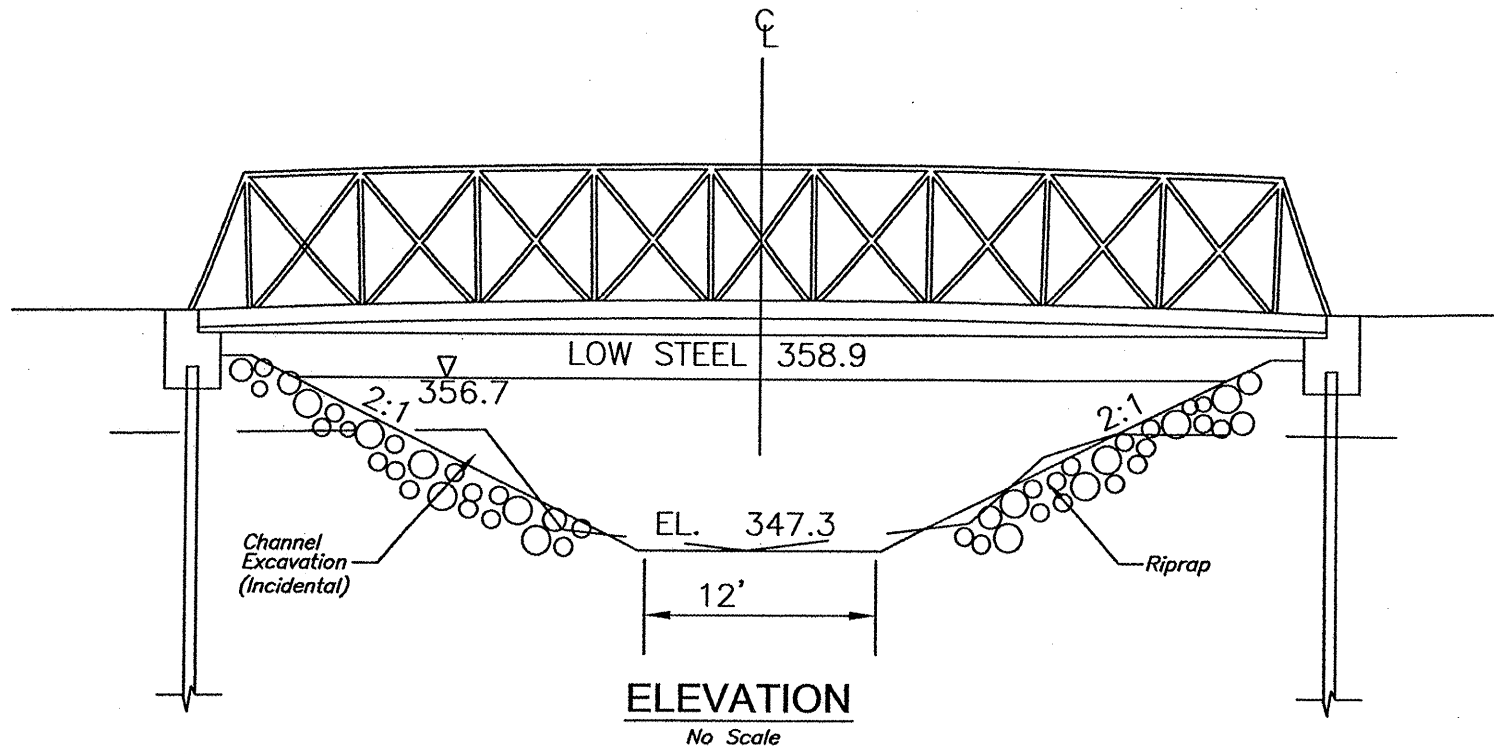

STATION 36+70
HORSESHOE CREEK
STRUCTURE NO. 030-3125
SEC.05-00002-00-BT
SALINE VALLEY CONSERVANCY DISTRICT
BUILT 2010

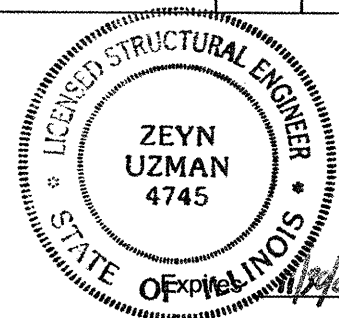

Illinois Structural No. 4745

LETTERING FOR NAME PLATE

Locate Name Plate at SOUTHWEST Corner of Bridge

GENERAL PLAN AND ELEVATION

PEDESTRIAN BRIDGE OVER HORSESHOE CREEK

SECTION 05-00002-00-BT
SALINE VALLEY CONSERVANCY DISTRICT
STATION 36+70

24 May 2007 - 8:14am X:\2004\104096\PLAN\ANSV-9 gp-1.dwg: Layout Tab Plan & Elevation