

V:\Shored\clients\40039-MI\_Vernon\40039-300 Dowdson Avenue North\Drafting\Sheet FILES\TURNING LANE DETAIL.dwg, TURNING LANE DETAIL, 12/16/2009 4:27:13 PM

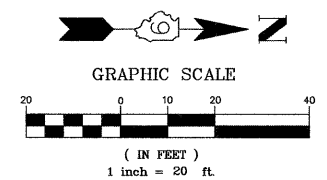
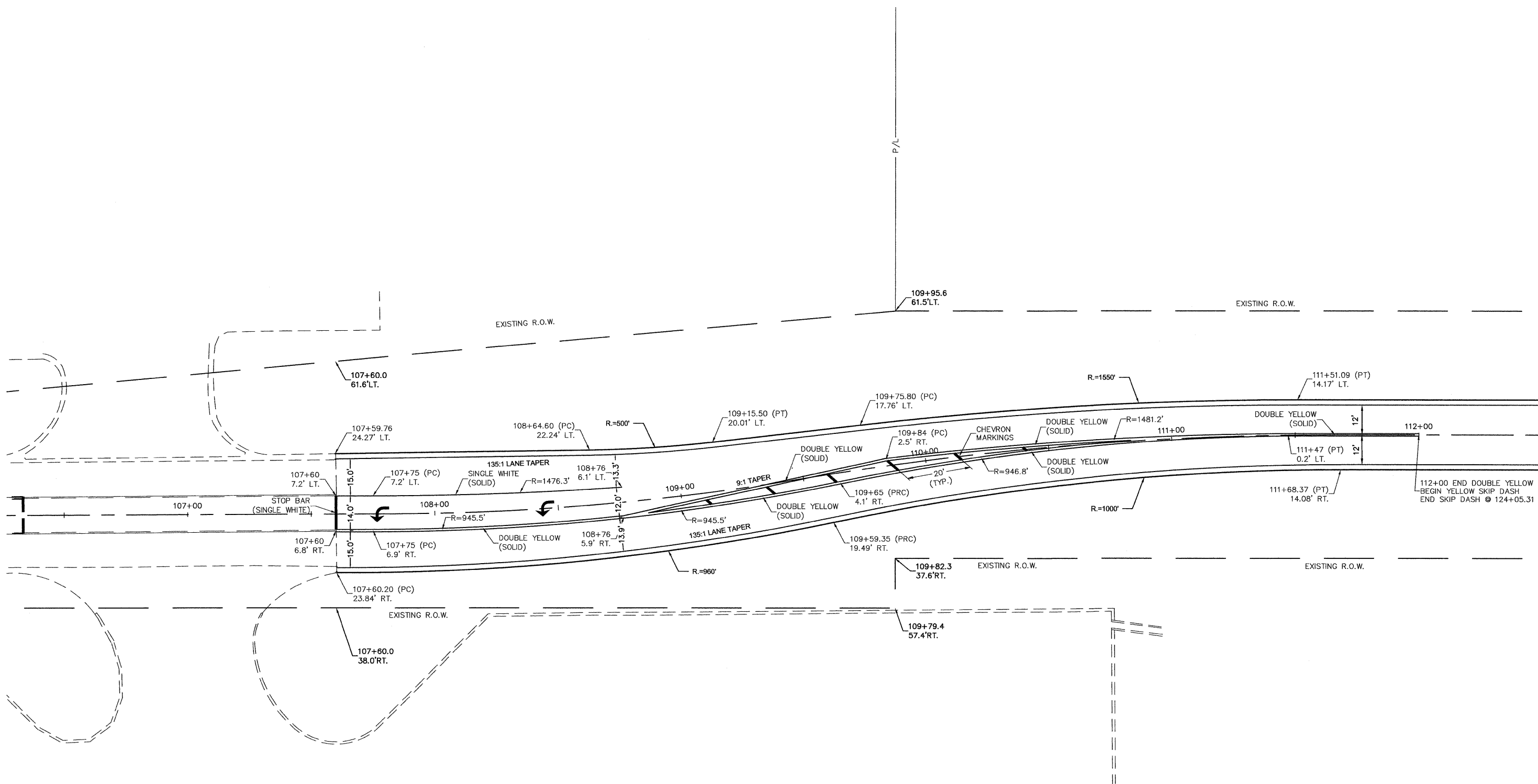

FILE NAME = 40039-300	USER NAME = Meyer, Tim	DESIGNED - MSF	REVISED -	STATE OF ILLINOIS DEPARTMENT OF TRANSPORTATION	TURNING LANE DETAIL			F.A.U. RTE. 8749	SECTION 09-00130-00-RP	COUNTY JEFFERSON	TOTAL SHEETS 30	SHEET NO. 16
	PLOT SCALE = 1:1	CHECKED - DLK	REVISED -					CONTRACT NO. 99411				
PLOT DATE = 12/16/2009	DATE - 12/09/09	REVISED -	SCALE: 1:20		SHEET NO. 16 OF 30 SHEETS	STA. NA	TO STA. NA	FED. ROAD DIST. NO. 9   ILLINOIS IARRA 2009				